

OPERATING INSTRUCTIONS

OCEAN MASTER MAX DUAL CANTILEVER AND PLANTATION MAX DUAL CANTILEVER

- ① Remove all packaging from inside and outside of the parasol.
- ② Pull pin to unlock cam lock handle. Make sure cam lock handle is open as shown in the diagram.
- ③ Insert cover onto mast.
Place mast in the security stem.
- ④ Push cam lock handle (per drawing shown) until engaged in the proper gear slot with the cam lock handle in the downward position.

** To rotate parasol: Pull two pins to unlock two cam lock handles, pull up and turn parasol to desired location. Lock two cam lock handles down.*

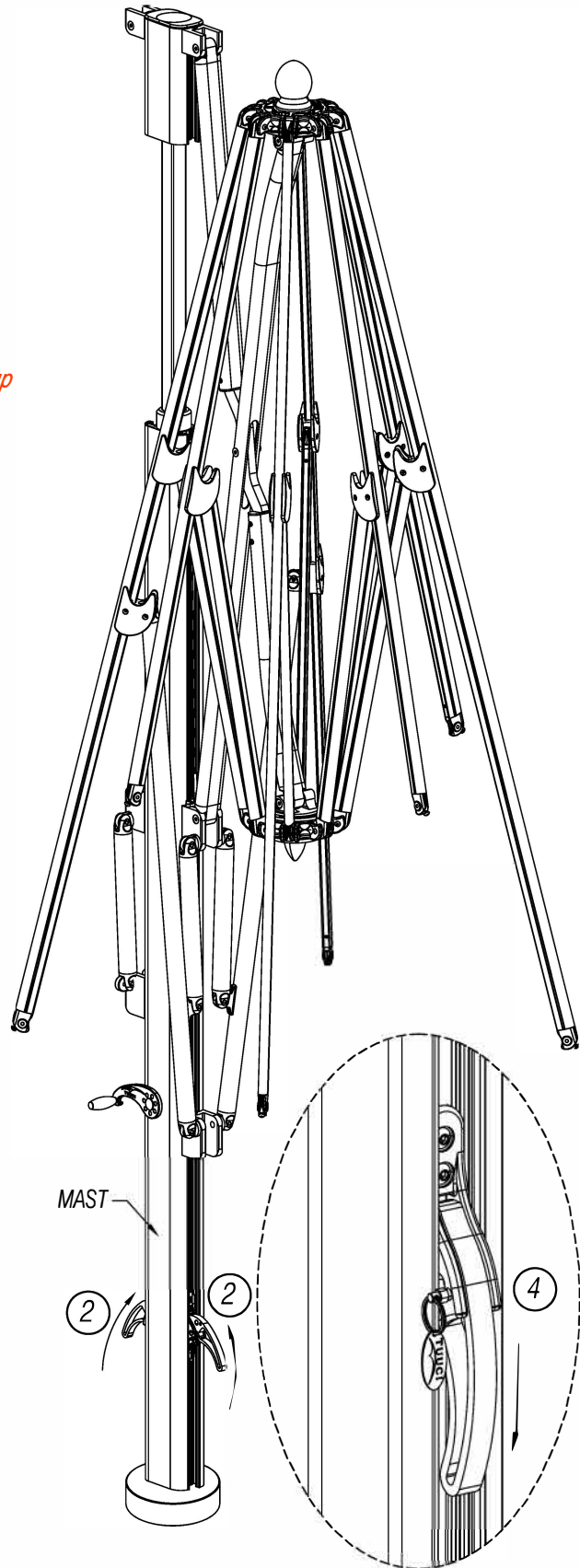
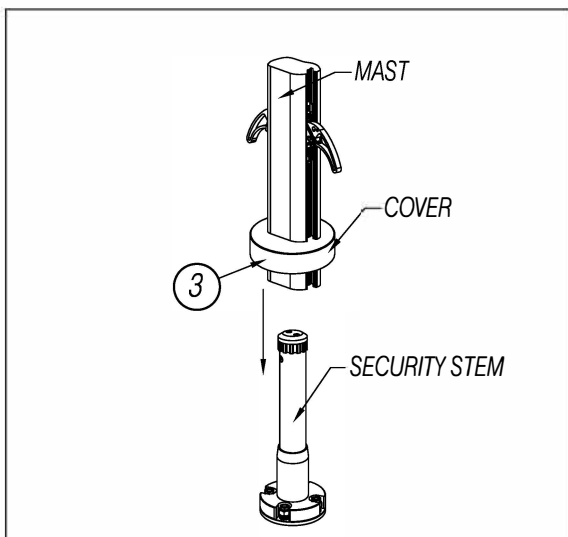
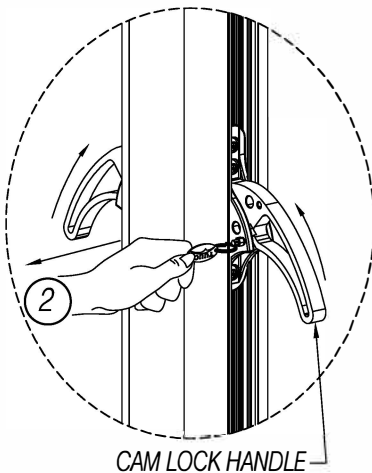

OPERATING INSTRUCTIONS

OCEAN MASTER MAX DUAL CANTILEVER AND PLANTATION MAX DUAL CANTILEVER

- ⑤ Remove #10-32 Screws and #10-32 Bushing Screws with two Phillips screwdrivers at Lower Car as shown in the diagram.
- ⑥ Using two Hex keys (5.5mm) unscrew two 3/8" Screws and 3/8" Bushing Screw at the Top Pole Connector and Upper Car.

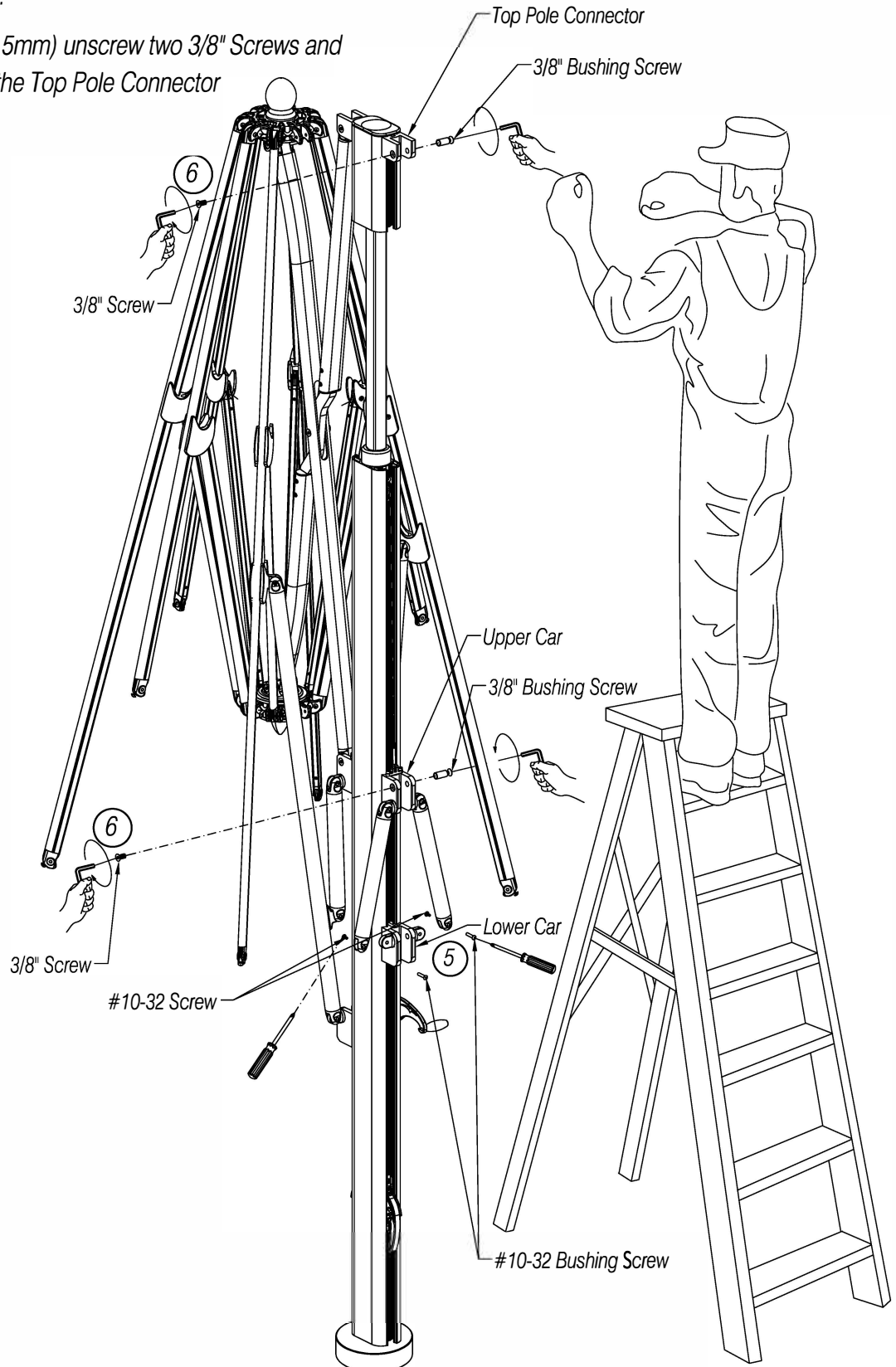

OPERATING INSTRUCTIONS

OCEAN MASTER MAX DUAL CANTILEVER
AND PLANTATION MAX DUAL CANTILEVER

- ⑦ Install Canopy frame by using two Hex keys (5.5mm) and screw two 3/8" Screws and 3/8" Bushing Screws at the Top Pole Connector and Upper Car.

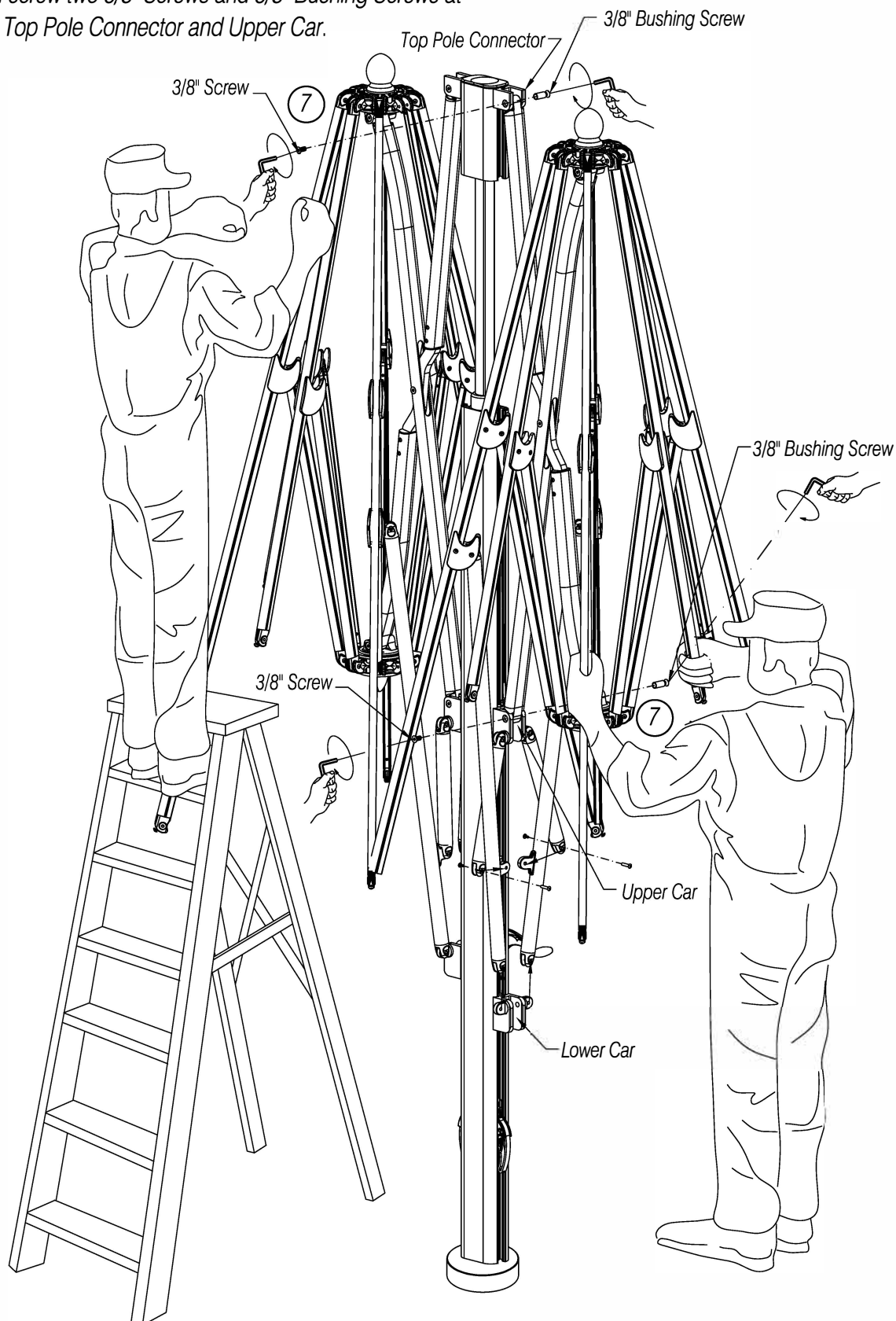

OPERATING INSTRUCTIONS

OCEAN MASTER MAX DUAL CANTILEVER AND PLANTATION MAX DUAL CANTILEVER

- ⑧ If included, install HIGH WIND STRUTS as shown in the diagram.
Then securely tighten #10-32 Screws and #10-32 Bushing
Screws with two Phillips screwdrivers.

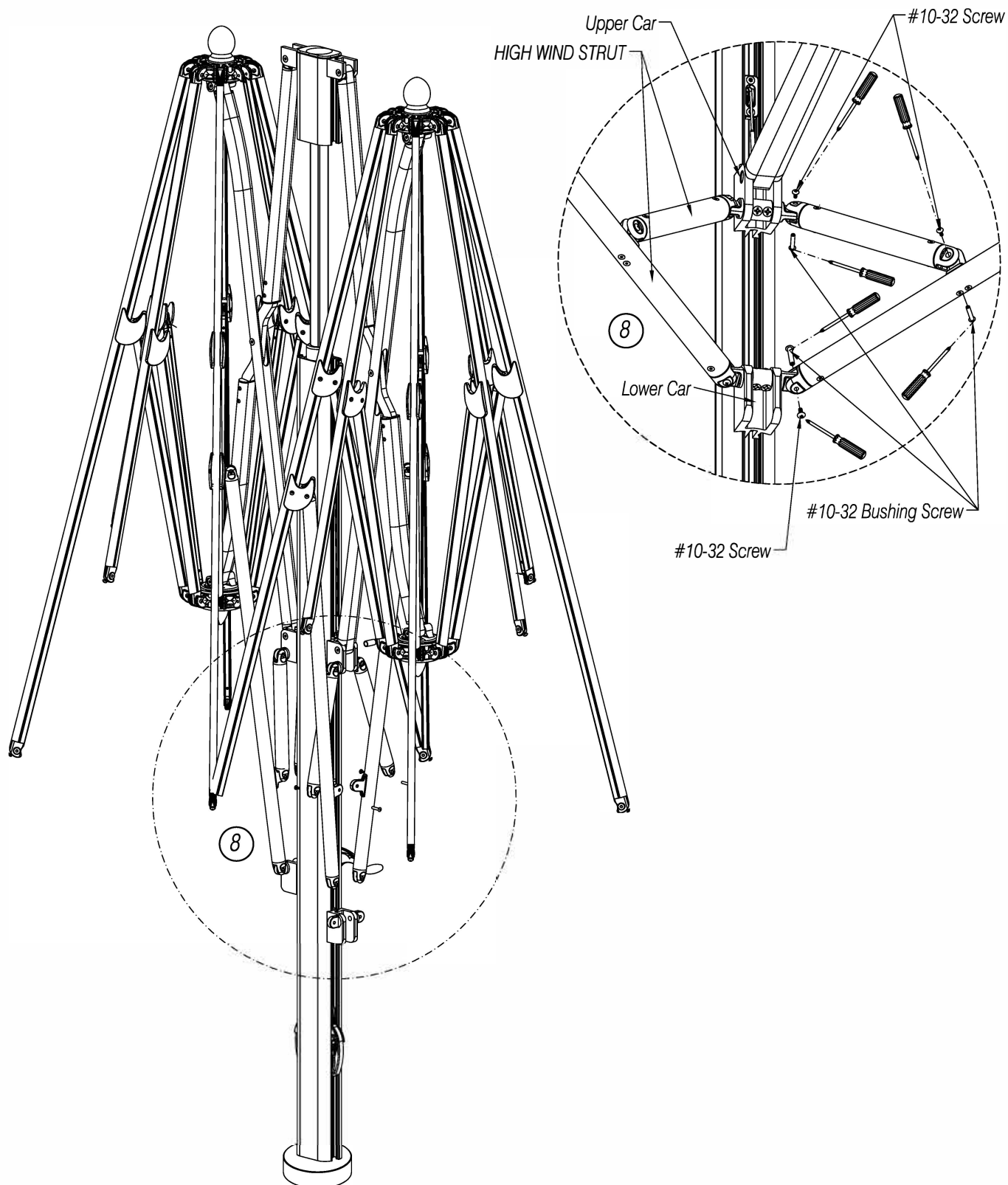

OPERATING INSTRUCTIONS

OCEAN MASTER MAX DUAL CANTILEVER
AND PLANTATION MAX DUAL CANTILEVER

- ⑨ Insert crank handle and open telescope by turning crank handle counterclockwise until it stops. The canopy and parasol will remain closed. Keep tension on the cable as you crank in a counterclockwise position.

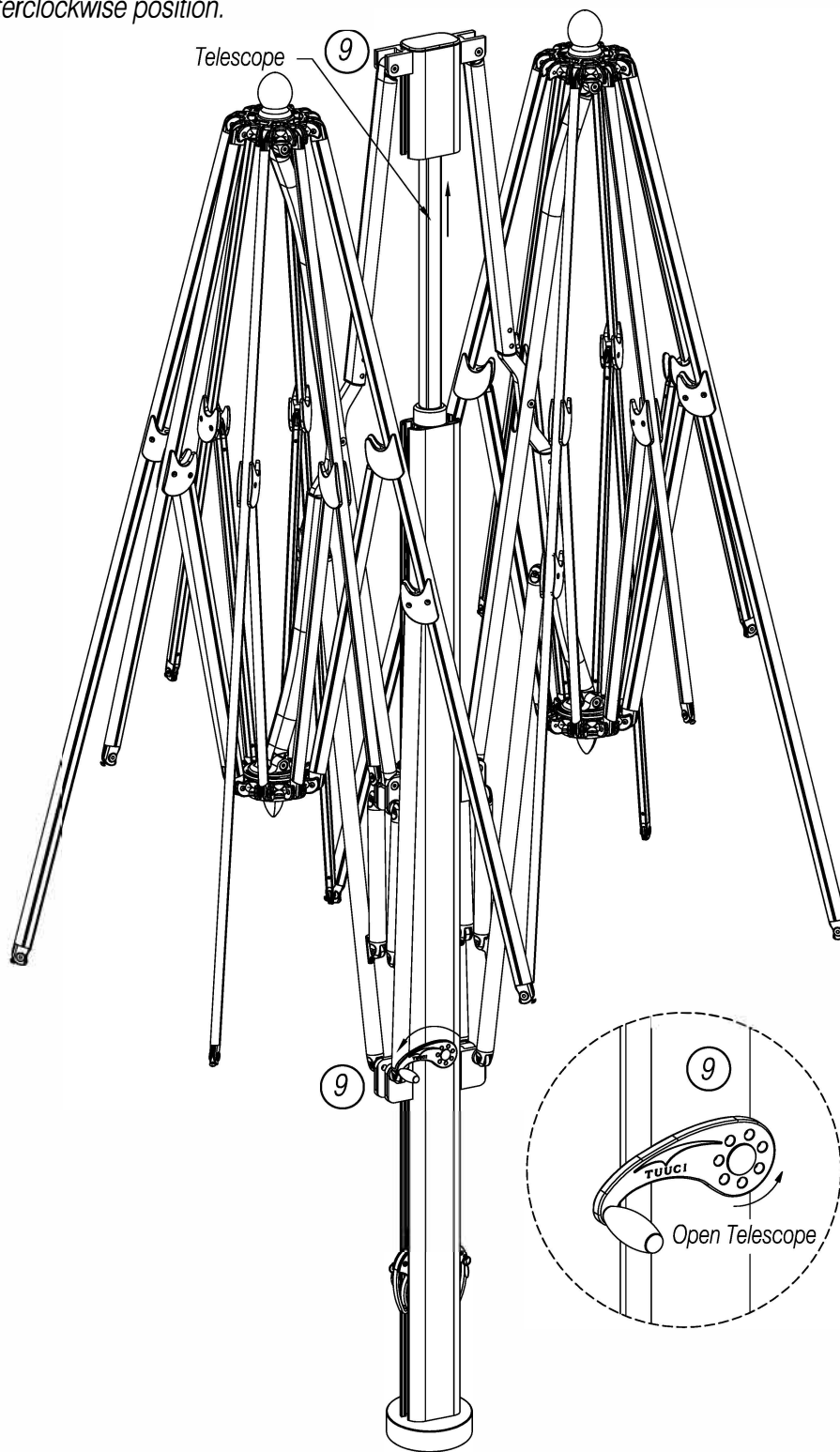

OPERATING INSTRUCTIONS

OCEAN MASTER MAX DUAL CANTILEVER AND PLANTATION MAX DUAL CANTILEVER

Engage the telescoping feature:

- ⑩ Take out the securing pin from each side. Pull cable connector to two trolley car brackets, then insert two securing pins.
- ⑪ Gently separate EACH RIB INDIVIDUALLY from center hub, approx. 4-6"/10-15cm.
If rib does not move easily, DO NOT force.
Inspect product for additional packaging.
- ⑫ Use crank handle to open parasol. Continue turning crank handle clockwise until top pole is touching lower pole. The parasol is fully deployed when the telescoping feature is hidden within the mast.
- ⑬ Turn crank handle counterclockwise to close umbrella when not in use.
- ⑭ Close umbrella during wind conditions that exceed manufacturer's specifications

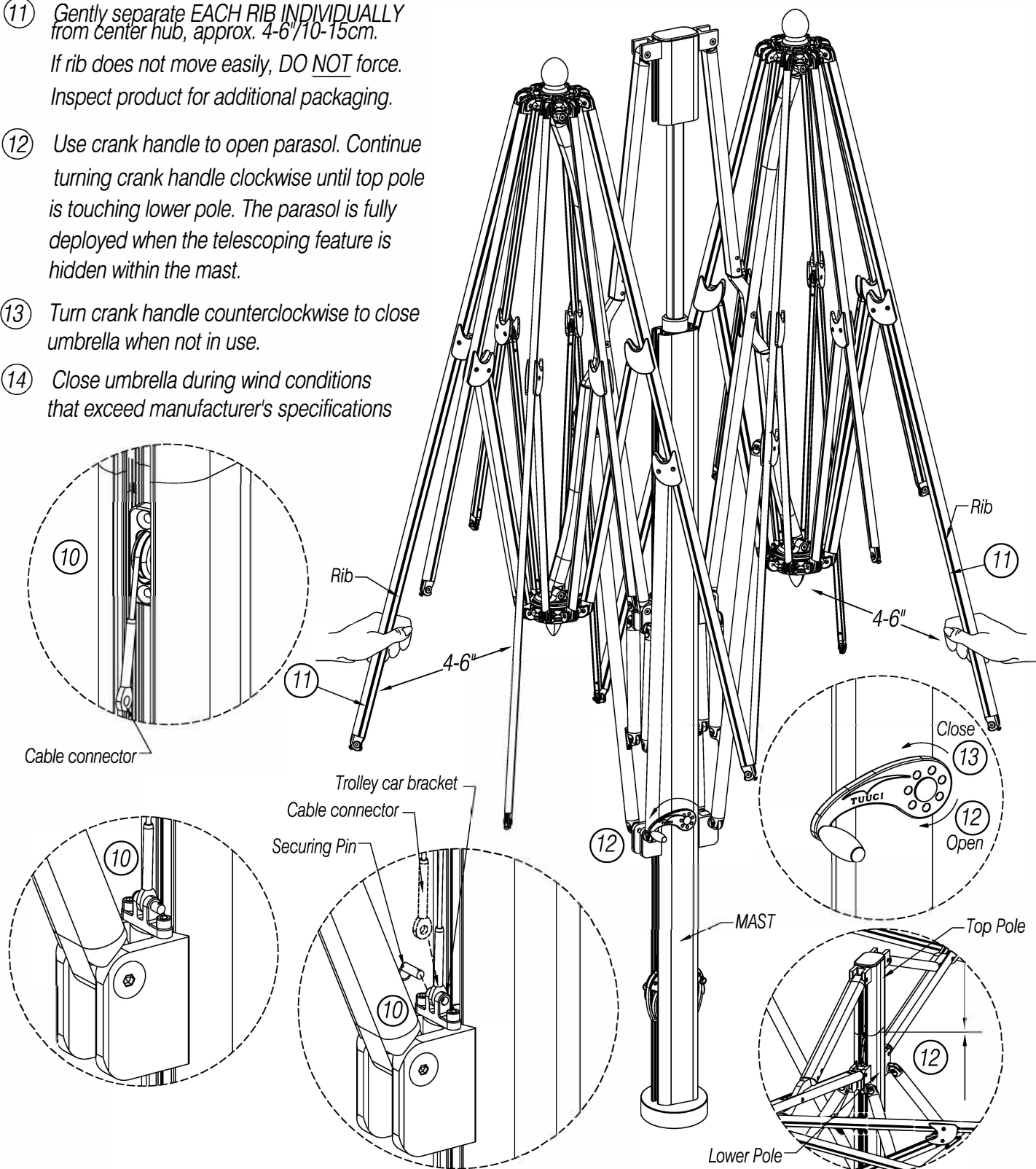

care & maintenance

[terms & conditions]



Frames

TUUCI frames are constructed from durable and weather resistant materials, including anodized aluminum, Durateak, fiberglass and marine quality hardwood. All fasteners (nuts, bolts, pulleys, cam cleats, etc.) are stainless steel and will withstand the most difficult environments. However, proper care and maintenance is important to extend the useful life of the product. TUUCI products used on ocean front properties, or other salty environments, should be regularly washed with fresh water to limit oxidation.

Prior to opening, ensure that the shade product is properly secured to its shade anchor, using the locking system intended for the specific product (star knob, hitch pin or cam lock). **WHEN OPENING A TUUCI PARASOL, GENTLY SEPARATE EACH RIB 4" TO 6" FROM THE CENTER POST, BEFORE RAISING THE HUB.** Do not force hub if it does not rise easily. When closing the parasol, pull the fabric out from between the struts to avoid pinching and tearing the fabric.

TUUCI frames have been tested for structural integrity in winds exceeding 50 miles per hour, and are very durable. However, these tests were performed with special, extremely secure shade anchors; caution and common sense must be applied in extreme winds and weather. TUUCI generally recommends that its shade products be closed in any weather that is uncomfortable for the people using the products, and is directly related to the size, weight and security of the shade anchor. Please use reasonable and cautious judgment when determining when the parasol should be closed.

Canopies

TUUCI's parasol canopies are normally made with Sunbrella® fabric, and should be cared for as described below (for fabric other than Sunbrella®, refer to manufacturer). Sunbrella® fabric should be cleaned regularly before dirt is allowed to accumulate and become embedded in the fabric. The fabric canopy can be cleaned without being removed from the frame. Simply brush off any loose dirt or particles; hose down and clean with a mild soap in lukewarm water (no more than 100F.) Rinse thoroughly to remove soap. Allow fabric to air dry. **DO NOT USE DETERGENTS!**

For stubborn stains clean with TUUCI Fabric Cleaner TM. Scrub vigorously with a soft bristle brush, sponge, or clean towel. Allow fabric to air dry. This method of cleaning may remove part of the water repellency. If water repellency is a factor, the fabric should receive an application of an air-curing water repellent treatment (such as TUUCI Fabric Shield TM).

Sunbrella® may be machine washed but a water repellent treatment must be applied to the fabric after washing to reestablish water repellency. Sunbrella® is made from 100% acrylic fiber and is thermoplastic or heat sensitive. When washing or cleaning, **DO NOT SUBJECT TO EXCESSIVE HEAT** as the fabric will shrink. **DO NOT STEAM PRESS OR DRY IN ELECTRIC OR GAS DRYERS**, but allow air to dry.

In cases where the parasol is taken down and stored during the winter season, the Sunbrella® canopy should be cleaned, allowed to air dry, and stored in a dry, well ventilated area. A TUUCI Protective Cover should be used when umbrella is not in use.

Shade Anchors

ALWAYS BE SURE THAT PARASOL CENTER POLE IS FIRMLY ATTACHED TO BASE BEFORE OPENING PARASOL. Clean above ground parasol bases regularly to maintain appearance. To clean, gently wash with soap and water using a non-abrasive cloth or pad. Check three bolts in base plate regularly to ensure that they remain fully tightened. Inspect weekly if parasol bases are moved on a regular basis.

Do not roll ACF (Aluminum Shell, Concrete Filled) bases on their side as damage to shell or finish can occur. Touch up bases with exterior paint as needed. Touch up can be ordered from the TUUCI parts department. Wheeled parasol bases are intended for use on even surfaces. Move bases slowly and with caution on uneven surfaces. Do not use on stairways or over distances, which exceed 50 feet, as damage to welded wheel tray will occur.