

LEVEQUE SOLID BRASS WINDOW HARDWARE INSTALLATION INSTRUCTIONS

TOOLS REQUIRED FOR INSTALLATION (NOT PROVIDED)

Installation on Wood Molding or Wood Studs

- Screwdriver, level, tape measure, pencil, power drill and 1/4" (6.5mm) drill bit.

Installation on Wallboard

- Screwdriver, level, tape measure, pencil, power drill and self-drilling anchors.

Installation in Concrete, Stone, Brick or Tile

- Screwdriver, level, tape measure, pencil, masonry drill, appropriate anchors, plugs or screws.

Installation in Drywall

- Installation instructions included with the anchor in separate hardware pack.

GETTING STARTED

- Remove hardware from the package. Do not dispose of package until the installation is complete.
- Read through the instructions entirely before starting.
- Ensure all parts indicated on packaging are included, plus 4 screws per bracket and an off-set screwdriver.
- Ensure all tools and all necessary supplementary hardware are on hand before starting.

ASSEMBLY INSTRUCTIONS

1. Determine the appropriate location for the rod. It is recommended that the outside brackets be installed a minimum of 2.5" (7cm) above the window. If the length of the rods exceeds 48", one center bracket is necessary. If the length of the rods exceeds 120", two center brackets are necessary. All the brackets need to be installed at the same level. (See Fig 3.)
The height of the rod should be calculated by:
 - A. Measuring the length of the drapery panel.
 - B. Considering use of rings or rod pocket.
 - C. Deciding if you want excess drapery on the floor, hem of drapery touching the floor or hem hanging slightly above the floor.
2. For easier installation, we recommend attaching the end brackets with the rod together before mounting them on the wall. (See Fig. 4)
3. Mark the appropriate location of each bracket with a pencil. Pre-drill the screw holes using a 1/4" (6.5mm) drill bit. Mount the end bracket on the wall at the desired height. After securely installing the first bracket, place the rod into the end bracket, and then place the rod into the location of the second bracket. Using a level, determine the proper height of second bracket to ensure that rod will be level. Mark the height, and install the second bracket. (See Fig. 2 & 3.)
4. For the metal mounting screw behind the curved section of the end brackets, it may be difficult to use a Phillips screwdriver to tighten the metal screw. We recommend using the enclosed offset screwdriver instead. (See Fig 2)
5. If hanging rod-pocket drapery, feed the drapery onto the rod through the drapery's pocket, and then place the rod into the brackets. If using rings, place the rings onto the rod before hanging the drapery.

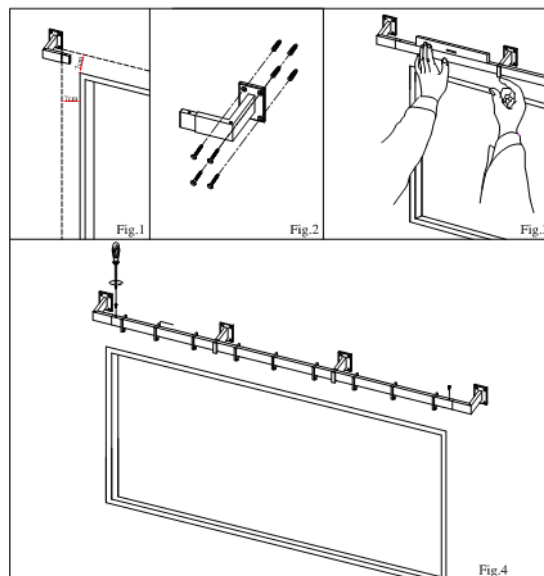

IMPORTANT:

It is recommended that the bracket be attached to a structural wood support, such as moulding around the window, or wooden studs within the walls. The enclosed screws are designed for that purpose. If the studs within the wall are metal, you must Pre-drill into the metal stud and use sheet metal screws.

RH

LEVEQUE SOLID BRASS ROD CONNECTOR ASSEMBLY INSTRUCTIONS

ASSEMBLY INSTRUCTIONS

The enclosed connector should be used if you need to connect two or more rods. Please follow the steps below to assemble the rods.

1. Insert the connector into the rod, and then tighten the set-screw with a Phillips-head screwdriver.
2. Insert the connector into the second rod, and then tighten the set-screw with a Phillips-head screwdriver.

