

UTILITAIRE OUTDOOR BARN PENDANT 11"

PARTS ENCLOSED

- (A) Mounting Strap (1)
- (B) Set Screw (1)
- (C) Canopy (1)
- (D) Canopy Ring (1)
- (E) Mounting Screws (2)
- (F) Socket (1)
- (G) Shade Cover (1)
- (H) Shade (1)
- (I) Bulb (1)

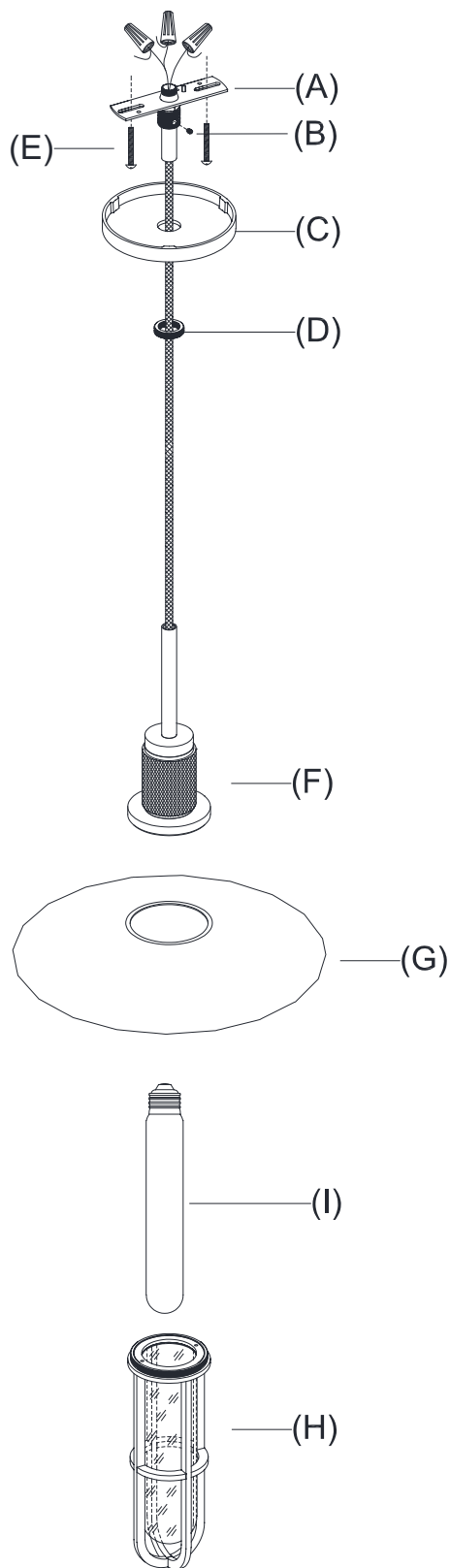

UTILITAIRE OUTDOOR BARN PENDANT 11"

IMPORTANT SAFETY INSTRUCTIONS

INSTALLATION BY A LICENSED ELECTRICIAN IS STRONGLY RECOMMENDED.

This fixture has been rated for one (1) 60-watt maximum Type T lightbulb (included) or one (1) 13-watt compact fluorescent lightbulb (not included). To avoid the risk of fire, do not exceed the recommended wattage.

WARNINGS

All wires are connected. When unpacking, be careful not to pull wires, as a bad connection may result. Do not connect electricity until your fixture is fully assembled. To reduce the risk of fire, electrical shock, or personal injury, always turn off fixture and allow it to cool prior to replacing the light bulb. Do not touch or look directly at the bulb when fixture is illuminated. Keep flammable materials away from lit bulb.

THIS PRODUCT IS NOT A TOY AND HAS NO PLAY VALUE.



WARNING: STRANGULATION HAZARD

Keep cord at least 3 feet away from cribs, bassinets, and toddler beds. Keep out of reach of children under 3 years of age.

ASSEMBLY & INSTALLATION

SHUT OFF THE MAIN ELECTRICAL SUPPLY FROM THE FUSE BOX OR CIRCUIT BREAKER PANEL.

1. Carefully remove all parts from the box and remove all plastic coverings.
2. Cut the length of fabric cord according to the hanging height if needed. (Refer to next page for height adjustment instructions).
3. Remove Mounting Strap (A) from Canopy (C) by unscrewing Canopy Ring (D) in a counter-clockwise direction.
4. Attach Mounting strap (A) to the ceiling outlet box by aligning the holes and secure with Mounting Screws (E).
5. Gently pull the wire from the ceiling outlet box and allow the wire to hang. Thread the wire through the center hole in Mounting Strap (A).

ASSEMBLY & INSTALLATION CONT.

6. Attach the fixture ground wire (green) and house ground wire (usually green or bare) to the ceiling outlet box with the green grounding screw. Connect fixtures to corresponding house wire with a wire nut. Carefully tuck the wires back into the outlet box. IT IS IMPERATIVE THAT THE OUTLET BOX IN YOUR HOME BE PROPERLY GROUNDED.
7. Connect the neutral wire (white) to the neutral outlet wire (usually white) with a plastic wire connector and wrap the connection with electrical tape.
8. Connect the hot wire (black) to the hot outlet box wire (usually black) with a plastic wire connector and wrap the connection with electrical tape. DO NOT REVERSE THE HOT AND NEUTRAL CONNECTIONS OTHERWISE SAFETY WILL BE COMPROMISED.
9. Attach Canopy (C) to the affixed Mounting Strap (A) and secure with Canopy Ring (D).
10. Insert Bulb (I) into Socket (F).
11. Attach Shade Cover (G) and Shade (H) to Socket (F) and secure by turning Shade (H) in a clockwise direction until tight.
12. Restore power to the ceiling outlet box and check operation of fixture.
13. Assembly is complete.

CARE INSTRUCTIONS

Do not use polishes or cleaners on the fixture. Wipe clean with a soft, dry cloth.

UTILITAIRE OUTDOOR BARN PENDANT 11"

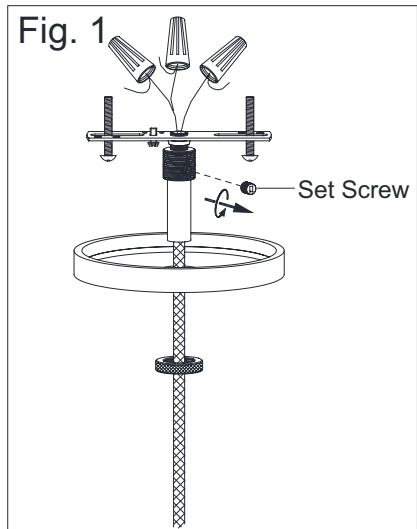

1. REMOVE SET SCREW FROM MOUNTING LOOP.

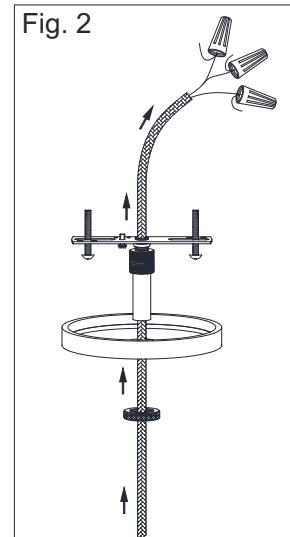

2. PULL THE WIRES OUT.

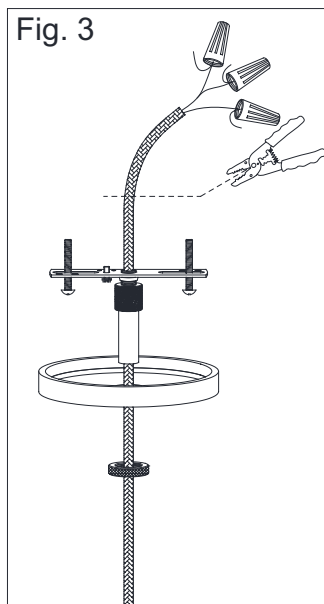

3. CUT THE WIRES TO DESIRED HEIGHT.

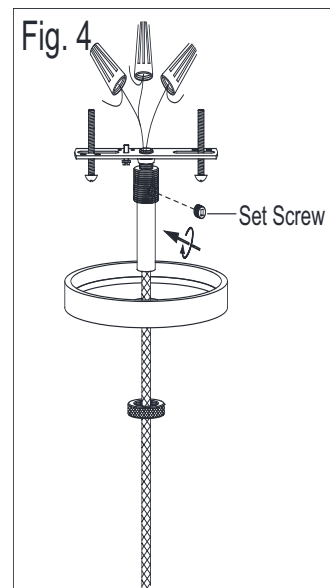

4. TIGHTEN THE SET SCREW.