

RH

PIVOT MIRROR

ASSEMBLY AND INSTALLATION INSTRUCTIONS

ENGLISH

PIVOT MIRROR**PARTS INCLUDED**

- (A) Mounting Post (2)
- (B) Mirror Frame (1)
- (C) Wall Bracket (2)
- (D) Anchor (4)
- (E) Screw (4)
- (F) L Hex Wrench (1)
- (G) T Hex Wrench (1)

TOOLS NEEDED

- Carpenter's Level
- Phillips Screwdriver
- Claw Hammer
- Drill
- Pencil
- Assorted Hex Wrenche

BEFORE YOU BEGIN

Two people are recommended for installation.

Our mirrors are crafted out of forged solid brass. Forging is a process whereby a tool forms and actually compresses the metal. Each piece is heated, formed, and polished by hand. Plate finish is applied on pure forged brass forming a natural bond, which ensures protection against tarnishing, corrosion, and finish failure. These efforts are reflected in the quality of each piece.

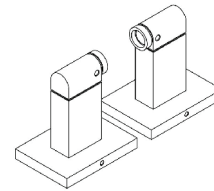
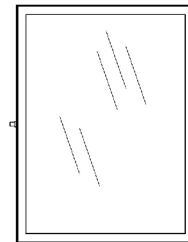
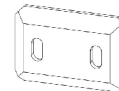
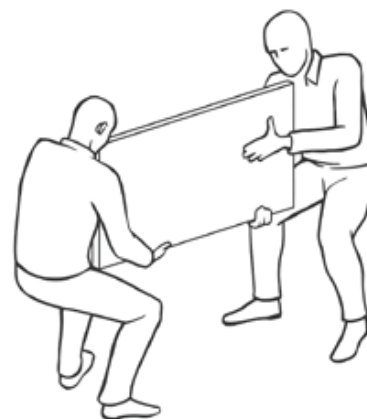
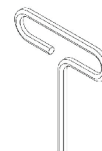
A**B****C****D****E****F****G**

WARNING

BLOCKING IS NECESSARY FOR THE SECURE INSTALLATION OF LARGER PIVOT MIRRORS - 40" (102CM) X 30" (76CM) AND 60" (152CM) X 32" (81CM).

PROFESSIONAL INSTALLATION IS RECOMMENDED.

ASSEMBLY AND INSTALLATION

1. Connect the mirror frame (B) to both mounting posts (A) using T hex wrench (G).
2. Position mirror in desired location on wall, use a carpenter's level to ensure that posts are level.
3. After positioning on the wall, lightly mark the outline of both posts with a pencil.
4. Hold wall brackets (C) in the center of the outlines of the posts as shown below (Figure 2).
5. Mark the locations of anchors (D) on the wall. Remove wall brackets (C) from wall. Position anchors (D) and gently hammer each anchor into the wall until the cap prongs are embedded and the cap is snug against the wall surface. Turn the screw clockwise, pressing firmly to prevent anchor (D) from rotating. Turn the screw counterclockwise to remove it, anchor (D) will remain embedded in the wall.
6. Place wall brackets (C) over anchors (D) and re-insert anchor screws through wall brackets (C) and tighten until they are flush with the wall. Place mounting posts (A) over wall brackets (C) and tighten screws (E).
7. If necessary, loosen wall mounting screws (E) and adjust wall brackets (C) to obtain proper horizontal screws and then reattach mounting posts (A) using L hex wrench (F).
8. Use T hex wrench (G) to tighten both the mirror and the knuckles of mounting posts (A).

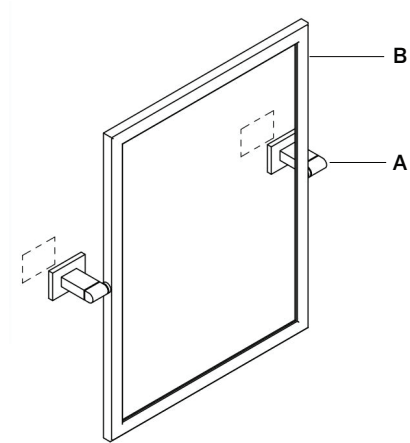

FIGURE 1

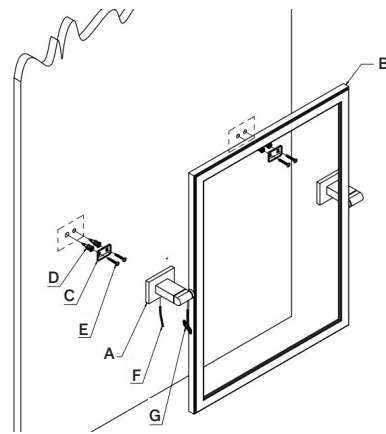

FIGURE 2

BACK VIEW OF POSTS

Fig 1

WARRANTY

If you are not completely satisfied with your purchase, please contact us to return or exchange your item(s) within 30 days of the delivery date, with proof of purchase. Note that returns or exchanges are not accepted for special orders, items that have been installed, and mattresses and/or foundations no longer in their original packaging. Other exclusions may apply. Contact us for details. Unfortunately, galleries cannot accept returns of furniture or other large items.

CARE INSTRUCTIONS

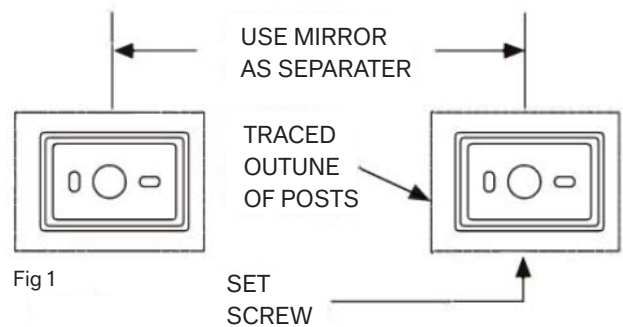
To maintain and protect the luster on the finish, clean with a soft, damp cloth.