



HARLOW CRYSTAL TRIPLE SCONCE

ASSEMBLY & INSTALLATION INSTRUCTIONS

**UNITED STATES ENGLISH**

**HARLOW CRYSTAL TRIPLE SCONCE****PARTS INCLUDED:**

- (A) Junction Box, 25lbs/11.3kg MIN.  
FIXTURE RATED (not included)
- (B) Mounting Screws and Plastic Plugs  
(6 sets; for concrete wall or dry wall)
- (B1) Wall Plate (1)
- (B2) Bolts (2)
- (B3) Top Bracket (1)
- (B4) Middle Brackets (2)
- (B5) Bolts (4)
- (B6) Bottom Bracket (1)
- (B7) Nuts (2)
- (B8) Nut Caps (2)
- (C) Wire Nuts (3)
- (D) Bulbs (3 +1 extra)
- (E) Fixture Body (1)
- (F) Glass Blocks (3)
- (G) Safety Cable (1)

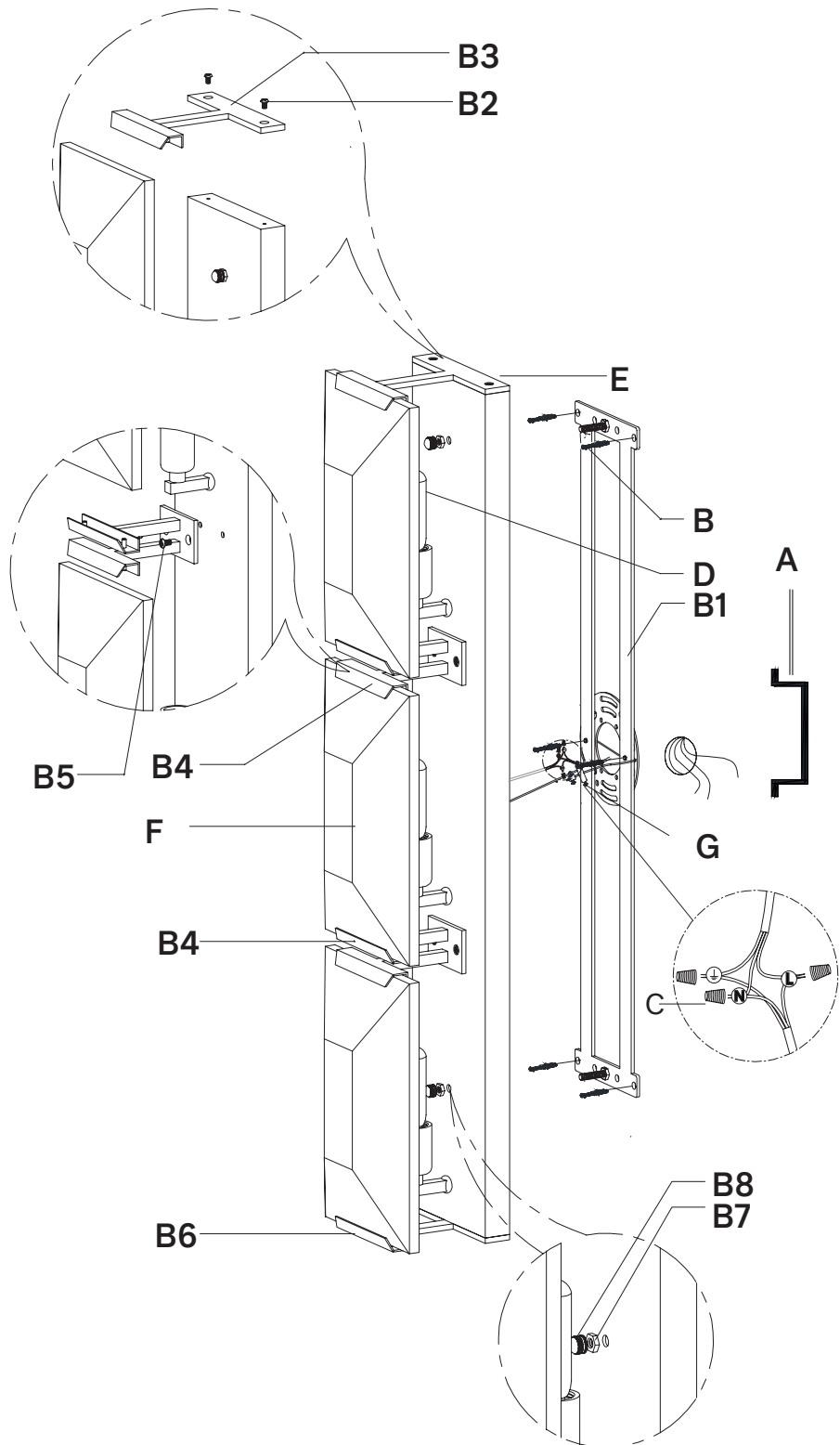

**IMPORTANT: PLEASE READ**

**PLEASE FOLLOW THE ASSEMBLY INSTRUCTIONS CLOSELY. IMPROPER ASSEMBLY OR INSTALLATION CAN RESULT IN PERSONAL OR PROPERTY DAMAGE. MOUNTING HARDWARE HAS BEEN PROVIDED FOR MOUNTING TO CONCRETE WALL OR DRY WALL. UNIQUE OR ALTERNATIVE INSTALLATION TYPES MAY REQUIRE DIFFERENT MOUNTING HARDWARE, WHICH HAS NOT BEEN INCLUDED. ALWAYS CONSULT WITH A LICENSED ELECTRICIAN BEFORE INSTALLATION.**

**INSTALLATION BY A LICENSED ELECTRICIAN IS STRONGLY RECOMMENDED.**

**IMPORTANT SAFETY FEATURES****BULBS**

This fixture has been rated for three (3) 25-watt maximum E12 TYPE T6 incandescent bulbs (three (3) 25-watt E12 TYPE T6 incandescent bulbs included) or three (3) 6-watt maximum E12 TYPE T6 LED bulbs (not included). To avoid the risk of fire, do not exceed the recommended wattage.

**DIMMER SWITCH COMPATIBILITY**

This fixture is dimmer-switch compatible and may be used with a forward- or reverse-phase dimmer switch.

**WARNINGS**

All wires are connected. When unpacking, be careful not to pull wires, as damage may result. Do not connect electricity until the fixture is fully assembled. To reduce the risk of fire, electrical shock, or personal injury, always turn off fixture and allow it to cool prior to replacing the lightbulbs. Do not touch or look directly at the bulbs when fixture is illuminated. Keep flammable materials away from lit bulbs.

**WARNING: STRANGULATION HAZARD**

Keep cord at least 3 feet (91cm) away from cribs, bassinets, and toddler beds.

Keep out of reach of children under 3 years of age.

**THIS PRODUCT IS NOT A TOY AND HAS NO PLAY VALUE.**

**ASSEMBLY AND INSTALLATION****SHUT OFF THE MAIN ELECTRICAL SUPPLY FROM THE FUSE BOX OR CIRCUIT BREAKER PANEL.**

1. Carefully remove all parts from the box and remove all plastic coverings.
2. Turn OFF power to junction box (A) where the fixture will be installed.
3. Loosen the bolts (B2 & B5) and remove the brackets (B3 & B4) from fixture body (E).
4. Loosen the nut caps (B8) and nuts (B7) from the fixture body (E), detach the wall plate (B1) from fixture body (E)
5. Attach the wall plate (B1) to the wall and secure with mounting screws and plastic plugs (B).
6. Carefully inspect the fixture wires. One is the ground wire (marked with  $\oplus$  ). The second is the neutral wire (marked with N). The third wire is the live/hot wire (marked with L).
7. The ground wire is to connect to grounding wire of power supply cable with wire nut (C).

NOTE: IT IS IMPERATIVE THAT THE OUTLET BOX IN YOUR HOME BE PROPERLY GROUNDED.

8. The neutral wire is to connect to neutral wire of power supply cable with wire nut (C).
  9. The live/hot wire is to connect to live/hot wire of power supply cable with wire nut (C).
- CAUTION: DO NOT REVERSE THE HOT AND NEUTRAL CONNECTIONS; OTHERWISE, SAFETY WILL BE COMPROMISED.
10. Attach the fixture body (E) to the wall plate (B1) with nuts (B7) and nut caps (B8).
  11. Fasten the light bulbs (D) into the lampholders.
  12. Attach the bottom layer glass block (F) on the bottom bracket (B6), adjust middle bracket (B4) to be aligned before tighten bolts (B5).
  13. Attach the middle layer glass block (F) on the top of the middle bracket (B4), adjust bracket (B4) to be aligned before tighten bolts (B5).
  14. Attach the top layer glass block (F) on the top of the middle bracket (B4), adjust top bracket (B3) to be aligned before tighten bolts (B2).
  15. Restore power to the junction box and test fixture.
  16. Assembly is complete.

**CARE INSTRUCTIONS**

Do not use polishes or cleaners on the fixture. Wipe clean with a soft, dry cloth.