

FULCRUM ROUND CHANDELIER 73"

PARTS ENCLOSED

- (A) Mounting Plate (1)
- (B) Mounting Screws (2)
- (C) 1/4" D Nuts (4)
- (D) 1/4" D Washers (4)
- (E) 1/2" D Nut (1)
- (F) 1/2" D Washer (1)
- (G) Metal Plate (1)
- (H) Canopy Screws (4)
- (I) Canopy (1)
- (J) Connector (1)
- (K) 18" Connection Rods (2)
- (L) 12" Connection Rods (2)
- (M) 6" Connection Rods (2)
- (N) 19" Connection Rods (8)
- (O) 13" Connection Rods (8)
- (P) 7" Connection Rods (8)
- (Q) Fixture Body (1)
- (R) Caps (5)
- (S) Knurled Rings (5)
- (T) Socket Covers (5)
- (U) Outer Glass Shades (5)
- (V) Collar Rings (5)
- (W) Inner Glass Shades (5)
- (X) Brackets (5)
- (Y) Socket Rings (5)
- (Z) Bulbs (5)
- (AA) 1/4" D Wrench (1)
- (BB) 1/2" D Wrench (1)

Install safety cable:

1. Wrap the safety cable into the slot hole on the mounting plate.
2. Wrap the safety cable around the saddle (a).
3. Insert U-bolt clip (b) into the saddle (a) and secure with the nuts (c).

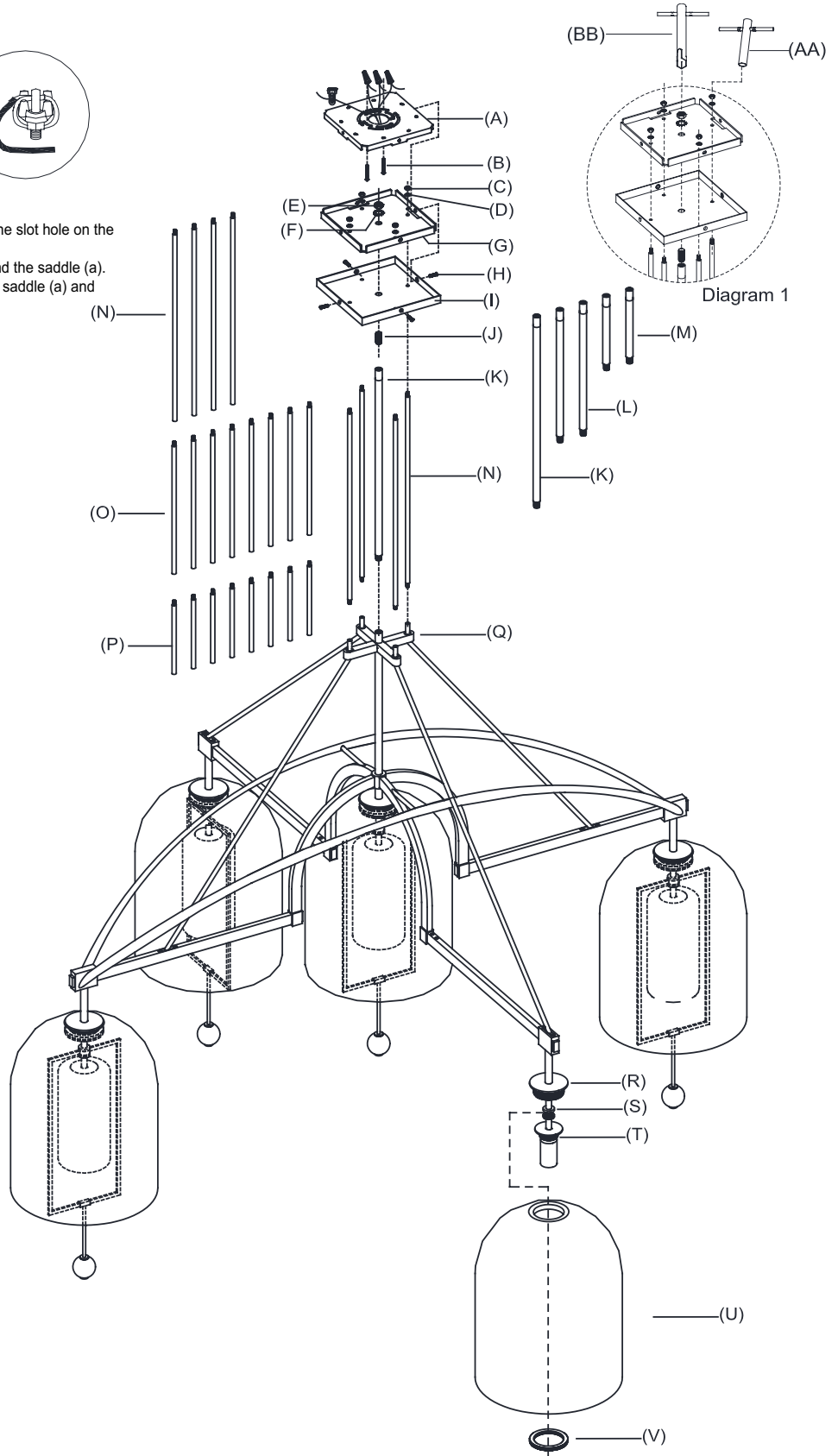
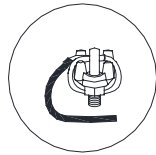

IMPORTANT SAFETY INSTRUCTIONS

INSTALLATION BY A LICENSED ELECTRICIAN IS STRONGLY RECOMMENDED.

This fixture has been rated for five (5) 60-watt maximum Type T lightbulbs (25-watt Type T lightbulbs included) or five (5) 13-watt compact fluorescent lightbulbs (not included). To avoid the risk of fire, do not exceed the recommended wattage.

WARNINGS

All wires are connected. When unpacking, be careful not to pull wires, as a bad connection may result. Do not connect electricity until your fixture is fully assembled. To reduce the risk of fire, electrical shock, or personal injury, always turn off fixture and allow it to cool prior to replacing the lightbulb. Do not touch or look directly at the bulb when fixture is illuminated. Keep flammable materials away from lit bulb.



WARNING: This product can expose you to lead, which is known to the State of California to cause cancer and birth defects or other reproductive harm. For more information, go to www.P65Warnings.ca.gov.

THIS PRODUCT IS NOT A TOY AND HAS NO PLAY VALUE.



WARNING: STRANGULATION HAZARD

Keep cord at least 3 feet away from cribs, bassinets, and toddler beds. Keep out of reach of children under 3 years of age.

ASSEMBLY & INSTALLATION

SHUT OFF THE MAIN ELECTRICAL SUPPLY FROM THE FUSE BOX OR CIRCUIT BREAKER PANEL.

1. Carefully remove all parts from the box and remove all plastic coverings.
2. Remove Mounting Plate (A) from Canopy (I) by removing Canopy Screws (H).
3. Attach Mounting Plate (A) to the ceiling outlet box and secure with Mounting Screws (B) and other proper fasteners from your local hardware store.

ASSEMBLY & INSTALLATION CONT.

4. Feed the safety steel wire and fixture wires through the Connection Rods (K) (L) (M) (N) (O) (P).
5. Screw Connection Rods (K) (L) (M) to the middle of Fixture Body (Q) according to the height needed.
6. Screw Connection Rods (N) (O) (P) to the Fixture Body (Q) according to the height needed.
7. Screw Connector (J) to the top of Connection Rods (K) (L) (M) (N) (O) (P).
8. Attach Canopy (I) with Metal Plate (G) to the nipple of the Connection Rods (K) (L) (M) (N) (O) (P). Secure Washer (C) and Nut (D) to Connection Rods (K) (L) (M) (N) (O) (P) using 1/4" D Wrench (AA). Secure Washer (E) and Nut (F) to Connector (J) using 1/2" D Wrench (BB). See diagram 1 on previous page.
9. Connect the steel safety wire from the fixture and the safety cable from ceiling. Refer to the illustration on previous page.
10. Wrap fixture ground wire (bare copper) around the green grounding screw on Mounting Plate (A) and connect to the ground wire (usually green or bare copper) on the outlet box using a wire nut. NOTE: It is imperative that the fixture is grounded.
11. Connect fixture neutral wire (ribbed) to the outlet box neutral wire (usually white) using a wire nut.
12. Connect the fixture hot wire (smooth with markings) to the outlet box hot wire (usually black) using a wire nut. CAUTION: Do not reverse the hot and neutral connections.
13. Attach Canopy (I) with Fixture Body (Q) to the affixed Mounting Plate (A). Secure with Canopy Screws (H).
14. Remove Collar Rings (V) from Caps (R). Affix Outer Glass Shades (U) to Caps (R) and secure with Collar Rings (V).
15. Attach Brackets (X) to the top of Socket Covers (T) and secure with Knurled Rings (S).
16. Remove Socket Rings (Y) from Socket Covers (T). Affix Inner Glass Shades (W) to Socket Covers (T) and secure with Socket Rings (Y).
17. Insert Bulbs (Z) into each of the sockets.
18. Restore power to outlet box and check operation of fixture.
19. Assembly is complete.

CARE INSTRUCTIONS

Do not use polishes or cleaners on the fixture. Wipe clean with a soft, dry cloth.