

BONNINGTON 2-TIER SCONCE

PARTS ENCLOSED

- (A) Wire Nuts (3)
- (B) Mounting Screws (2)
- (C) Screws (2)
- (D) Mounting Plate (1)
- (E) Finials (2)
- (F) Fixture (1)
- (G) Stems (24 +2 extra)
- (H) Crystals (12 +1 extra)
- (I) Plastic Washers (48 +4 extra)
- (J) Ball Finials (52 +2 extras)
- (K) Bulb (1)

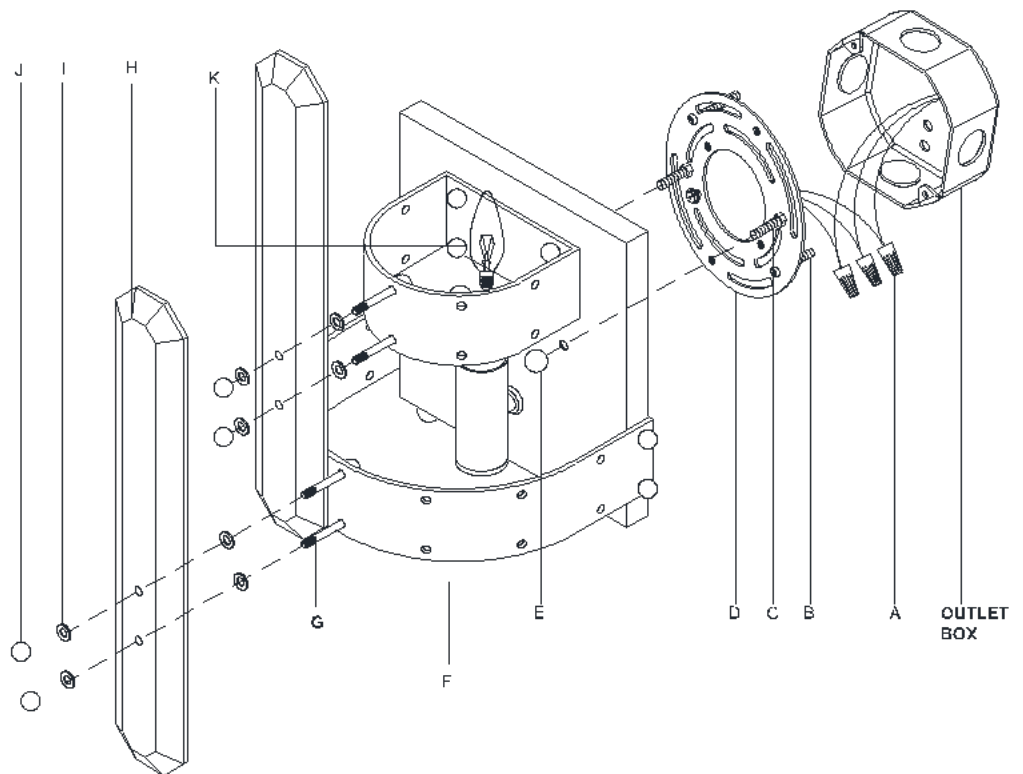

BONNINGTON 2-TIER SCONCE

IMPORTANT SAFETY INSTRUCTIONS

INSTALLATION BY A LICENSED ELECTRICIAN IS STRONGLY RECOMMENDED.

This fixture has been rated for up to one (1) 60-Watt maximum Type B standard (candelabra) incandescent light bulbs (not included) or one (1) 13-Watt compact fluorescent light bulbs (not included) or one (1) 5-Watt LED light bulbs (not included).

40-Watt Type B incandescent light bulbs is included. To avoid the risk of fire, DO NOT EXCEED THE RECOMMENDED LAMP WATTAGE.

WARNINGS

All wires are connected. When unpacking, be careful not to pull wires, as a bad connection may result. Do not connect electricity until your fixture is fully assembled. To reduce the risk of fire, electrical shock, or personal injury, always turn off fixture and allow it to cool prior to replacing the light bulb. Do not touch or look directly at the bulb when fixture is illuminated. Keep flammable materials away from lit bulb.



WARNING: This product can expose you to lead, which is known to the State of California to cause cancer and birth defects or other reproductive harm. For more information, go to www.P65Warnings.ca.gov.

THIS IS NOT A TOY AND THE PRODUCT HAS NO PLAY VALUE.



WARNING: STRANGULATION HAZARD

Keep cord at least 3 ft away from cribs, bassinets, and toddler beds. Keep out of reach of children under 3.

ASSEMBLY & INSTALLATION

SHUT OFF THE MAIN ELECTRICAL SUPPLY FROM THE FUSE BOX OR CIRCUIT BREAKER PANEL.

1. Carefully remove all parts from the box.
2. Remove the Mounting Plate (D) from the Fixture (F) by loosening the Finials (E).
3. Affix Mounting Plate (D) onto the outlet box and secure with Mounting Screws (B).
4. Connect the hot wire (BLACK) from the fixture to the hot wire from the outlet box (usually black). Fasten them together with a wire nut (A) provided and wrap the connection with electrical tape.
5. Connect the neutral wire (WHITE) from the fixture to the wire from the outlet box (usually white).
6. DO NOT REVERSE THE HOT AND NEUTRAL CONNECTIONS; OTHERWISE, SAFETY WILL BE COMPROMISED.
7. Attach the fixture onto the Mounting Plate (D). Let Screws (C) pass through the holes on the fixture, then secure with Finials (E).
8. Insert Bulb (K) into the socket.
9. Attach the Crystal (H) to the Stem (G) and secure with Plastic Washers (I) and Ball Finials (J).
10. Installation is complete, turn on power at fuse or circuit breaker.

CARE INSTRUCTIONS

Do not use polishes or cleaners on your lamp. Just wipe clean with a soft cloth.