



1920s ODEON ROUND CHANDELIER 44"

ASSEMBLY & INSTALLATION INSTRUCTIONS

**UNITED STATES ENGLISH**

**1920s ODEON ROUND CHANDELIER 44"****PARTS INCLUDED:**

- (A) Wooden Beam (not included)
- (B) Mounting Hardware (2 sets; for wooden beam only)
- (C) Wire Nuts (3)
- (C1) Mounting Plate (1)
- (C2) Quick Link (8 mm) (1)
- (C3) Hang Straight (1)
- (C4) Canopy (1)
- (C5) Collar (1)
- (C6) Set Bolt (1)
- (D1) Junction Box, 50lbs/22.7kg. MIN. FIXTURE RATED (not included)
- (D2) Ceiling Plate (1)
- (D3) Mounting Bolts (8 sets; for concrete ceiling only)
- (D4) Ceiling box (1)
- (D5) Nut Caps (2)
- (E1) Quick Link (8 mm) (1)
- (E2) Chain (8 mm) (1)
- (E3) Quick Link (8 mm) (1)
- (F) Body (1)
- (F1) Set Bolt (1)
- (G) Glass Drops (381 +15 extra)
- (H) Bulbs (33)
- (I) Hang Straight (1)
- (J) Safety Cable (1)

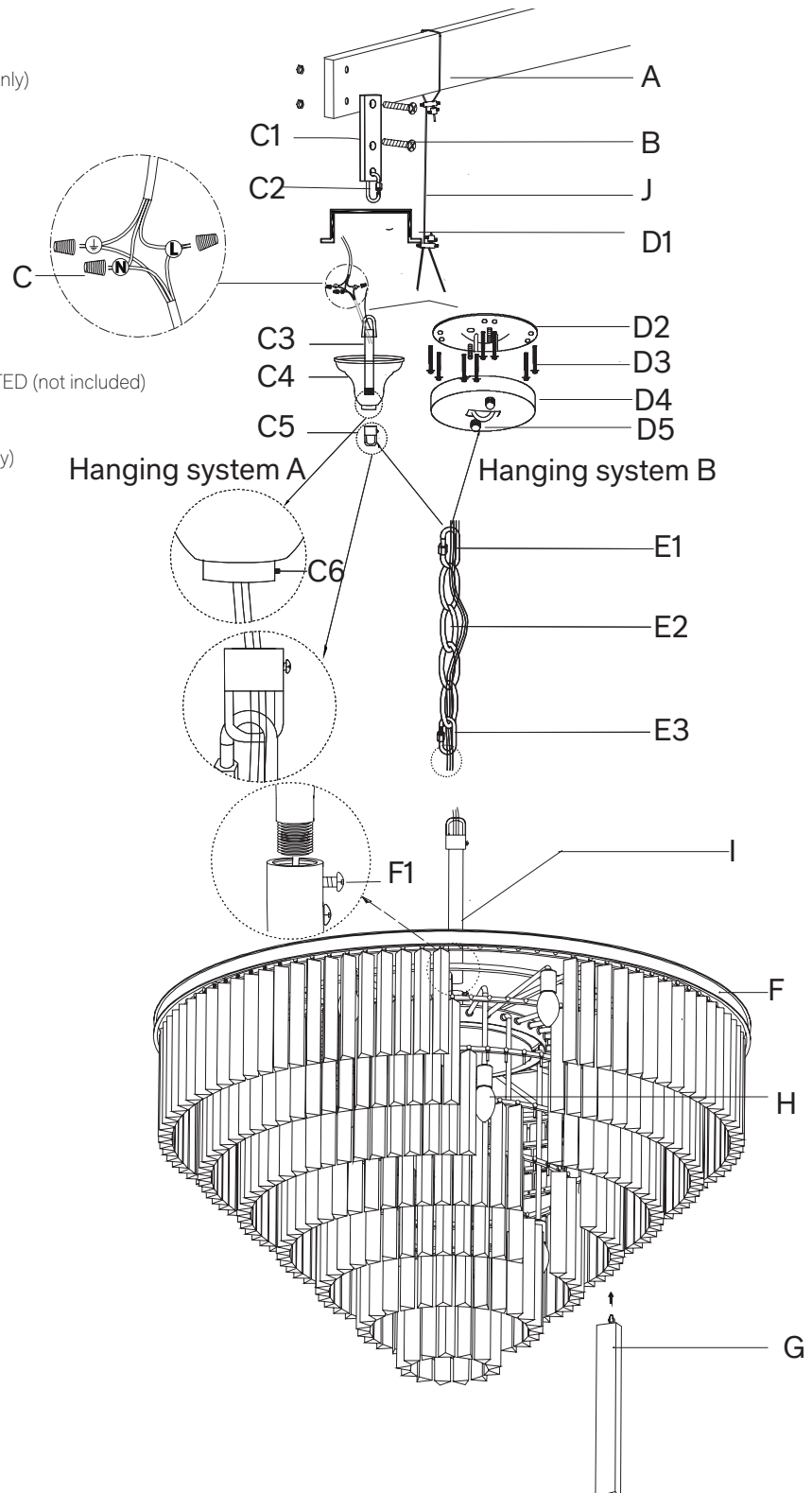

**IMPORTANT: PLEASE READ**

**PLEASE FOLLOW THE ASSEMBLY INSTRUCTIONS CLOSELY. IMPROPER ASSEMBLY OR INSTALLATION CAN RESULT IN PERSONAL OR PROPERTY DAMAGE. MOUNTING HARDWARE HAS BEEN PROVIDED FOR MOUNTING TO WOODEN BEAM (FOR HANGING SYSTEM A ) OR CONCRETE CEILING (FOR HANGING SYSTEM B). UNIQUE OR ALTERNATIVE INSTALLATION TYPES MAY REQUIRE DIFFERENT MOUNTING HARDWARE, WHICH HAS NOT BEEN INCLUDED. ALWAYS CONSULT WITH A LICENSED ELECTRICIAN BEFORE INSTALLATION.**

**INSTALLATION BY A LICENSED ELECTRICIAN IS STRONGLY RECOMMENDED.**

**IMPORTANT SAFETY FEATURES****BULBS**

This fixture has been rated for thirty-three (33) 25-watt maximum E12 TYPE B11 incandescent bulbs (not included) or thirty-three (33) 6-watt maximum E12 TYPE B11 LED bulbs (thirty-three (33) 4-watt E12 TYPE B11 LED lightbulbs included). To avoid the risk of fire, do not exceed the recommended wattage.

**VAULTED CEILING COMPATIBILITY**

This fixture fixed with hanging system A is not vaulted-ceiling compatible.

This fixture fixed with hanging system B is vaulted-ceiling compatible, up to a maximum ceiling slope of 15 degrees.

**DIMMER SWITCH COMPATIBILITY**

This fixture is dimmer-switch compatible and may be used with a forward- or reverse-phase dimmer switch.

**CEILING REINFORCEMENT**

Fixtures weighing 50lbs/22.7kg or more will require additional reinforcement above the ceiling where they are to be installed.

**WARNINGS**

All wires are connected. When unpacking, be careful not to pull wires, as damage may result. Do not connect electricity until the fixture is fully assembled. To reduce the risk of fire, electrical shock, or personal injury, always turn off fixture and allow it to cool prior to replacing the lightbulbs. Do not touch or look directly at the bulbs when fixture is illuminated. Keep flammable materials away from lit bulbs.

**WARNING: STRANGULATION HAZARD**

Keep cord at least 3 feet (91cm) away from cribs, bassinets, and toddler beds.

Keep out of reach of children under 3 years of age.

**THIS PRODUCT IS NOT A TOY AND HAS NO PLAY VALUE.**

**INSTALL SAFETY CABLE:**

1. Remove the nut locker A & B by loosening the set screw from the ceiling safety cable before installation.
2. Insert the ceiling safety cable through the nut lockers as the drawing shows.
3. Fasten the nut locker A with set screw/bolt.
4. Fasten the nut locker B with set screw/bolt.

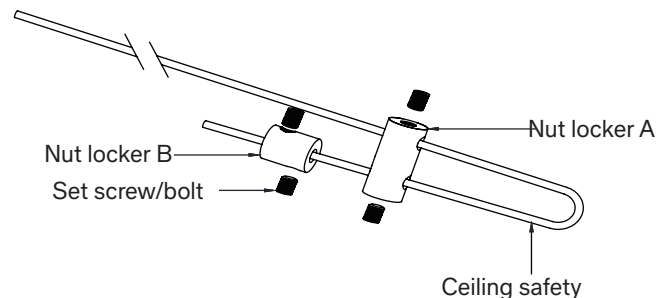

**ASSEMBLY AND INSTALLATION****SHUT OFF THE MAIN ELECTRICAL SUPPLY FROM THE FUSE BOX OR CIRCUIT BREAKER PANEL.**

1. Carefully remove all parts from the box and remove all plastic coverings.
  2. Turn OFF power to junction box (D1) where the fixture will be installed.
  3. The implementation of hanging system depends on whether the ceiling is vaulted or level.
  4. Hanging system A is for level ceiling, which include mounting hardware (B), mounting plate (C1), quick link (C2), hang straight (C3), canopy (C4), and collar (C5). Loosen the set bolt (C6) and remove the collar (C5) from the hang straight (C3). Insert the hang straight (C3) through the canopy (C4), reattach the hang straight (C3) to collar (C5) and secure with set bolt (C6).
  5. Hanging system B is for vaulted and level ceiling, which include ceiling plate (D2), mounting bolts (D3), ceiling box (D4), and nut caps (D5). Loosen the nut caps (D5) and remove the ceiling plate (D2) from the ceiling box (D4).
  6. Fasten the hang straight (I) to the body (F) and secure with set bolt (F1).
  7. Attach the chain (E2) to the hang straight (I) with quick link (E3).
  8. Have a professional contractor reinforce ceiling. Attach the safety cable (J) to ceiling beam through the junction box (D1), then attach the safety cable to the fixed fixture on the ceiling with the nut locker.
  9. Hanging system A: Attach the mounting plate (C1) to the wooden beam (A) with mounting hardware (B). Attach the hang straight (C3) to mounting plate (C1) with quick link (C2).
  10. Hanging system B: Attach the ceiling plate (D2) to the ceiling with mounting bolts (D3).
  11. Move the fixture body (F) up to hang straight (C3) or ceiling plate (D2), attach the quick link (E1) to hang straight (C3) or ceiling plate (D2).
  12. Loosen the set bolt (C6) or nut caps (D5), move the canopy (C4) or ceiling box (D4) down from the ceiling and feed the wires through the hang straight (C3) or ceiling box (D4).
  13. Carefully inspect the fixture wires. One is the ground wire (marked with ). The second is the neutral wire (marked with N). The third wire is the live/hot wire (marked with L).
  14. Connect the fixture ground wire to the power supply ground wire with wire nut (C).
- NOTE: IT IS IMPERATIVE THAT THE OUTLET BOX IN YOUR HOME BE PROPERLY GROUNDED.
15. Connect the fixture neutral wire to the power supply neutral wire with wire nut (C).

16. Connect the fixture live/hot wire to the power supply live/hot wire with wire nut (C).

CAUTION: DO NOT REVERSE THE HOT AND NEUTRAL CONNECTIONS, AS SAFETY WILL BE COMPROMISED.

17. Move the canopy (C4) or ceiling box (D4) up to the ceiling, then fasten the set bolt (C6) or nut caps (D5).
18. Fasten bulbs (H) to the sockets.
19. Hang the glass drops (G) starting from inner to outer. To ensure the balance of the fixture body during glass drops (G) installation, please hang the glass drops (G) in balanced way on the opposite side.
20. Restore power to the junction box and test fixture.
21. Assembly is complete.

**CARE INSTRUCTIONS**

Do not use polishes or cleaners on the fixture. Wipe clean with a soft, dry cloth.

**HEIGHT ADJUSTMENT INSTRUCTIONS**

1. Saw through the chain along a weld line, then use two pairs of pliers to gently pry the links apart along a split-line formed in each link so that a space is created large enough for the link to be removed from the remaining chain. See diagram 1, 2 & 3.

**NOTE:**

- a. The chain length may be shortened from either end.
  - b. Use a clean cloth or a folded piece of paper between the pliers and the link to protect the finish of the link during the chain bending.
2. Once the chain is at the desired length, install the chain gently with the quick link as shown in diagram 4.

**ATTENTION: ADJUSTING THE HANG HEIGHT**

Any adjustments or alterations to the fixture, cord, or overall hang height that differ from those detailed on RH.com will void the Laboratory Listing and Approvals (UL, ETL, CSA, etc.). If the listing is voided, this means the product may no longer be safe for use as modified. RH does not recommend modifying the product.

