

STELO TASK TABLE LAMP

**PLEASE FOLLOW THE ASSEMBLY INSTRUCTIONS
CLOSELY. IMPROPER ASSEMBLY CAN RESULT
IN PERSONAL OR PROPERTY DAMAGE.**

PARTS ENCLOSED:

- (A) Lamp body (1)
- (B) Base (1)
- (C) Transformer (1)

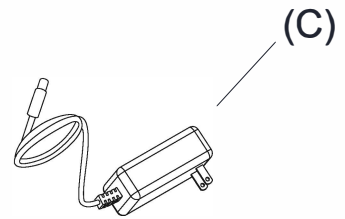
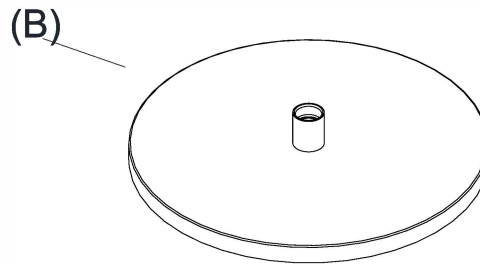
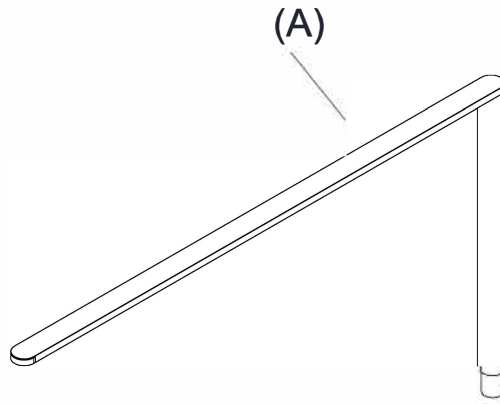

STELO TASK TABLE LAMP

ASSEMBLY

A1

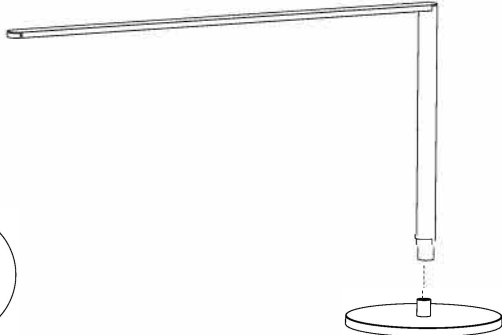

1. Push down the lamp body onto the base.

A2

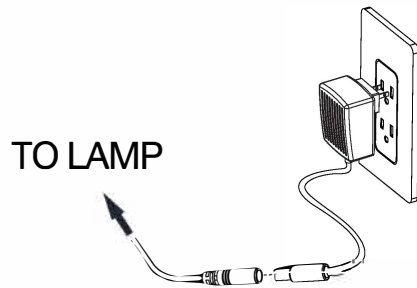

2. Plug the transformer into the wall. Insert the transformer's cord into the end of the lamp's cord.

A3

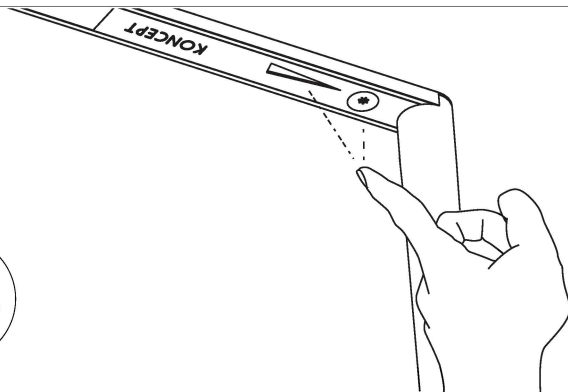

3. Press and hold the circle to change color between warm and cool. Adjust brightness by placing your finger along the touchstrip.

STELO TASK TABLE LAMP

IMPORTANT PLEASE READ**WARNINGS:**

To reduce the risk of fire, electric shock or injury:

- Do not use outdoors or near water.
- Do not handle the transformer or lamp with wet hands.
- Do not look directly at the LEDs.

DO NOT USE AN EXTERNAL DIMMER WITH THIS LAMP.

Overheating can result in reduced LED life. To avoid overheating:

- Do not expose to direct sunlight.
- Recommended ambient temperature: below 25° C / 77° F.
- Remove the plastic packaging before using.

THIS IS NOT A TOY AND THE PRODUCT HAS NO PLAY VALUE

**WARNING: STRANGULATION HAZARD**

Keep cord at least 3 ft away from cribs, bassinets, and toddler beds.

Keep out of reach of children under 3.

PRODUCT FEATURES

1. Adjust the lamp's height "telescopically" from 12.5" to 20.1" or anywhere in between.
2. The lamp's body can swivel 360.°
3. Charge your phone, tablet or other USB-compatible device with the built-in USB port on the base.

