



RECLAIMED OAK SINGLE EXTRA-WIDE WASHSTAND

DECK MOUNT FAUCET

ASSEMBLY & INSTALLATION INSTRUCTIONS

ENGLISH

CRATE STORAGE

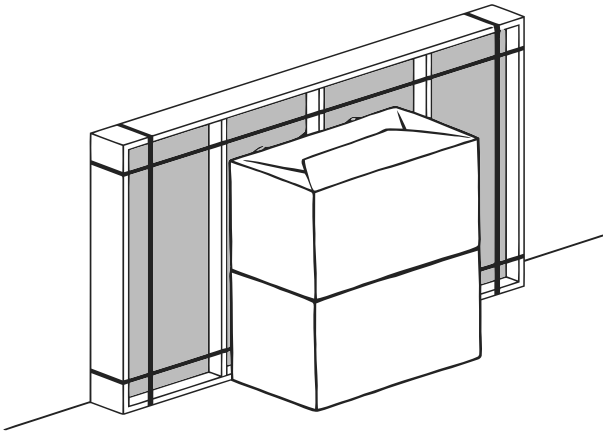

Keep Stone Top in its crate until installation.
Store crate vertically in a safe location.

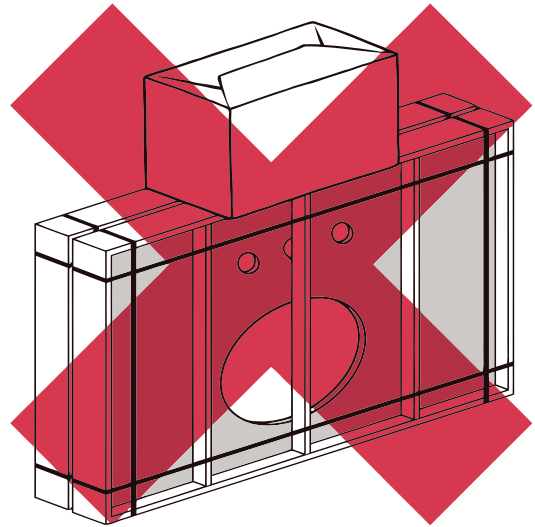

Do not stack anything on top of crate.

STONE TOP TRANSPORT

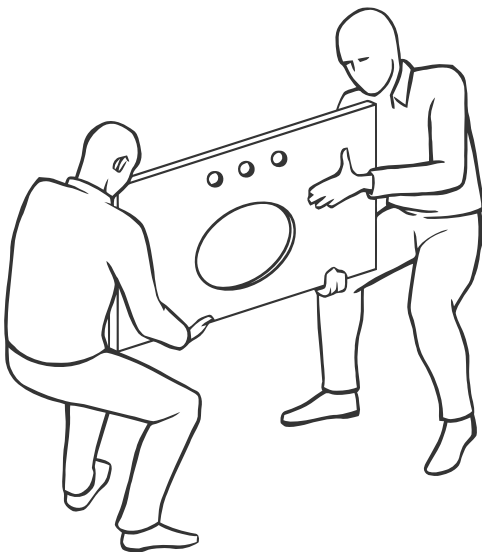

When moving Stone Top always use a two-person crew.
Always carry Stone Top vertically.

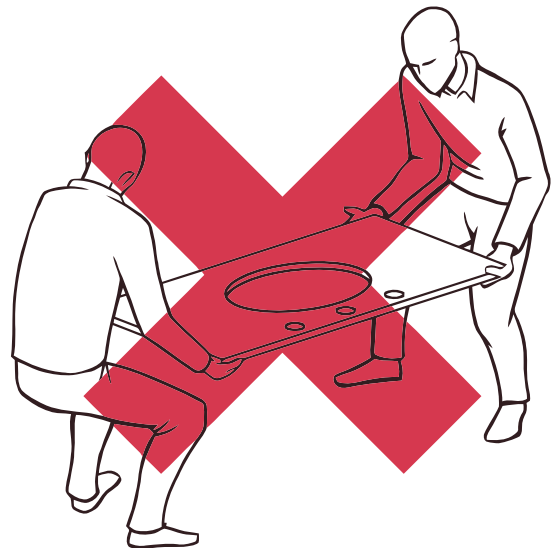

Do not carry Stone Top horizontally as it increases the risk of breakage or cracking.

STONE TOP UNPACKING

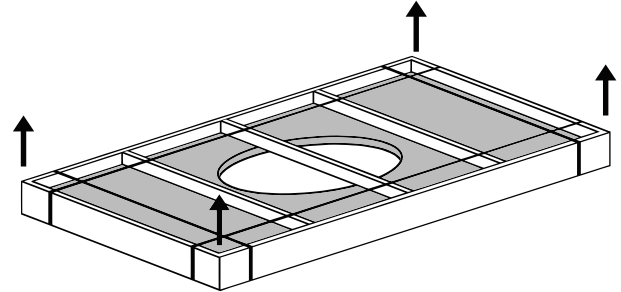
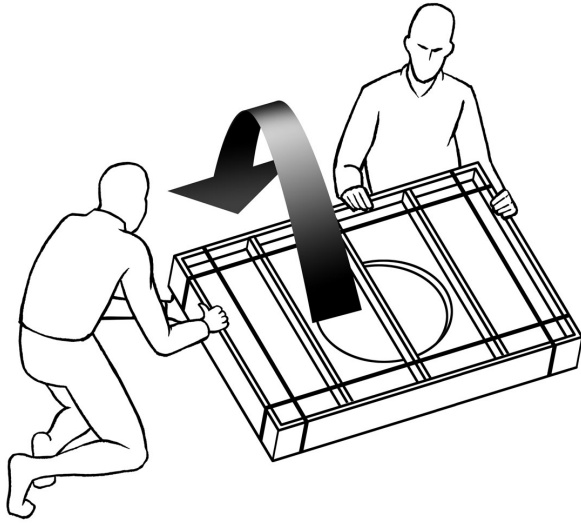

Remove metal bands, unscrew the slats or lid, and lift the Stone Top out of the crate.

Carefully, without allowing any freefall, rotate the crate from vertical to flat.

STONE TOP INSPECTION

Before you begin, inspect the Stone Top for cracks and defects. If defects are detected, do not install and please call 800-762-1005. If no defects are detected, clean Stone Top with a soft cloth.

PARTS INCLUDED

- (A) Basin (1)
- (B) Stone Top (1)
- (C) Vanity Base (1)

TOOLS NEEDED

- Carpenter's Level

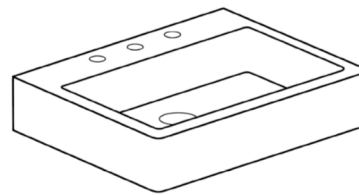
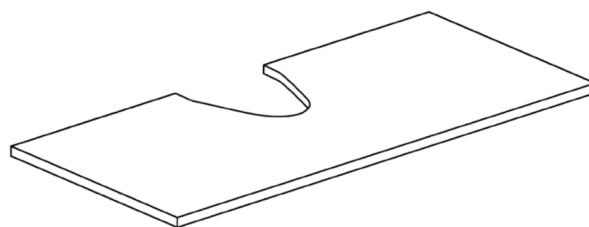
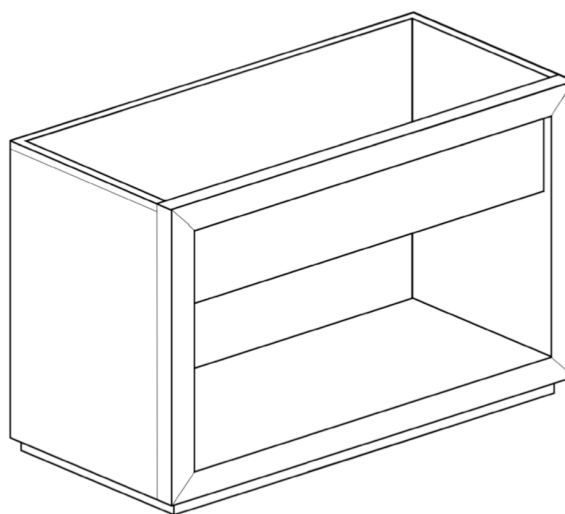
**A****B****C****STANDARD STONE TOP INSTALLATION GUIDELINES**

1. Using a two-person crew, lift Stone Top and set it on top of the Vanity Base [C].

PRIMARY INSTALLATION REQUIREMENTS

Professional two-person crew.

Water supply and drain piping installed according to local plumbing and building codes (sold separately).

Wall and floor are square and plumb at installation site.

Vanity Base [C] installed square and plumb with wall and floor. Vanity Base [C] also needs to be level.

Ensure Stone Top [B] is the correct size to match the Vanity Base [C].

CAUTION: INSTALLATION BETWEEN TWO WALLS

INSTALLATION BETWEEN TWO WALLS REQUIRES SPECIAL CARE

IF INSTALLING BETWEEN TWO WALLS, STOP HERE AND FOLLOW THE NEXT SET OF INSTRUCTIONS

STANDARD STONE TOP INSTALLATION GUIDELINES

1. Using a two-person crew, lift Stone Top and set it on top of the Vanity Base [C].

STONE TOP INSTALLATION BETWEEN TWO WALLS

1. Using a two-person crew, lift Stone Top and set its rear edge on the back of the Vanity Base [C] (closest to the rear wall.)
2. Lower front of Stone Top onto the Vanity Base, making sure both ends are lowered at the same rate.
3. Do not shimmy, twist or turn the Stone Top while lowering as this increases the risk of breakage.

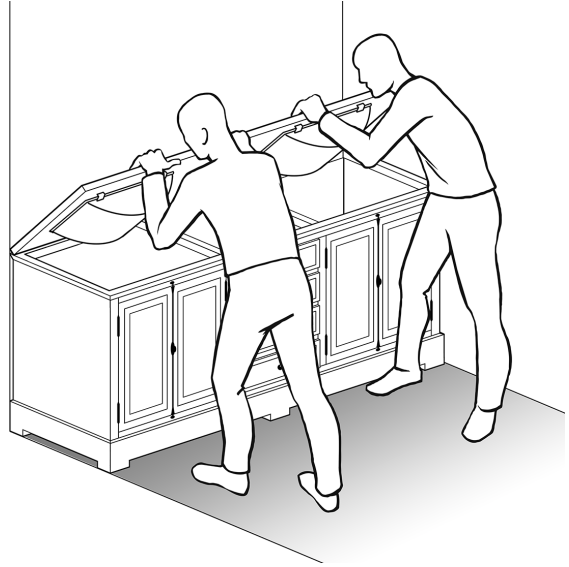

BASIN INSTALLATION

1. Apply sealant to bottom of basin [A].
2. Place Basin [A] on stone top [B].

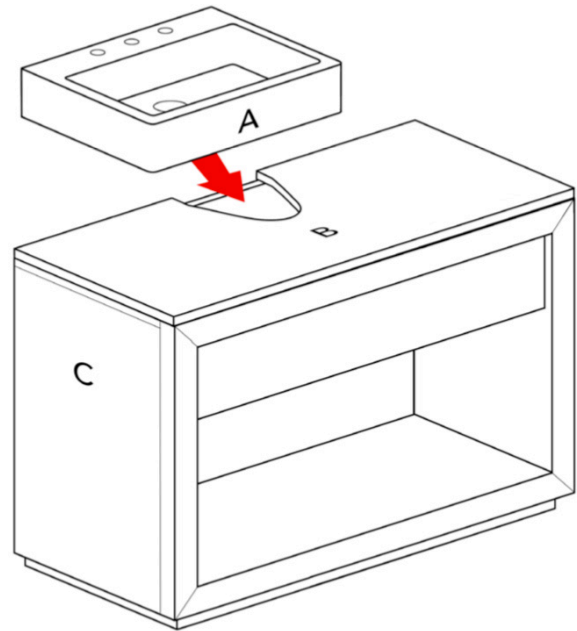

WASHSTAND DIMENSIONS IN MILLIMETERS

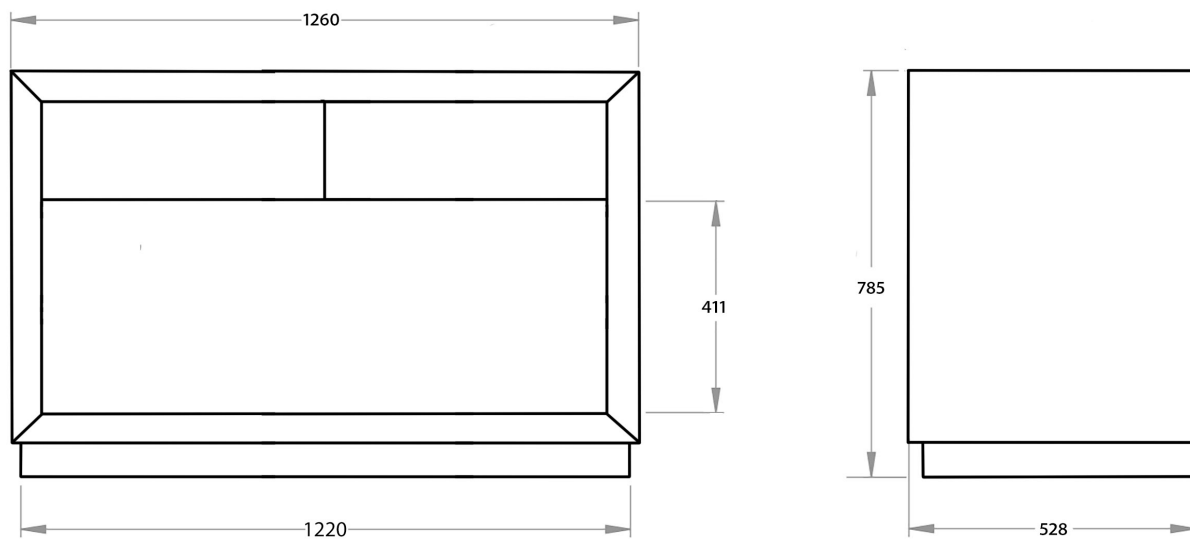

STONE TOP DIMENSIONS IN MILLIMETERS

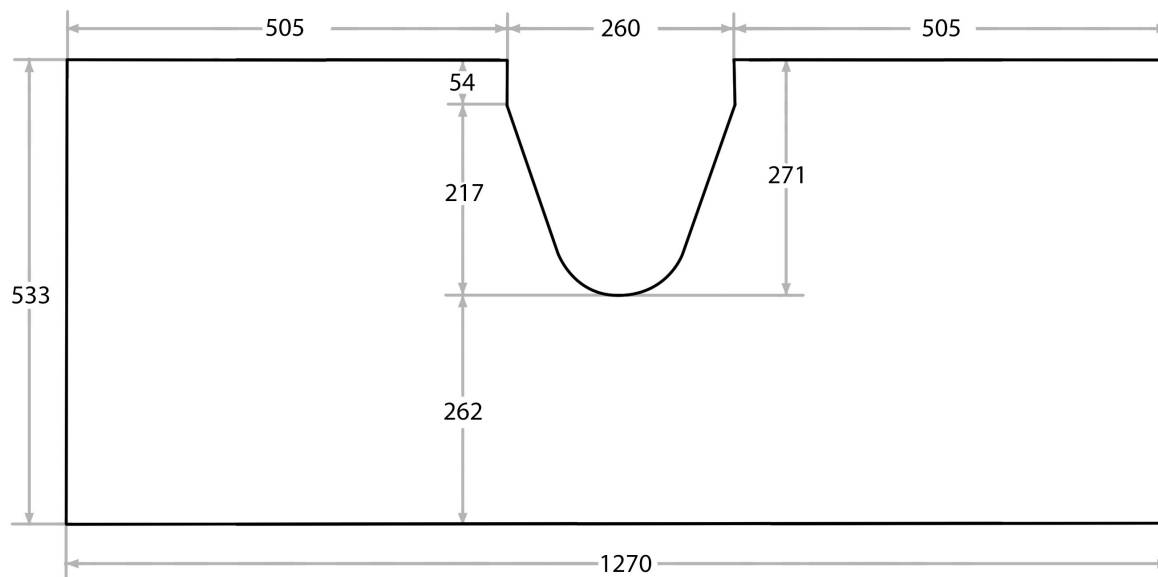

SMALL BASIN DIMENSIONS IN MILLIMETERS

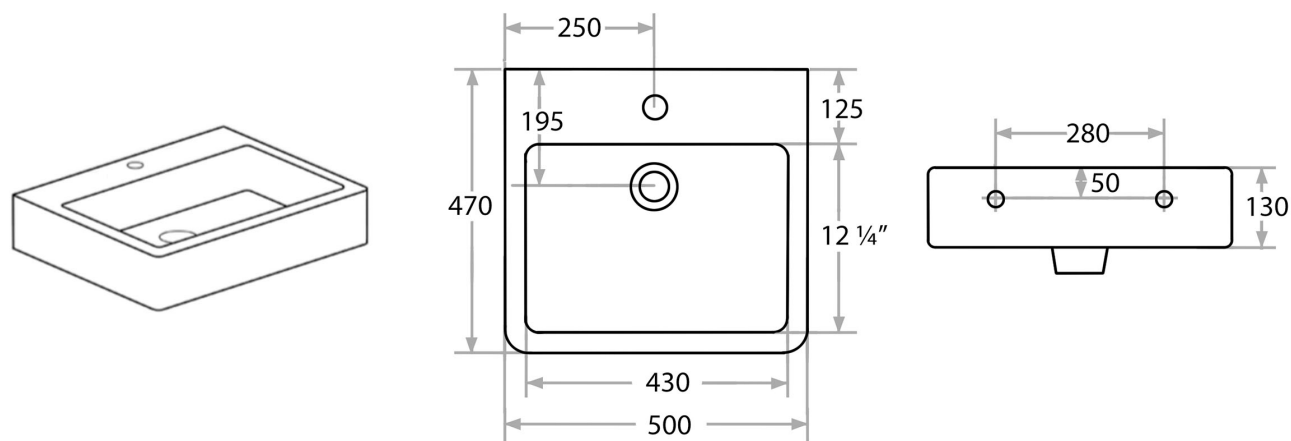

LARGE BASIN DIMENSIONS IN MILLIMETERS

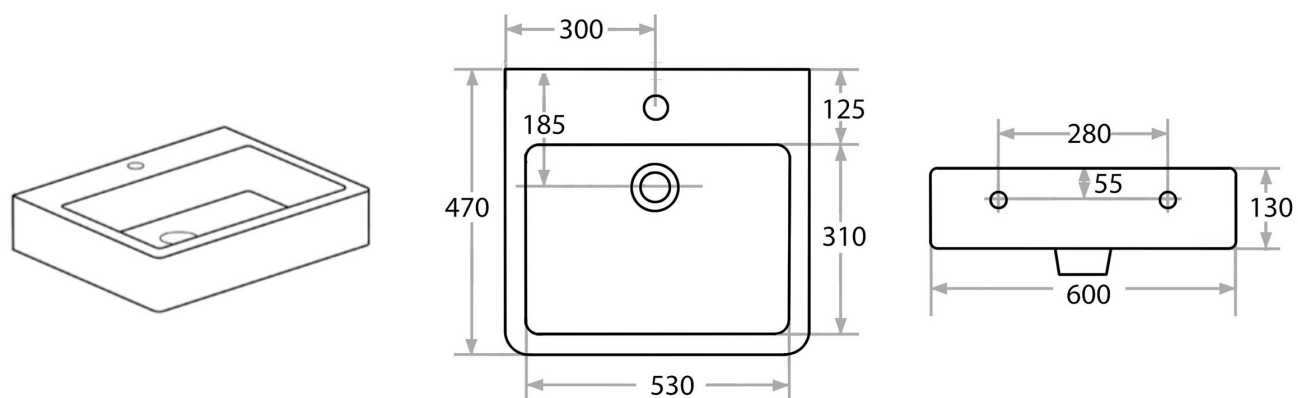

WARRANTY

If you are not completely satisfied with your purchase, please contact us to return or exchange your item(s) within 30 days of the delivery date, with proof of purchase. Note that returns or exchanges are not accepted for special orders, items that have been installed, mattresses and/or foundations no longer in their original packaging, and other items listed below. Other exclusions may apply. Contact us for details. Unfortunately, galleries cannot accept returns of furniture or other large items.

CLEANING AND MAINTENANCE

Avoid abrasive and harsh chemical cleaners.

RH Stone Tops have a honed finish, hand-polished edges, and are sealed twice with inert silicone sealant.

Stone Tops should be re-sealed annually.