

CRATE STORAGE

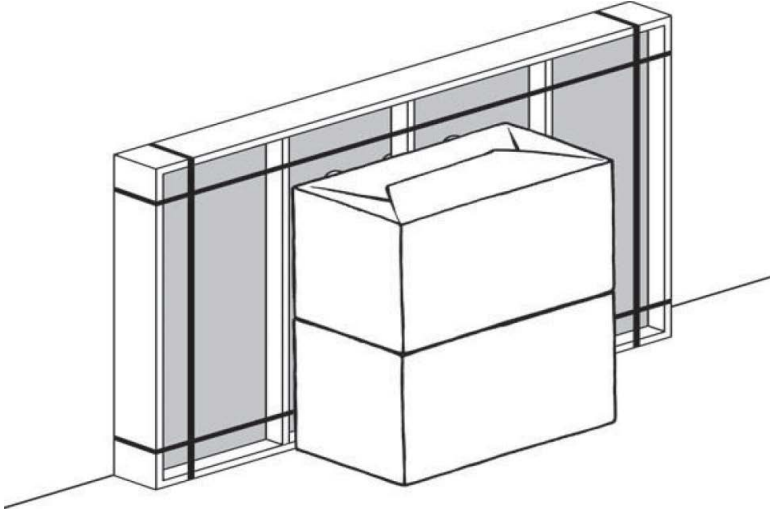

- Keep stone top in it's crate until installation
- Store crate vertically in a safe location

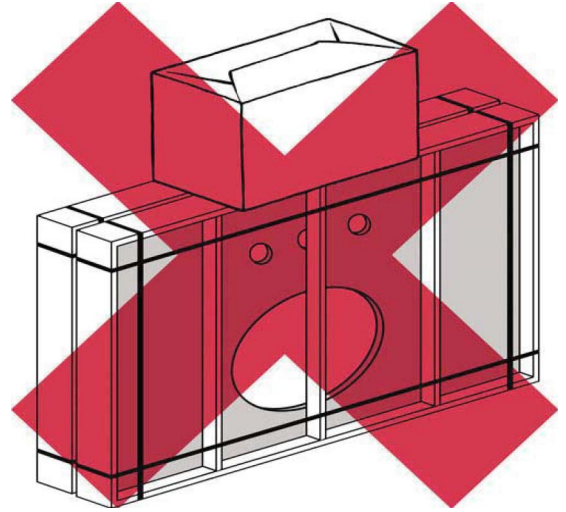

- Do not stack anything on top of crate

TOOL AND MATERIAL REQUIREMENTS

- Flat, non-abrasive work surface (blanket or smooth cardboard)
- Sealant
- Phillips-head screwdriver
- Carpenter's level
- Drill
- Pencil
- Hammer

PARTS LIST

A. Stone Top

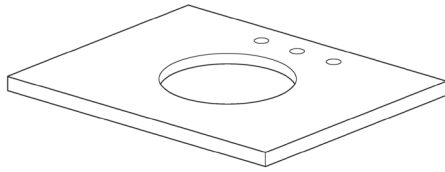

B. Basin

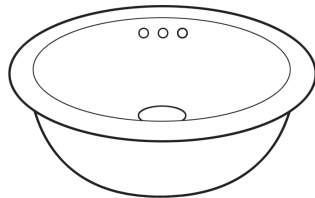

C. Right side assembly

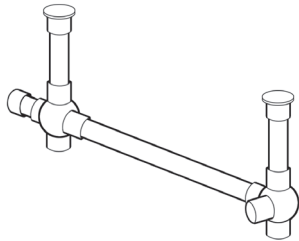

D. Left side assembly

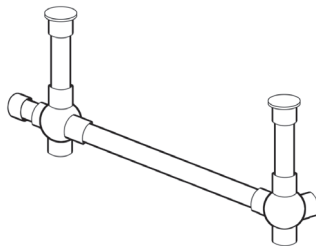

E. Center bar



F. Wall flanges (x2)

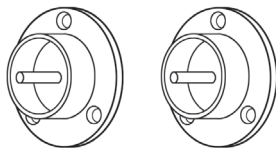

G. Washstand legs (x2)



H. Allen wrench

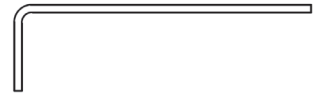

I. 3/16" Rubber Pad(x4)

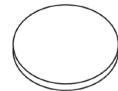

J. 1/4" Rubber Pad(x4)

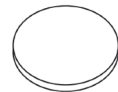

K. Drywall anchors (x6)

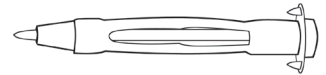

L. Calk in anchor (x4)



M. Calk in anchor sleeve (x4)

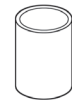

N. "L" Bracket (x4)

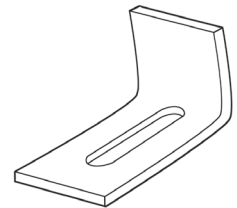

O. Washer (x4)



P. Screw (x4)



Q. Setting tool



R. Foot pins (x2)



S. Set screw (x2)

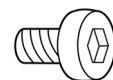

GRAMERCY SINGLE METAL WASHSTAND

STONE TOP UN-PACKING AND TRANSPORT

WHEN MOVING STONE TOP, ALWAYS USE A TWO-MAN CREW

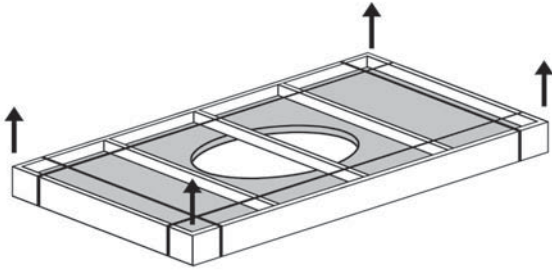

Remove metal bands, unscrew the slats or lid, and lift the Stone Top out of the crate.

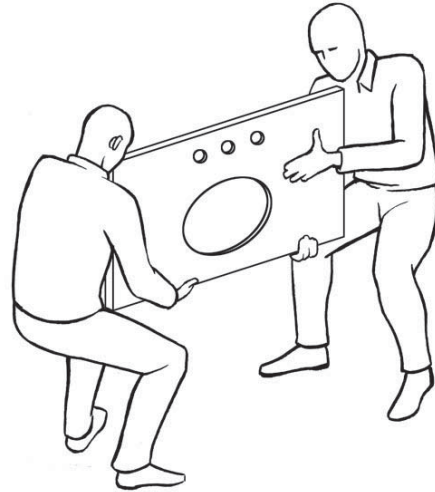

Always carry Stone Top vertically

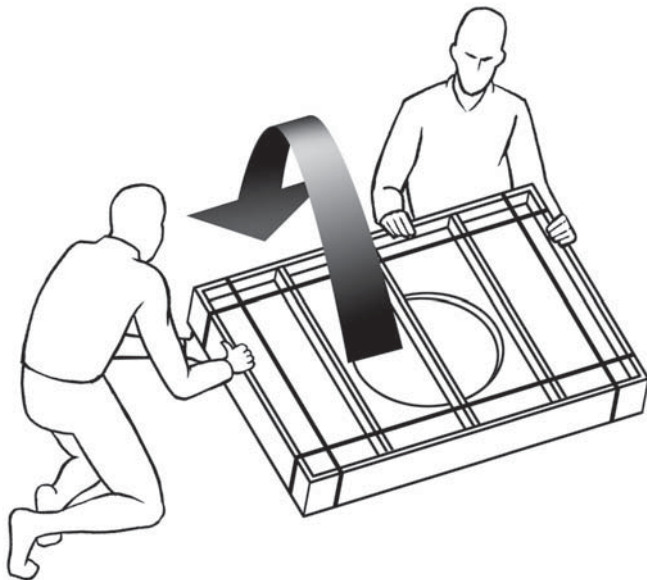

Carefully, without allowing any freefall, rotate the crate from vertical to flat.



Do not carry Stone Top horizontally as it increases the risk of breakage or cracking.

STONE TOP INSPECTION

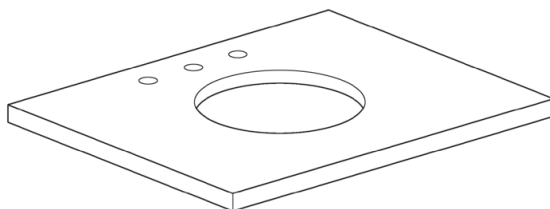

Inspect the Stone Top for cracks or defects. If defects are detected, do not install and please call 877-777-7059. If no defects are detected; clean Stone Top with a soft cloth.

CLEANING AND MAINTENANCE INSTRUCTIONS

- Avoid abrasive and harsh chemical cleaners.
- RH Stone Tops have a honed finish, hand polished edges, and are sealed twice with inert silicone sealant
- Stone Tops should be re-sealed annually

PRIMARY INSTALLATION REQUIREMENTS:

- Professional two-man crew.
- Water supply and drain piping installed according to local plumbing and building codes (sold separately).
- Wall and floor are square and plumb at installation site.
- Vanity Base installed square and plumb with wall and floor. Vanity Base also needs to be level.
- Ensure Stone Top is the correct size to match the Vanity Base.

WARNINGS:

- Do not over-tighten parts during assembly
- Make final adjustment of set screws after installation
- The washstand may not be appropriate for locations with small children
- The foot pins must be recessed into finished floor in order to reduce stress on the rods.

ASSEMBLY INSTRUCTIONS:

1. Place right side assembly (C) upside down and screw one of the legs (G) into the base of the round knuckle. Set right side assembly aside on a flat, non-abrasive work surface.
2. Place left side assembly (D) upside down and repeat the process described in step 1.
3. With one person holding the right side assembly/leg and the other holding the left side assembly/leg. Carefully position the center bar (E) in the collar opening of the round knuckle on each side. (See illustration.) Using Allen wrench (H), adjust set screws (S) in collar openings on each side to secure the center bar. (**Do not over-tighten the set screws at this point. Tighten them only enough to hold the rod in place. Set screws can be adjusted further after the washstand is fully installed.**)
4. Remove the threaded foot pin (R) from the bottom of each washstand leg and place it to the side.
5. With one person on either side of the assembled washstand, carefully position the washstand upright in the position where it will be mounted. Position wall flanges (F) on each side of the assembly, but leave them unattached.

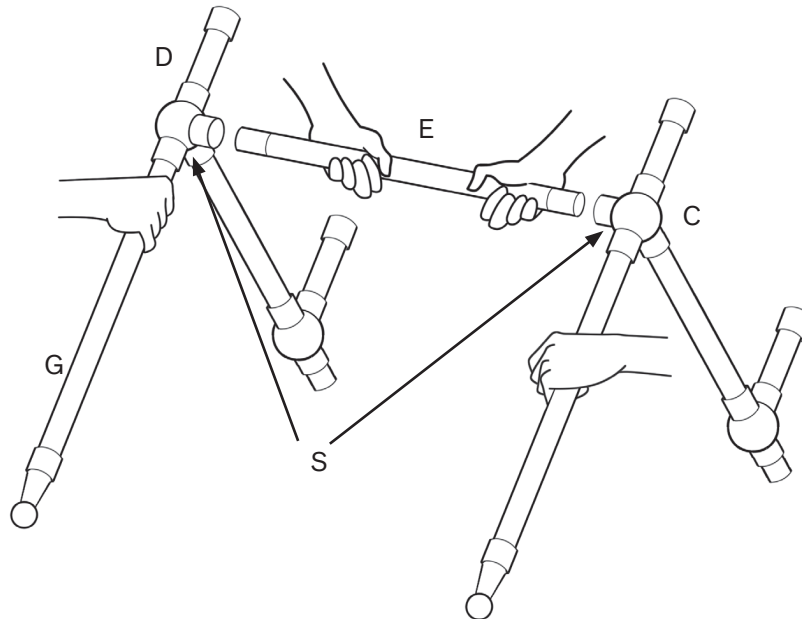

ASSEMBLY INSTRUCTIONS CONT'D:

6. Using a carpenter's level, ensure that each leg is vertical. Mark the position of wall flange screw holes on the wall with a pencil. And mark the position where anchor pins will rest in the floor.
7. Carefully place assembled washstand aside, and drill holes into the floor where marked (1/4" diameter x 7/16" deep).
8. Where marked, mount wall flanges to the wall with drywall anchors (K).
9. Replace metal foot pins in the feet of the assembled washstand.
10. Place washstand carefully in its final position with the side assembly rods placed in the mounted wall flanges and the foot pins recessed into the floor.
11. One person should now hold the washstand in place while the other person tightens the Allen head set screws of the two wall flanges (Do not over-tighten the set screws.)
12. Place one 3/16" rubber pad (I) on each of the four top surfaces on the washstand and using two people, lift the stone top carefully placing it in position on top of the washstand base. If the stone top needs slight leveling, substitute 1/4" pads (J) as necessary to stabilize.
13. Remove the stone top from the base and carefully place upside down on a flat nonabrasive work surface.
14. Using the setting tool (Q), hammer calk-in anchors (L) straight into pre-drilled holes on the underside of stone top. (See illustration.)

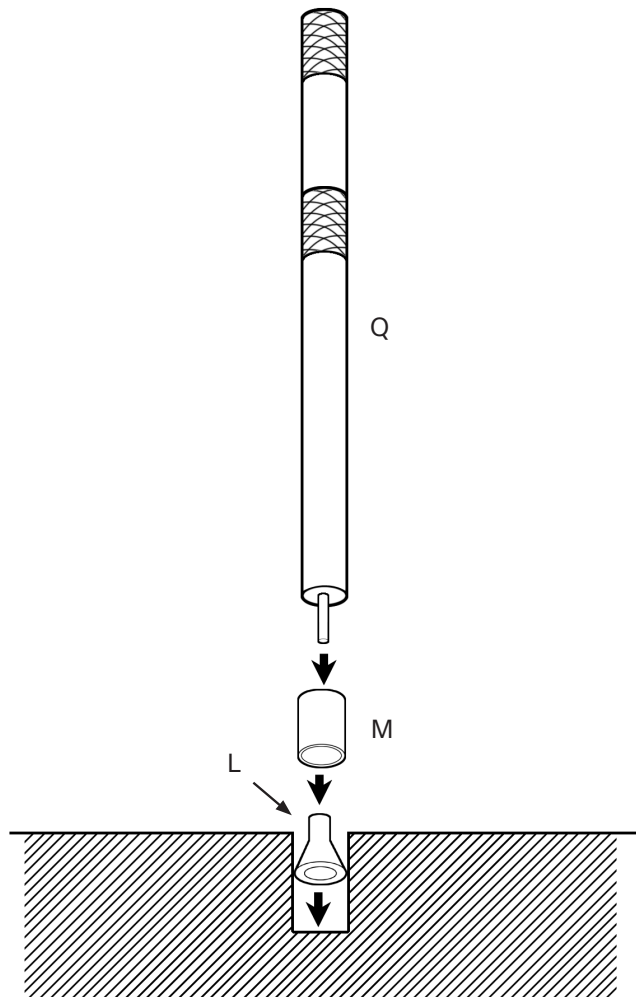

ASSEMBLY INSTRUCTIONS CONT'D:

15. Apply a continuous bead of sealant to the top surface of the rim of the basin (B) where it will contact the underside of the stone top. Position the basin in its final location upside down on the underside of the stone top. Overflow of the basin should be on the same side as pre-drilled faucet holes on the stone top.
16. Place four "L" brackets (N) with long sides over the basin rim and insert screws (P) through washers (O) and "L" brackets. Screw into calk-in anchors with a screwdriver. (See illustration.) (Do not over-tighten.) Ensure that the basin is securely attached to the stone top.
17. Using two people, turn stone top with attached basin over and position carefully on top of washstand base.

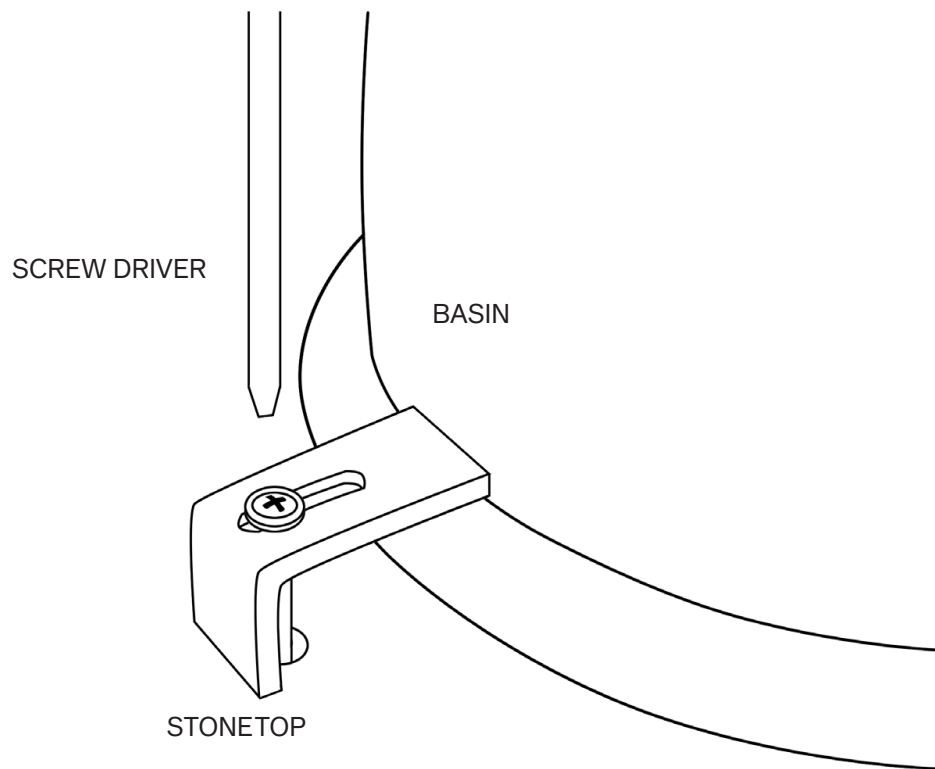

STONE TOP INSTALLATION



Caution! Installation between two walls requires special care.

If installing Stone Top between two walls, stop here and follow the next set of instructions.

Standard Stone Top Installation Guidelines

1. Apply a continuous bead of sealant to the top face of the Sink Basin [C] rim where the Stone Top [A] makes contact with the basin.
2. Using a two-man crew, lift stone top and set in on top of the Vanity Base [D].
3. Apply Silicone sealant at the seam where Backsplash [B] meets the wall.
4. Adjust set screws as needed for stability of the washstand, continuing to take care not to over-tighten,

Stone Top Installation Between Two Walls

1. Apply a continuous bead of sealant to the top face of the Sink Basin [C] rim where the Stone Top [A] makes contact with the basin.
2. Using a two-man crew, lift stone top and set it's rear edge on the back of the Vanity Base [D] (closest to rear wall) -- see below illustration.
3. Lower front of Stone Top onto the vanity base, making sure both ends are lowered at the same rate.
4. Do not shimmy, twist, or turn the stone top while lowering as this increases the risk of breakage.
5. Apply Silicone sealant at the seam where Backsplash [B] meets the wall.
6. Adjust set screws as needed for stability of the washstand, continuing to take care not to over-tighten,

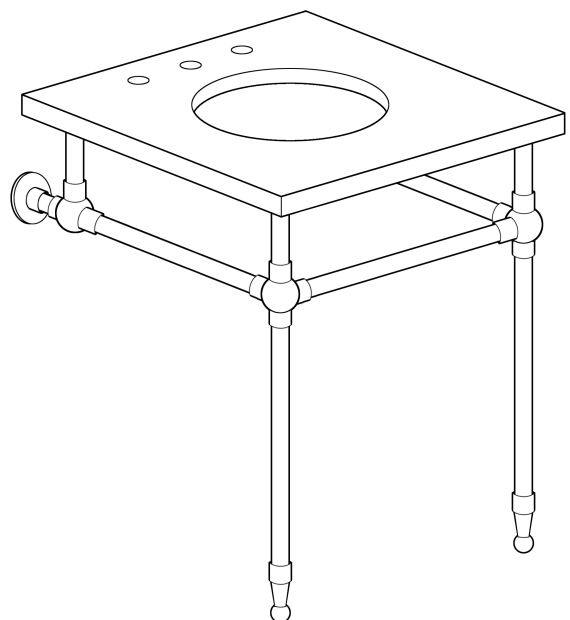
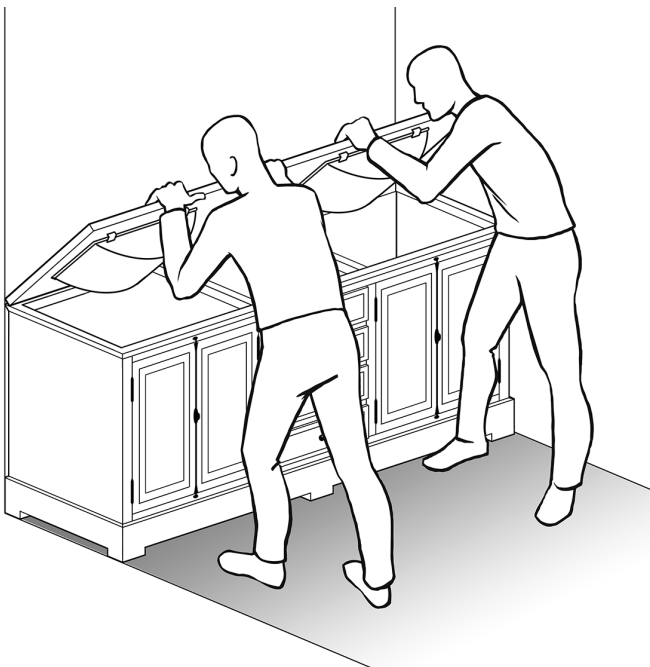

GRAMERCY SINGLE METAL WASHSTAND

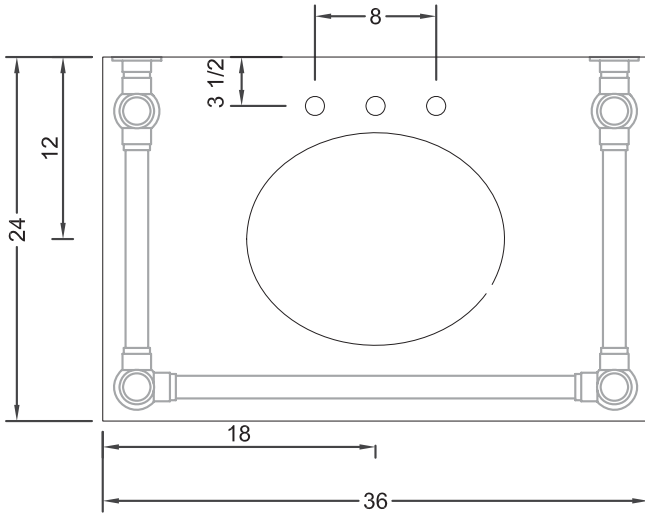

Top View

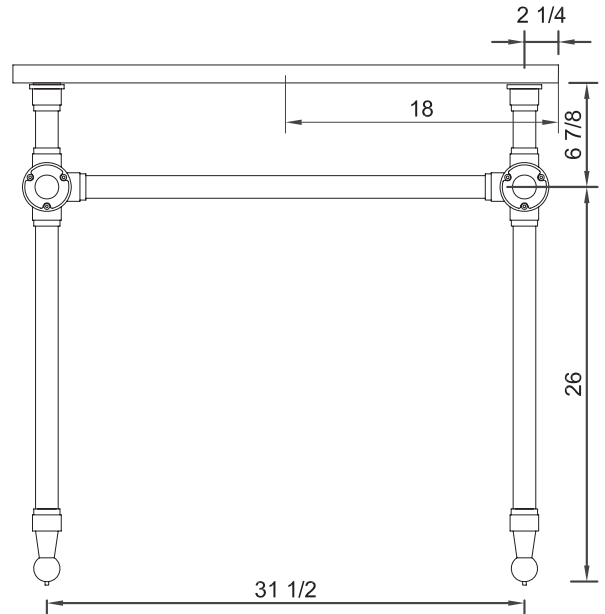

Back View

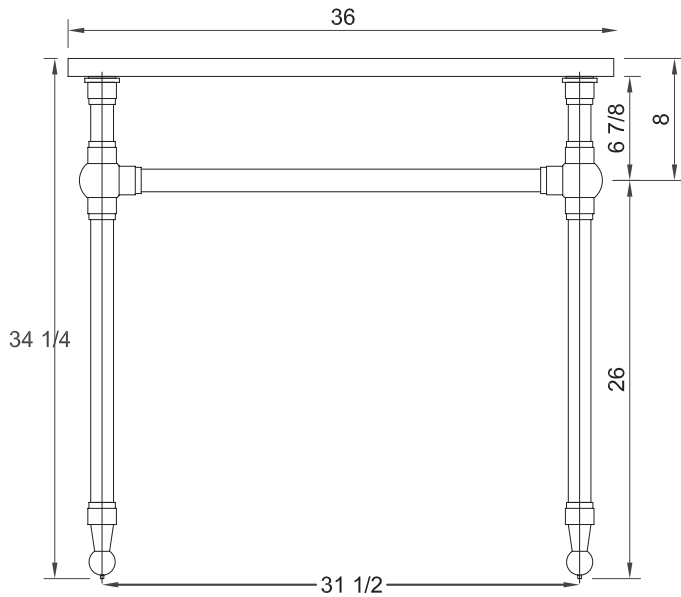

Front View

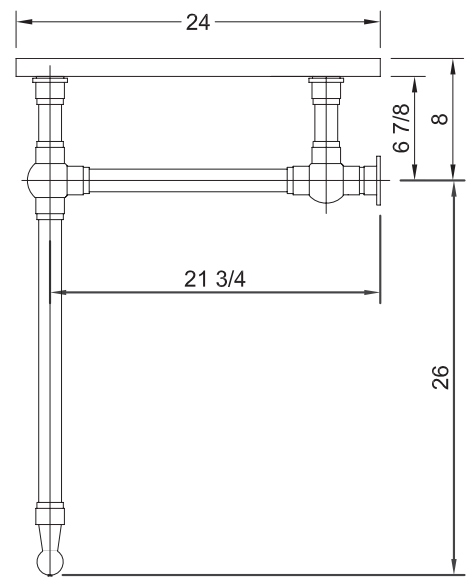

Side View

GRAMERCY SINGLE SINK WASHSTAND

DRAWINGS REPRESENT ORIGINAL DESIGN SPECIFICATIONS. ACTUAL PRODUCT DIMENSIONS MAY VARY SLIGHTLY. PROFESSIONAL INSTALLATION REQUIRED

Unless otherwise noted, all design and content, images, artwork, graphics, photography, text, and the like are copyrights, trademarks, trade dress, and/or intellectual property that are owned, controlled, or licensed by RH.

GRAMERCY SINGLE METAL WASHSTAND

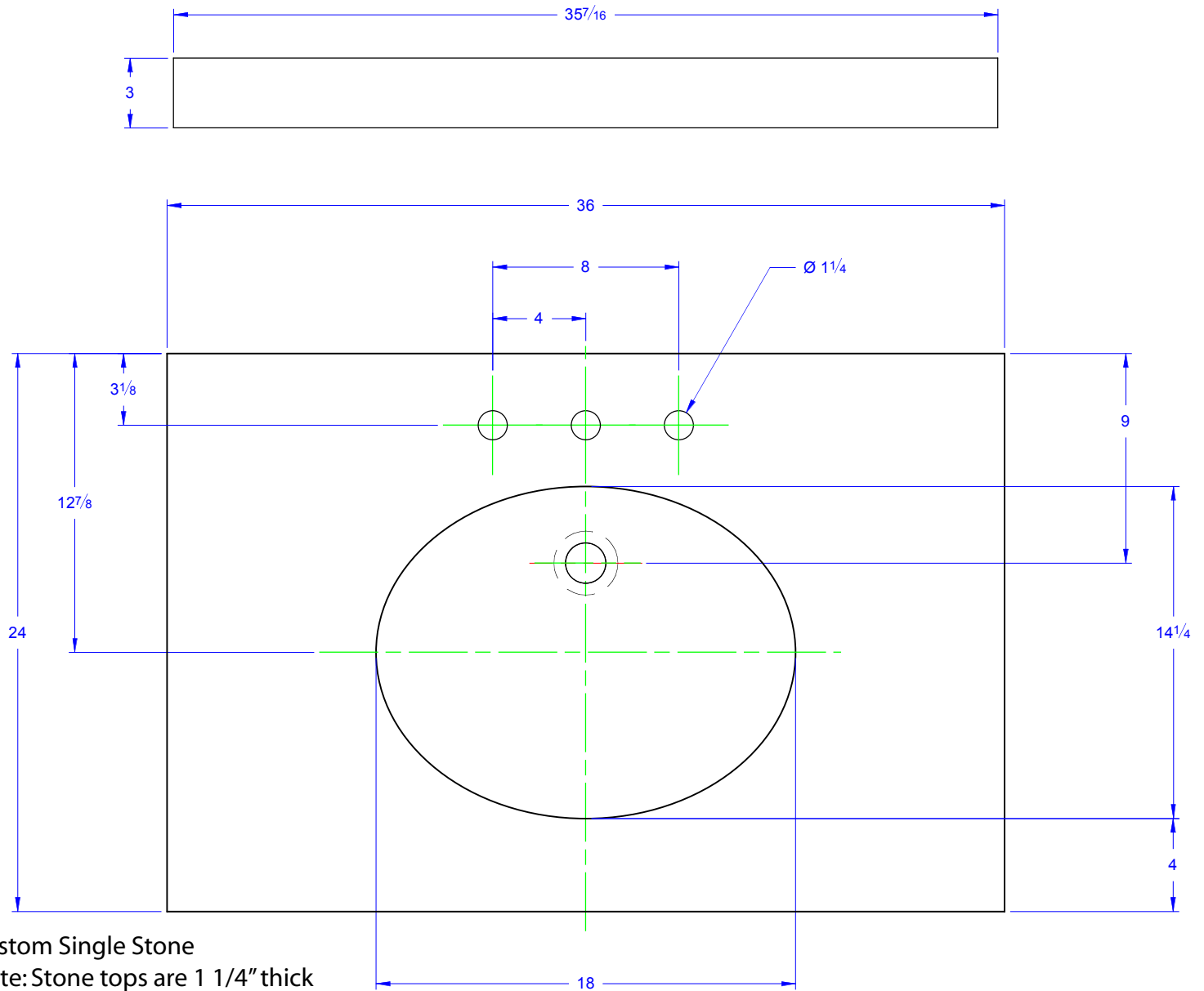

GRAMERCY SINGLE METAL WASHSTAND

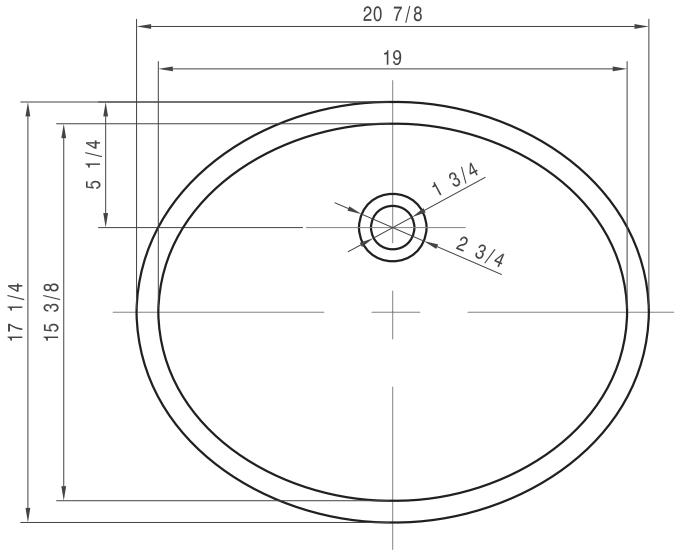

Top View

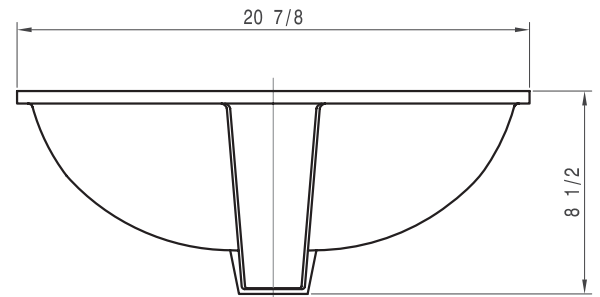

Back View

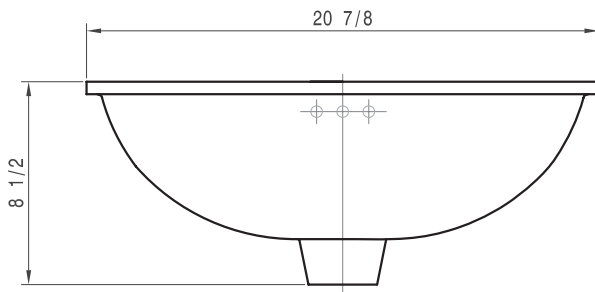

Front View

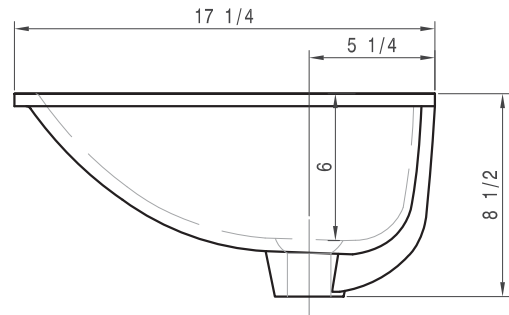

Side View