

BOWEN WALL MOUNT FLOATING DOUBLE VANITY SINK ASSEMBLY INSTRUCTIONS

I. Storage

1. Keep marble top in its crate until installation.
2. Store crate vertically in a place safe from being hit or knocked over.
3. Do not stack anything on top of the crate.

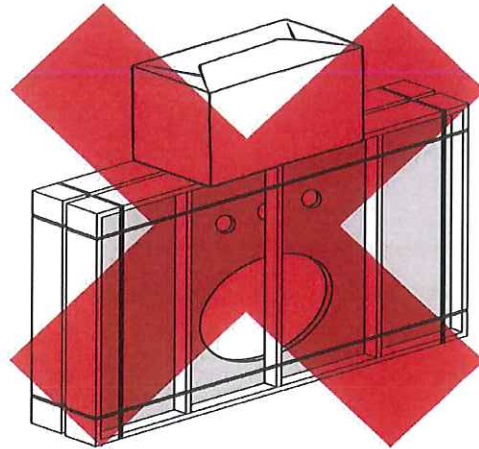
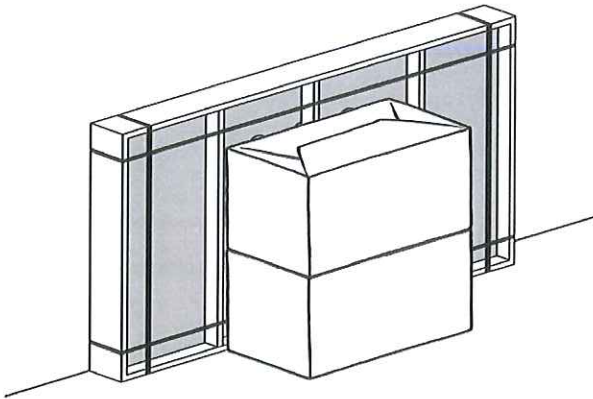

2. Opening crate

1. Before unpacking make sure you have installation requirements present:
 1. A professional two man crew
 2. Sink base installed according to instructions with plumb wall and floor
 3. Ensure the marble top is the correct one for the base.
4. Tools and materials required:
 1. Flat, non-abrasive work surface, such as a blanket or smooth cardboard
 2. Carpenter's level
 3. Phillips head screwdriver
 4. Sealant

2. Carefully, without allowing any free fall, rotate the crate from vertical to flat.
This is the only time the crate should be horizontal.

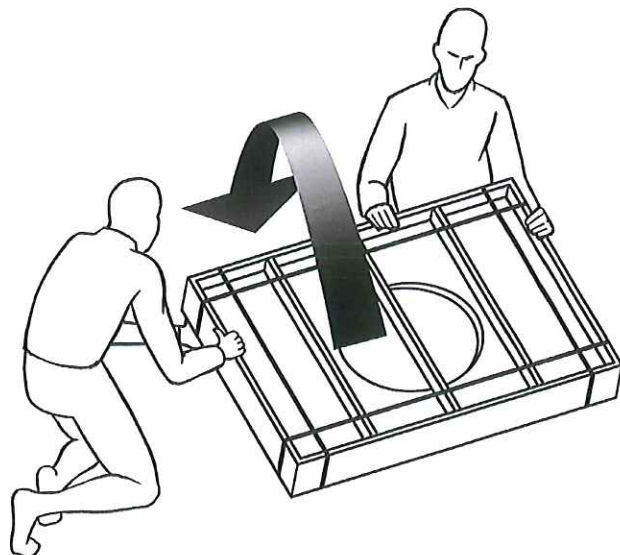

BOWEN WALL MOUNT FLOATING DOUBLE VANITY SINK ASSEMBLY INSTRUCTIONS

3. Remove metal bands.

4. Unscrew the slats or lid and remove.

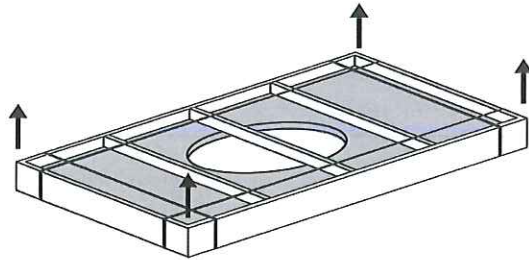

3. Examination of marble top

1. Examine the marble top for cracks or defects.

2. If defects are detected, please call 877-777-7059; do not install.

3. To clean the marble top, wipe with a soft cloth.

4. Installation of marble top

1. Always use a two man crew, a single person crew is much more likely to break or chip the marble top.

Double tops might require a 3 man crew.

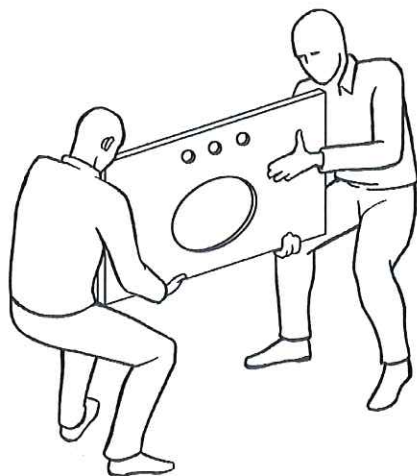

BOWEN WALL MOUNT FLOATING DOUBLE VANITY SINK ASSEMBLY INSTRUCTIONS



Caution! Installation between two walls requires special care.

2. Specific Instructions for installation between two walls

1. Set top on its edge at back of counter.
2. Lower the front of the marble top to the sink base, making sure both ends come down at the same rate.
3. Do not shimmy, twist or turn the top as you lower it. - risk of breakage!



If defects are detected please call 877-777-7059 - do not install.

BOWEN WALL MOUNT FLOATING DOUBLE VANITY SINK ASSEMBLY INSTRUCTIONS

Before You Begin:



Warning; this vanity must be installed into the wall studs.

Professional installation by three-person crew is required for this fixture. Install water supply and drain piping according to local plumbing and building codes. Insure that wall and floor are square and plumb at site of installation.

Materials Required:

1. Flat, nonabrasive work surface such as a blanket or smooth cardboard
2. Silicone

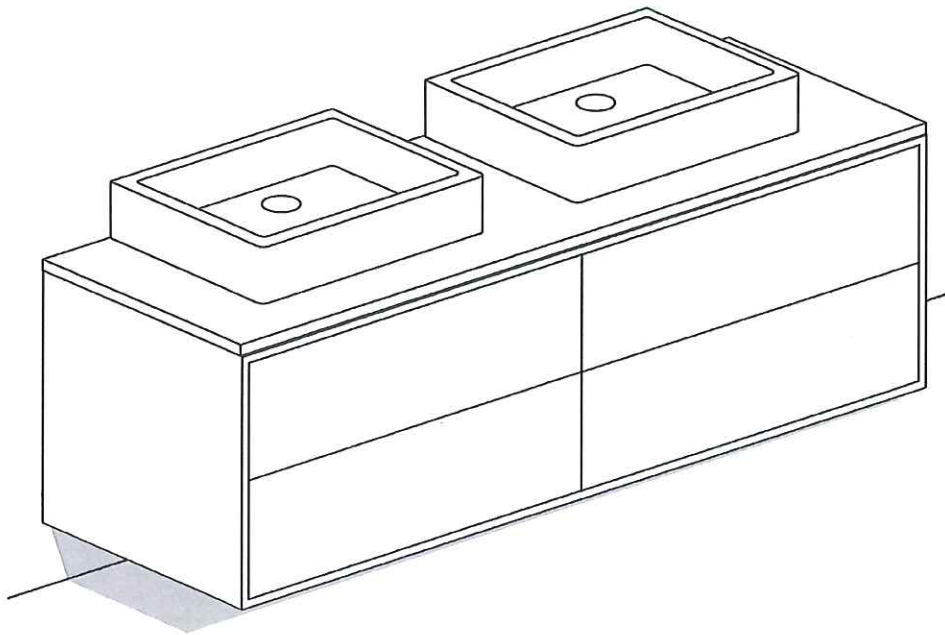

ASSEMBLED SINK

BOWEN WALL MOUNT FLOATING DOUBLE VANITY SINK ASSEMBLY INSTRUCTIONS

Parts List

A. Lavatory basin (x2)

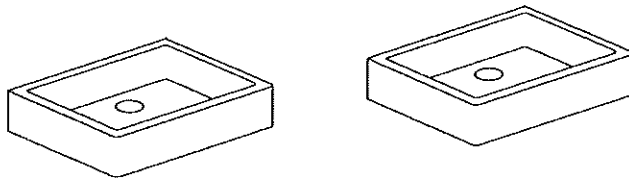

B. Stone top

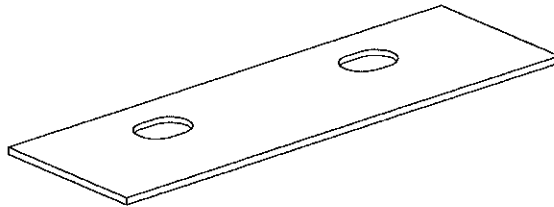

C. Vanity base

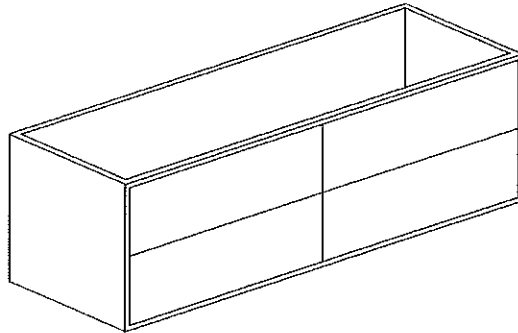

D. Hanger

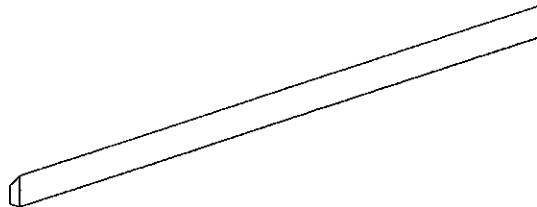

E. Lag Screws (x12)



F. Washers (x12)



BOWEN WALL MOUNT FLOATING DOUBLE VANITY SINK ASSEMBLY INSTRUCTIONS

Assembly Instructions:

1. Hold the wood hanger (D) against the wall. Adjust and mark the position using a pencil. The distance from bottom of the wood hanger to the floor is 23.75 inches. The wood hanger must cross four wall studs. The wood hanger must be level.
2. Mark the four screw holes on the wood hanger (D). Make sure the holes are in line with wall studs. Drill guide holes on each mark.
3. Use lag screws (E) and washers (F) to attach the wood hanger to the wall. Make sure the screws are secure in the studs.

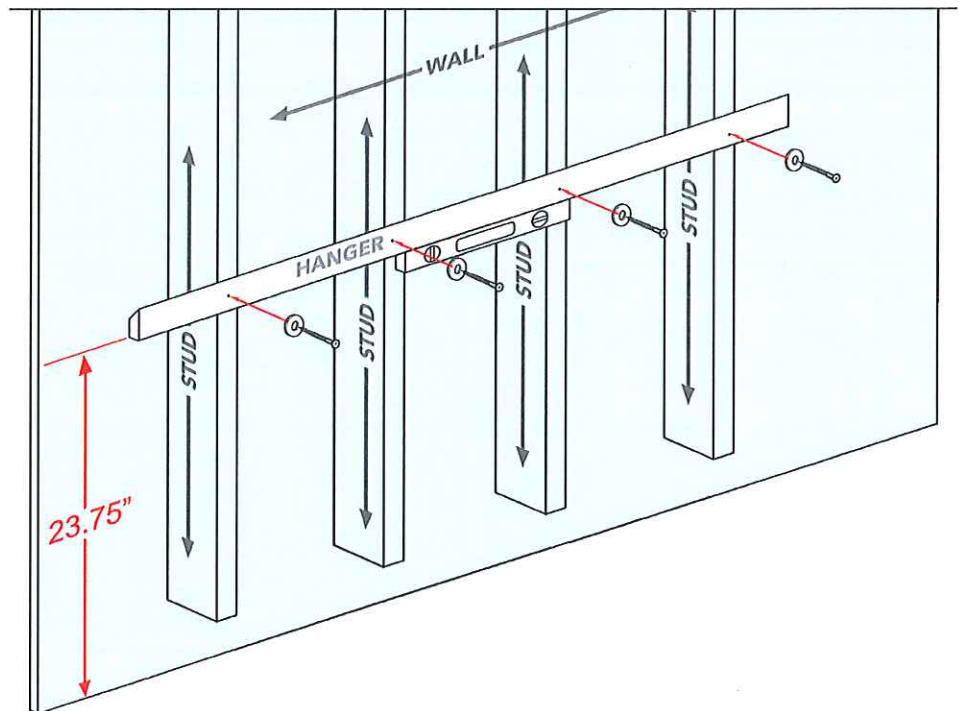
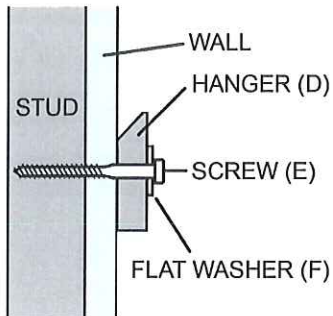

BOWEN WALL MOUNT FLOATING DOUBLE VANITY SINK ASSEMBLY INSTRUCTIONS

4. Remove drawers from vanity (C). Hang the vanity base on the wood hanger (D), holding the vanity in place with two people. Do not let the full weight of the vanity base sit on the wall hanger until the vanity base is also screwed into the studs.

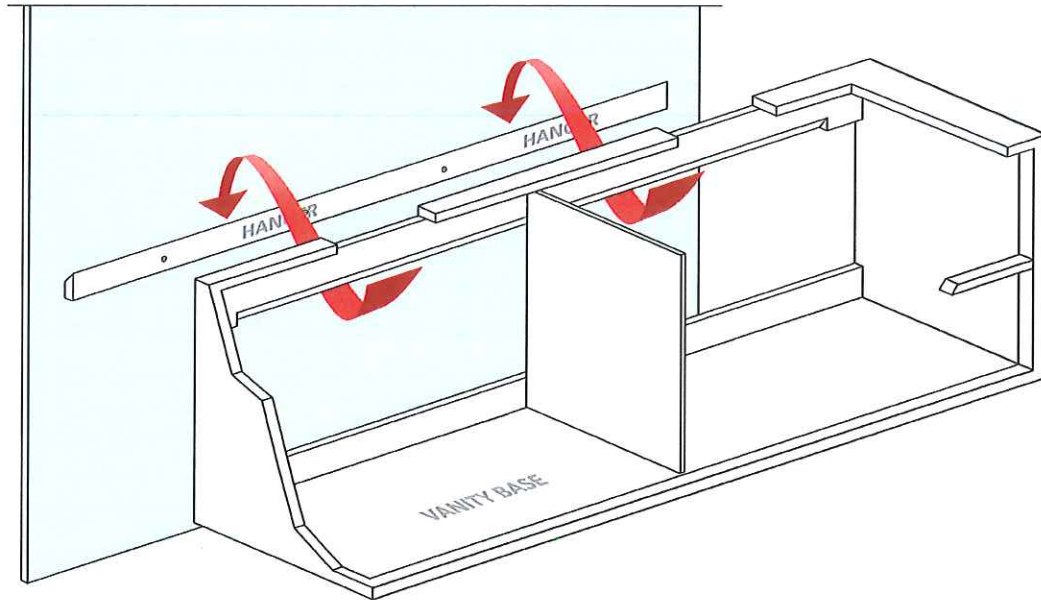

5. While two people hold the vanity base (C) in place, the third person marks screw placement in the top and bottom rails in the back of the vanity, making sure they are in line with the screws in the hanger and aligned with the studs. Then drill guide holes and secure vanity to the wall with lag screws (E) and washers (F).

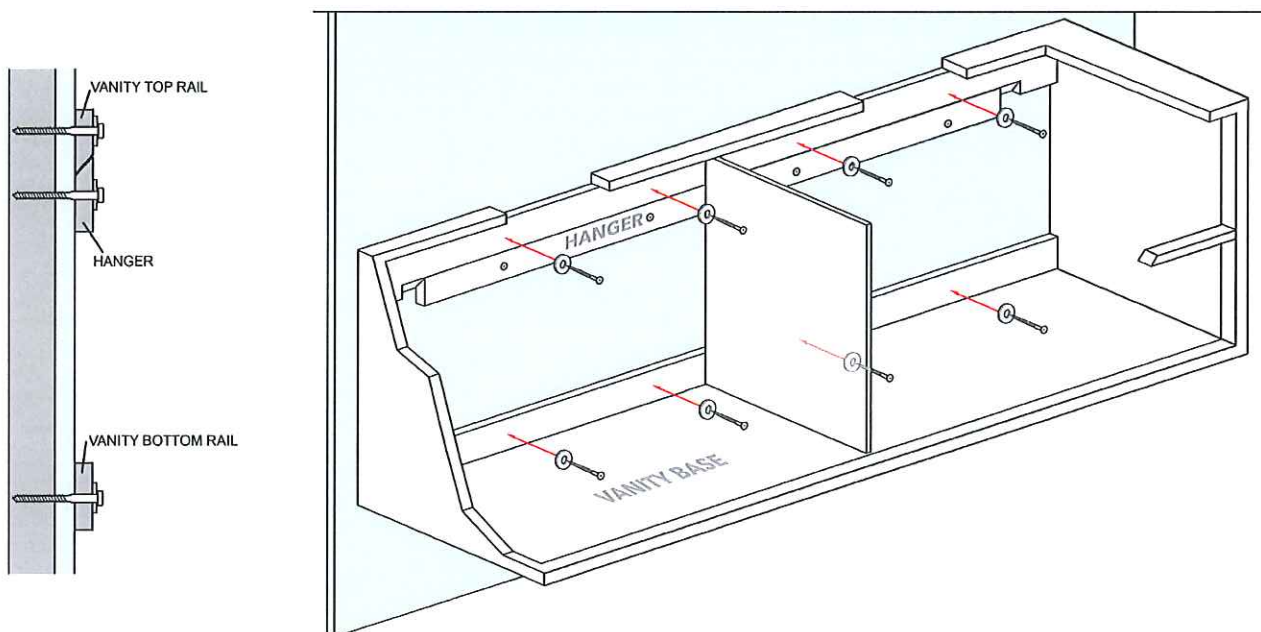

BOWEN WALL MOUNT FLOATING DOUBLE VANITY SINK ASSEMBLY INSTRUCTIONS

6. Gently place stone top (A) on the vanity (C).
7. Apply a continuous bead of silicone to the bottom surface of lavatory basins (B) where they contact top.
8. Place the basins (B) on the top. (C). (See Illustration)

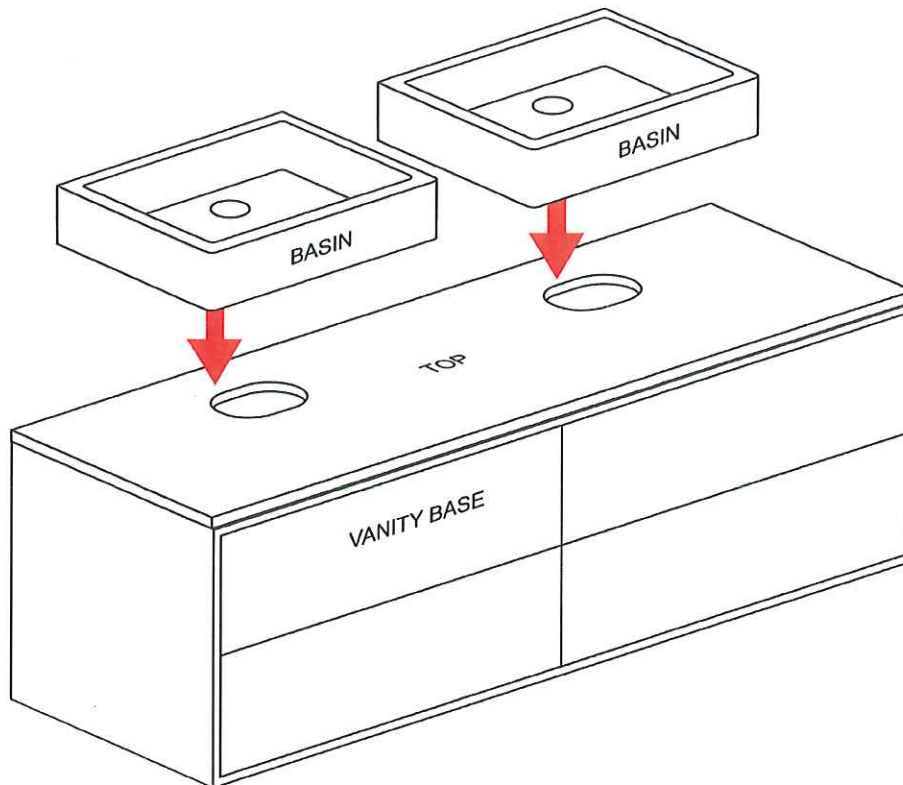

Cleaning and Maintenance Instructions:

Avoid abrasive and harsh chemical cleaners.

To maintain and protect luster of vanity sink components, Restoration Hardware Bathroom Cleaning Products are recommended.

Restoration Hardware natural stone tops have a honed finish and hand-polished edges. They are sealed twice before shipment with inert silicone sealant. For cleaning and maintenance, Restoration Hardware Stone Care Products are recommended. To maintain your natural stone top, reseal it once a year.

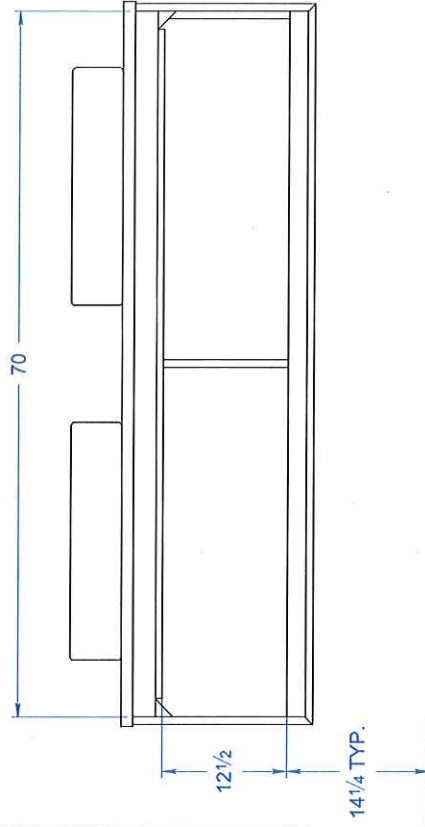
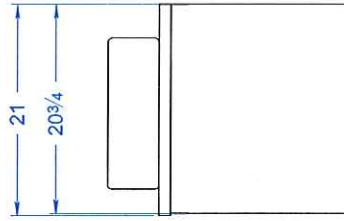
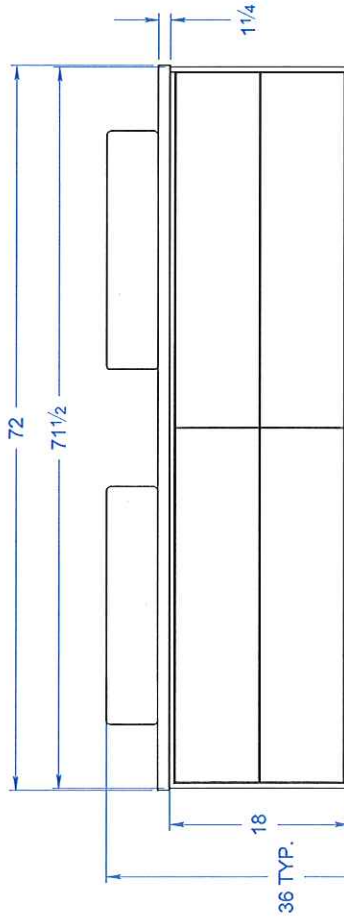
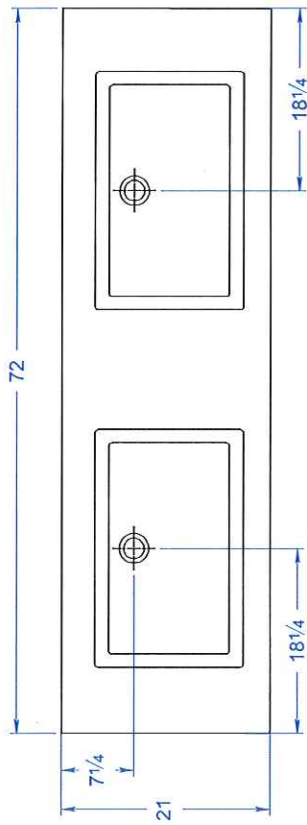

DURAVIT: LARGE WALL MOUNT VESSEL

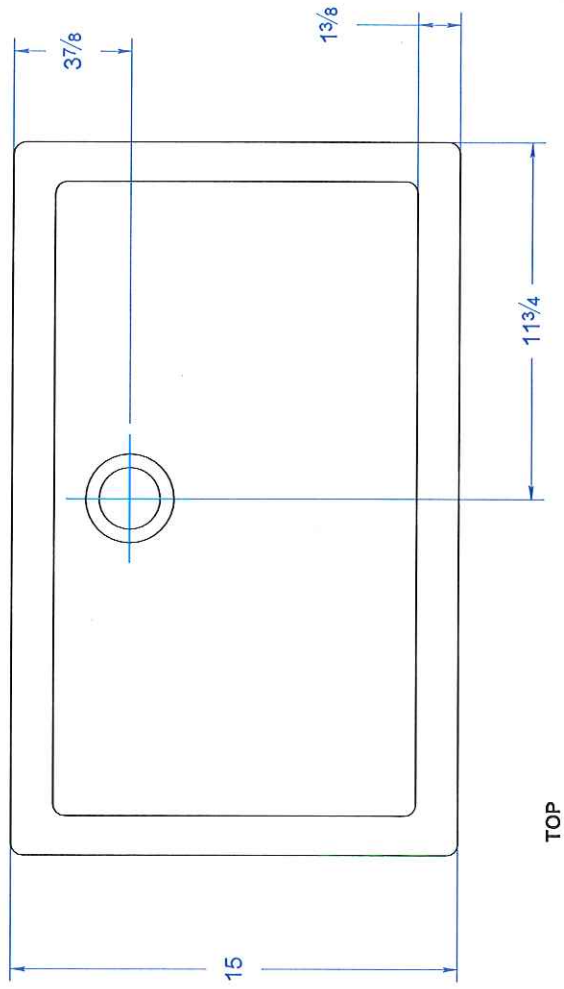

TOP

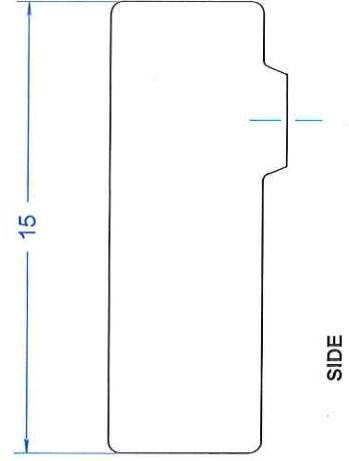

SIDE

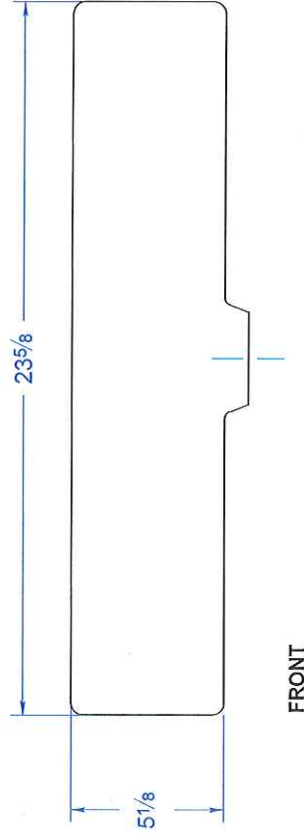

FRONT

DURAVIT: SMALL WALL MOUNT VESSEL

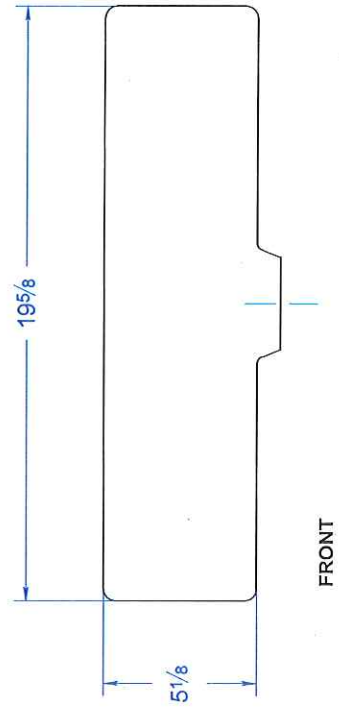
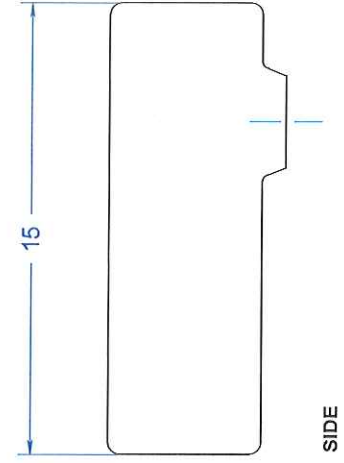
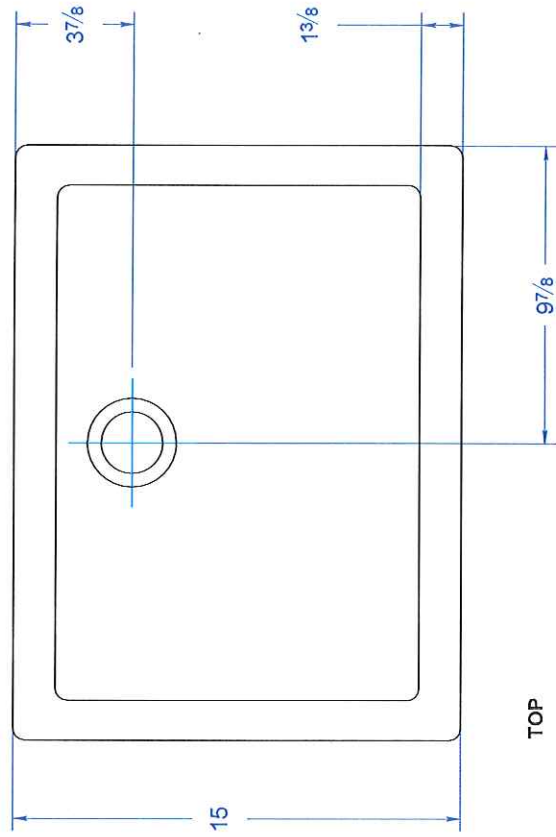

Washbowl # 0455600000

| < 23 5/8" Inch > |

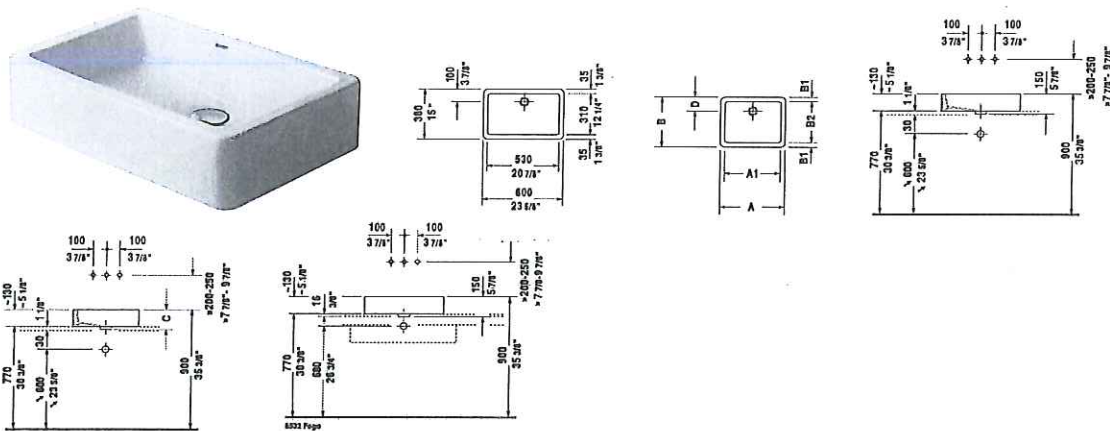

Washbowl	Dimension	Weight	Order number
ground, CUPC listed, without overflow, without tap platform, fixings included, 23 5/8" Inch			
Colors			
00 White			
Variant			
<input checked="" type="checkbox"/>	23 5/8" x 15" Inch	31.2 lb	0455600000
Sanitary ceramics with the special WonderGliss surface finish will remain clean and attractive-looking for a long time to come. When ordering WonderGliss please add a "1" as eleventh digit to the model number.			
Design Siphon		3.3 lb	005036
Slotted waste	2" Inch	0.7 lb	005024

All drawings contain the necessary measurements which are subject to standard tolerances. They are stated in inch & mm and are non-binding. Exact measurements, in particular for customized installation scenarios, can only be taken from the finished ceramic piece.

Washbowl # 045550..00

|< 19 5/8" Inch >|

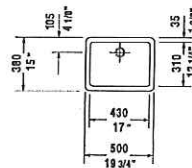
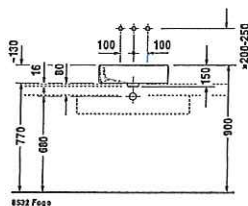
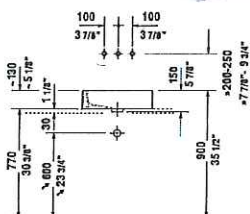

Washbowl	Dimension	Weight	Order number
ground, without overflow, without tap platform, fixings included, 19 5/8" Inch			
Colors			
00 White 08 Black			
Variant			
•	19 5/8" x 15" Inch		045550..00
Sanitary ceramics with the special WonderGliss surface finish will remain clean and attractive-looking for a long time to come. When ordering WonderGliss please add a "1" as eleventh digit to the model number.			
Design Siphon		3.3 lb	005036
Slotted waste	2" Inch	0.7 lb	005024

All drawings contain the necessary measurements which are subject to standard tolerances. They are stated in inch & mm and are non-binding. Exact measurements, in particular for customized installation scenarios, can only be taken from the finished ceramic piece.

Fogo

F0 8521

Montageanleitung

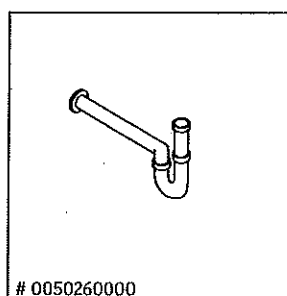
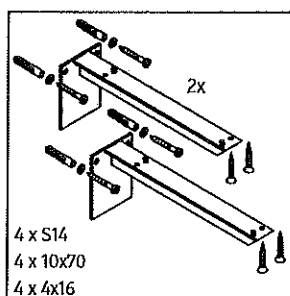
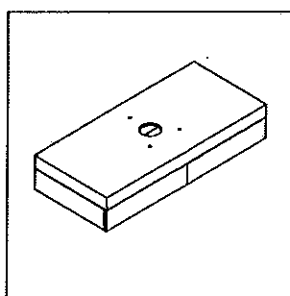
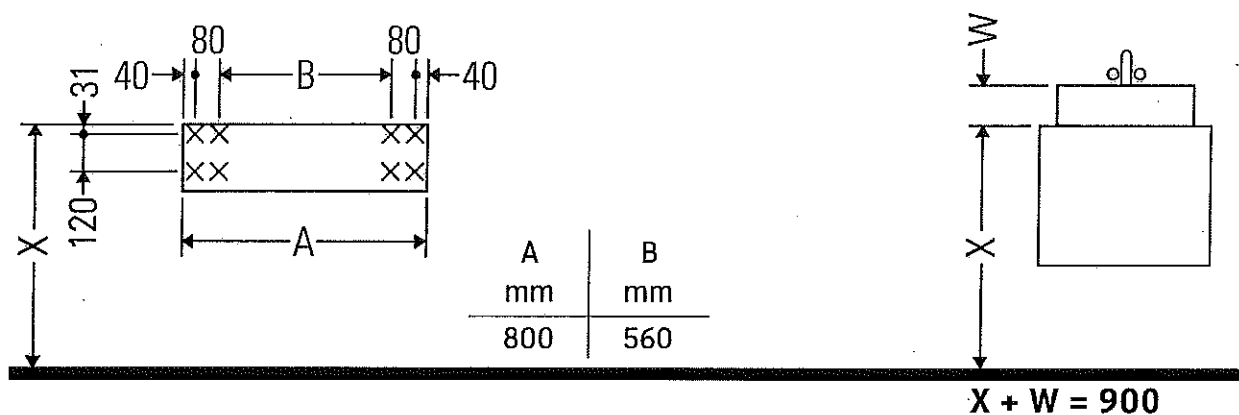

Verwendungshinweise

Die Badmöbelserie entspricht den gültigen Normen und Richtlinien zum Zeitpunkt der Auslieferung und ist für den Einsatz in Bädern konzipiert. Eine direkte Benetzung mit Wasser z. B. beim Duschen ist zu vermeiden. Keramiken breiter als 600 mm müssen an der Wand befestigt werden. Technische Verbesserungen und optische Veränderungen an den abgebildeten Produkten behalten wir uns vor.

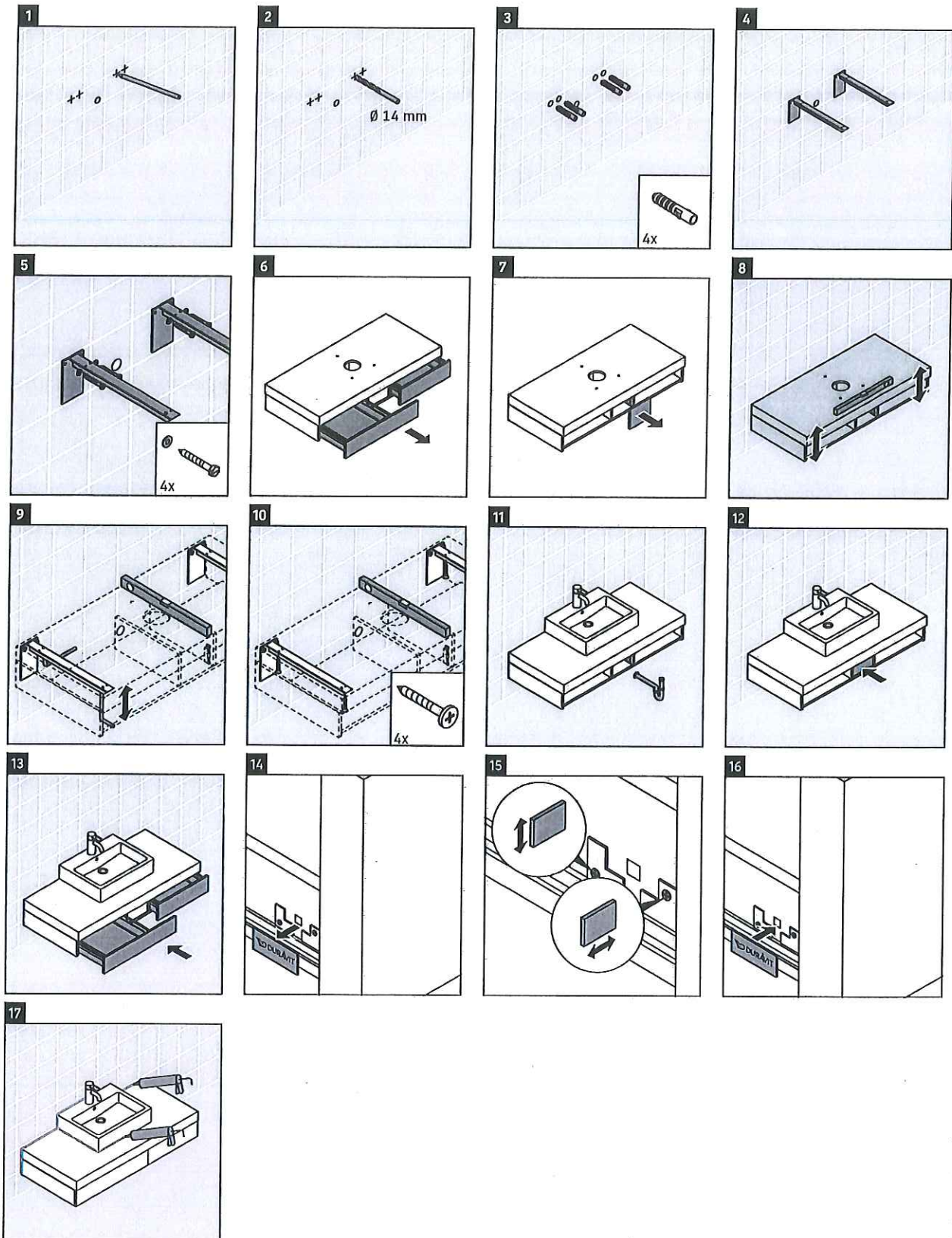

P4