

RH

POWELL BATH SCONCE

PARTS ENCLOSED:

- (A) Glass Shade (1)
- (B) Backplate (1)
- (C) Backplate Screws (2)
- (D) Wire Nuts (2)
- (E) Mounting Plate Screws (2)
- (F) Mounting Plate (1)
- (G) Optional Adapter Plate (1)
- (H) Mollies (2)

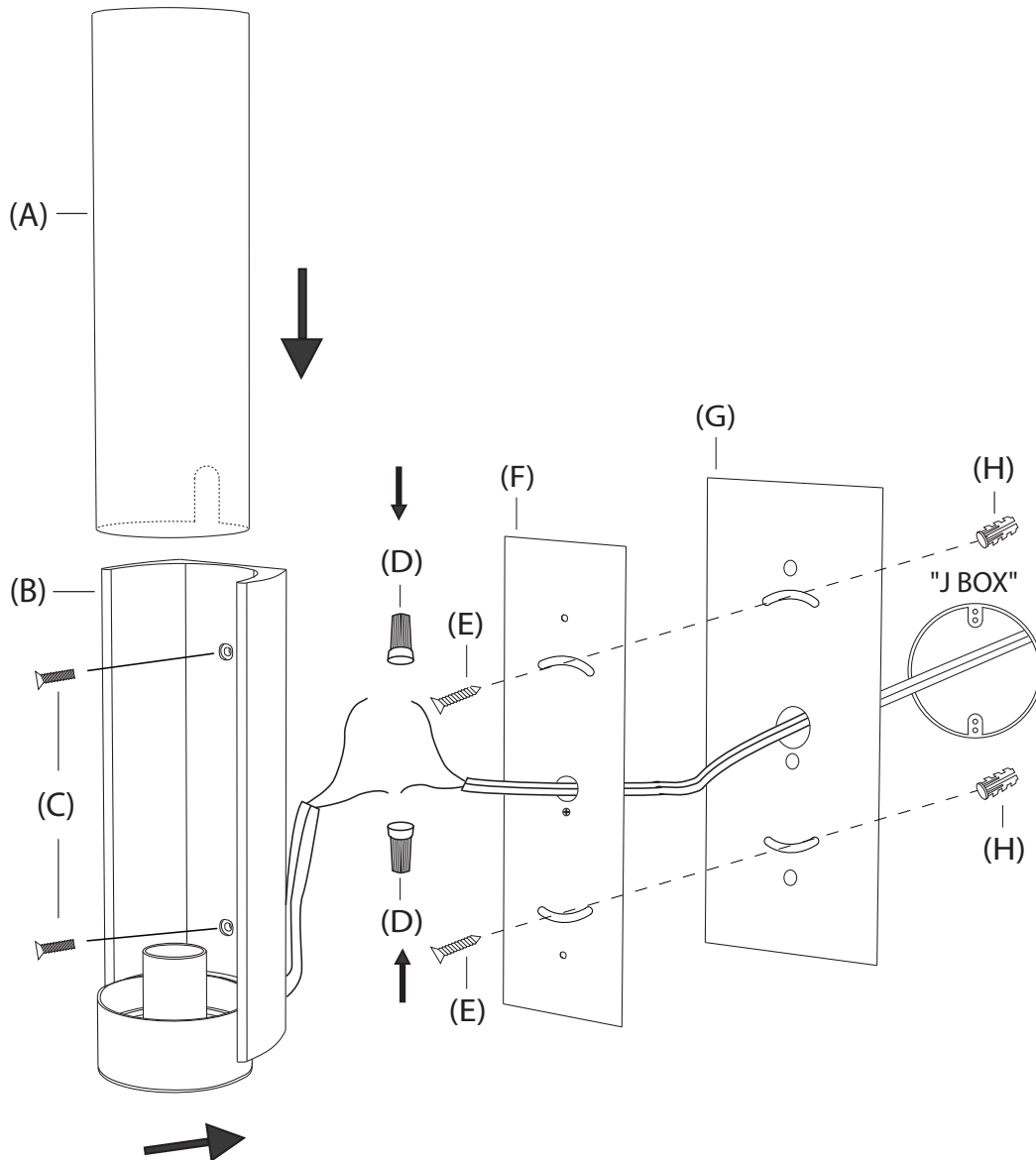

IMPORTANT PLEASE READ**WE RECOMMEND INSTALLATION BY A LICENSED ELECTRICIAN.****SAFETY INSTRUCTIONS:**

These instructions are provided for your safety. It is very important that they are read completely before beginning the installation of your fixture.

This fixture has been rated for up to one (1) 60-watt maximum Type A medium base bulb or one (1) 7.5-watt LED medium base bulb. To avoid risk of fire, do not exceed the recommended wattage.

If any special control devices are used with this fixture, follow the instructions carefully to assure full compliance with N.E.C. requirements. If there are any questions, contact a qualified electrical contractor.

WARNINGS:

All wires are connected. When unpacking, be careful not to pull wires as a bad connection may result. Do not connect electricity until your fixture is fully assembled. To reduce the risk of fire, electrical shock or personal injury, always turn off fixture and allow it to cool prior to replacing the lightbulb. Do not touch bulb when fixture is turned on or look directly at lit bulb. Keep flammable materials away from the lit bulb.

This lighting fixture contains lead, a chemical known to the State of California to cause cancer, birth defects and other reproductive harm. Wash hands after installing, handling, cleaning, or otherwise touching this light fixture.

 **WARNING:** This product can expose you to lead, which is known to the State of California to cause cancer and birth defects or other reproductive harm. For more information, go to www.P65Warnings.ca.gov.

THIS IS NOT A TOY AND THE PRODUCT HAS NO PLAY VALUE.

 **WARNING: STRANGULATION HAZARD**

Keep cord at least 3 ft away from cribs, bassinets, and toddler beds. Keep out of reach of children under 3.

ASSEMBLY & INSTALLATION:

SHUT OFF MAIN ELECTRICAL SUPPLY FROM THE MAIN FUSE BOX/ CIRCUIT BREAKER.

1. Remove all parts carefully from the box.
2. Remove backplate screws (C) from backplate (B).
3. Remove mounting plate (F) from backplate (B).
4. Determine if adapter plate (G) is needed to cover your outlet box. Adapter plate is necessary to cover a standard "J BOX". If using a smaller outlet box, optional adapter plate (G) is not necessary.
5. Guide wiring from outlet box through center hole in optional adapter plate (G) (if necessary) and mounting plate (F). Affix optional adapter plate (G) (if necessary) and mounting plate (F) to sheet rock above and below outlet box with screws (E) and molliers (H) provided.
6. Connect the ground (green) wire from outlet box to ground screw on mounting plate (F). Connect white or rough side of wire from fixture to white wire from outlet box using wire nuts (D). Connect black or smooth side of wire from fixture to black wire from outlet box using wire nuts (D).
7. Align holes in backplate (B) with screw holes in mounting plate (F) and optional adapter plate (G) (if necessary). Place backplate (B) over mounting plate (F) and optional adapter plate (G) (if necessary). Thread backplate screws (C) through backplate (B) and into mounting plate (D) to secure fixture to wall.
8. Install one (1) 60-watt maximum Type A medium base bulb or one (1) 7.5-watt LED medium base bulb.
9. Align channel in glass shade (A) with wiring tube from socket at the bottom of backplate (B). Slide glass shade (A) down circular opening at the bottom of backplate (B) until glass shade (A) rests on the bottom of backplate (B).

CARE INSTRUCTIONS:

Wipe clean with a soft, dry cloth or static duster. Always avoid the use of harsh chemicals or abrasive cleaners as they may cause damage to the fixture's finish.