

## ALSACE ARCHITECTURAL RAILING SCONCE

## PARTS ENCLOSED

- (A) Mounting Plate (1)
- (B) Mounting Screws (2)
- (C) Fixture Base (1)
- (D) Base Screws (3)
- (E) Upper Rod (1)
- (F) Socket Rings (2)
- (G) Sockets (2)
- (H) Lamp Pole (1)
- (J) Inner Rod (1)
- (K) Lower Pole (1)
- (L) Lower Base (1)
- (M) Finial (1)
- (N) Plastic Anchor (1)
- (O) Set Screw (1)
- (P) Washer (1)

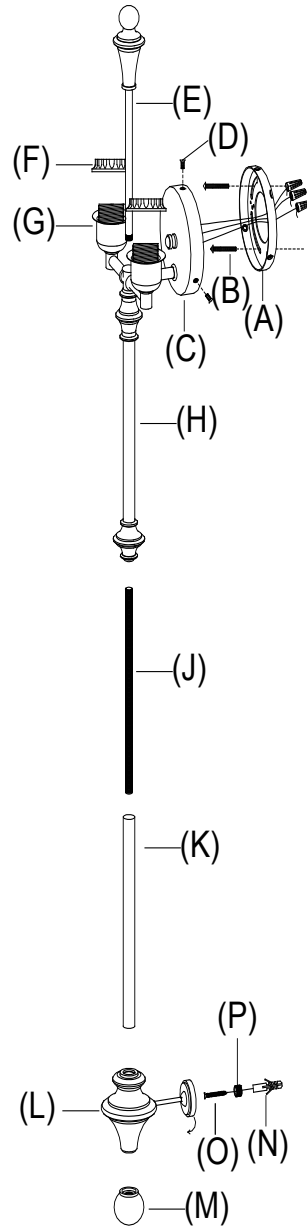

**IMPORTANT SAFETY INSTRUCTIONS**

INSTALLATION BY A LICENSED ELECTRICIAN IS STRONGLY RECOMMENDED.

This fixture has been rated for two (2) 40-Watt maximum Type A bulb (not included) OR two (2) 9-Watt Compact Fluorescent light bulbs (not included). To avoid the risk of fire, do not exceed the recommended wattage.

**WARNINGS**

All wires are connected. When unpacking, be careful not to pull wires, as a bad connection may result. Do not connect electricity until your fixture is fully assembled. To reduce the risk of fire, electrical shock, or personal injury, always turn off fixture and allow it to cool prior to replacing the light bulb. Do not touch or look directly at the bulb when fixture is illuminated. Keep flammable materials away from lit bulb.



**WARNING:** This product can expose you to lead, which is known to the State of California to cause cancer and birth defects or other reproductive harm. For more information, go to [www.P65Warnings.ca.gov](http://www.P65Warnings.ca.gov).

**THIS IS NOT A TOY AND THE PRODUCT HAS NO PLAY VALUE.**

**WARNING: STRANGULATION HAZARD**

Keep cord at least 3 ft away from cribs, bassinets, and toddler beds. Keep out of reach of children under 3.

**ASSEMBLY & INSTALLATION**

SHUT OFF THE MAIN ELECTRICAL SUPPLY FROM THE FUSE BOX OR CIRCUIT BREAKER PANEL.

1. Carefully remove all parts from the box and remove all plastic covering.
2. Thread Upper Rod (E) into the center hole in between of the Sockets (G).
3. Thread Inner Pole (J) into the bottom threaded opening of Pole (H).

**ASSEMBLY & INSTALLATION CONT.**

4. Slide Lower Pole (K) over the Inner Rod (J), follow with (L), and screw Finial (M) onto the end of (J) to secure (L) and (K) to (H). Make sure the bottom plate of (L) is at the same direction with (C).
5. Remove Mounting Plate (A) from Fixture Base (C) by removing Base Screws (D).
6. Affix Mounting Plate (A) to wall outlet box with Mounting Screws (B) provided.
7. Place Fixture Base (C) onto the Mounting Plate (A). Make sure the whole fixture base is vertical; mark the outline of bottom plate of (L) on the wall. Remove the light fixture.
8. Drill small hole on the center point of the marked circle on the wall. The hole should be large enough to accommodate the Plastic Anchor (N). Push Plastic Anchor (N) into the hole on the wall.
9. Insert Screw (O) and Washer (P) to Plastic Anchor (N); make sure screw head 1/8 threads are visible.
10. Attach the fixture ground wire (GREEN) to the ground wire from the outlet box (usually green or bare wire) with a plastic wire connector and wrap the connection with electrical tape.
11. Connect the neutral wire (WHITE) to the neutral outlet wire (usually white) with a plastic wire connector and wrap the connection with electrical tape.
12. Connect the hot wire (BLACK) to the hot outlet box wire (usually black) with a plastic wire connector and wrap the connection with electrical tape.
13. Attach Fixture Base (C) to Mounting Plate (A) and tighten with Base Screws (D).
14. Thread the bottom plate of (L) to Washer (P).
15. Remove Socket Rings (F) from top of Sockets (G). Attach lamp shades (not included) to the Threaded Sockets (G) and secure with Socket Rings (F).
16. Insert the recommended bulbs into Sockets (G).
17. Restore power to outlet box and check operation of fixture.

**CARE INSTRUCTIONS**

Do not use polishes or cleaners on your lamp. Just wipe clean with a soft cloth.