

RESTORATION HARDWARE

RESTORATION HARDWARE

Customer Service
1-800-816-0901



Style # 26100040
Mini River Rock Fire Bowl

⚠️ WARNINGS ⚠️

Read entire label and all instructions included with gel fuel and fire bowl
PROPERTY DAMAGE, SERIOUS INJURY OR DEATH may result if these warnings are not followed

HAZARDS

- Gel fuel is flammable. Failure to follow warnings can result in property damage or serious burns.
- Do not attempt to pour gel or any other fuel on a fire that is already burning. Flare-ups or flashbacks can occur if you do. Allow unit to cool for 20 minutes before refueling or removing cans of fuel.
- Use only Real Flame® Gel fuel in this unit. Do not use with any other gel fuel or flammable material. Do not attempt to refill cans of gel fuel.
- Do not store or use gasoline or other flammable materials, including gel fuel, near this product. Vapors from these types of items may collect and increase the risk of fire, explosion or injury.
- In case of an emergency use a CO2 extinguisher or baking soda to extinguish the fire.

1. Burn only Real Flame® 7oz Gel Cans in the fire bowl. Never burn trash, paper, or wood in the unit.
2. Fire bowl is not to be operated by anyone below age 18. Keep away from children and pets.
3. Make sure fire bowl is placed on a flat and level surface. Failure to do so could cause the unit to tip, resulting in serious injury, property damage or death.
4. Do not place fire bowl in an area with lots of traffic, such as a hallway or entryway.
5. WARNING: Never alter or dismantle The Real Flame® Fire Bowl in any manner.
6. Never burn gel fuel cans outside the designated burn area.
7. Do not burn more than the specified amount of fuel at any time. Do not try to combine gel from different cans.
8. Never leave a burning fire unattended, especially around children or pets.
9. Never touch any metal surfaces during or immediately after burning gel fuel. They will be extremely HOT. Allow surfaces to cool for 20 minutes before touching surfaces, changing cans, or moving the unit.
10. Do not wear flammable or loose clothing when operating the fire bowl.
11. Exercise the same precautions as you would with any open fire.
12. DEATH, SERIOUS INJURY OR PROPERTY DAMAGE may result if these warning are not followed correctly.

NOTICE: Buyer assumes all responsibility for safety and use that is not in accordance with these instructions and warnings.

Using your Fire Column

- Unit is for indoor or outdoor use.
- Before using unit, be sure you have read and understood the step-by-step instructions.
- During the initial burn you may experience a slight odor. Odor is temporary and will be absent on following burns.

GEL FUEL CANS

Real Flame Gel Fuel contains isopropyl alcohol. Avoid contact with eyes, mucous membranes or prolonged contact with skin. May irritate eyes. Store in a cool, dry place. Keep away from flame, heat or items that spark. Use in well-ventilated areas. Keep out of reach of children and pets. In case of fire, use a CO2 fire extinguisher or baking soda.

FIRST AID

If gel gets in eyes, flush with water for 15 minutes; get medical attention. If ingested, do not induce vomiting; call poison control center at 1-800-222-1222 or a doctor.

If you have questions please call customer service at 1-800-654-1704

Care and Cleaning

A damp rag and mild soap can be used to clean the body of the fire bowl.

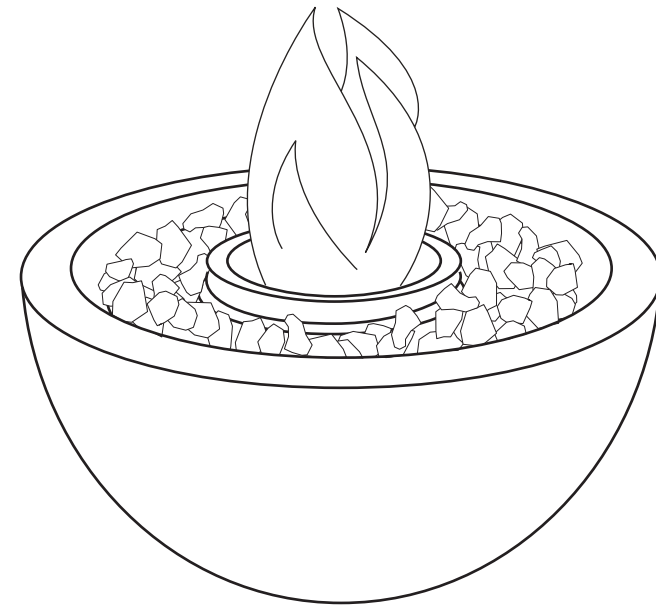

RF Fire Bowl WARNINGS 020612

Step Three

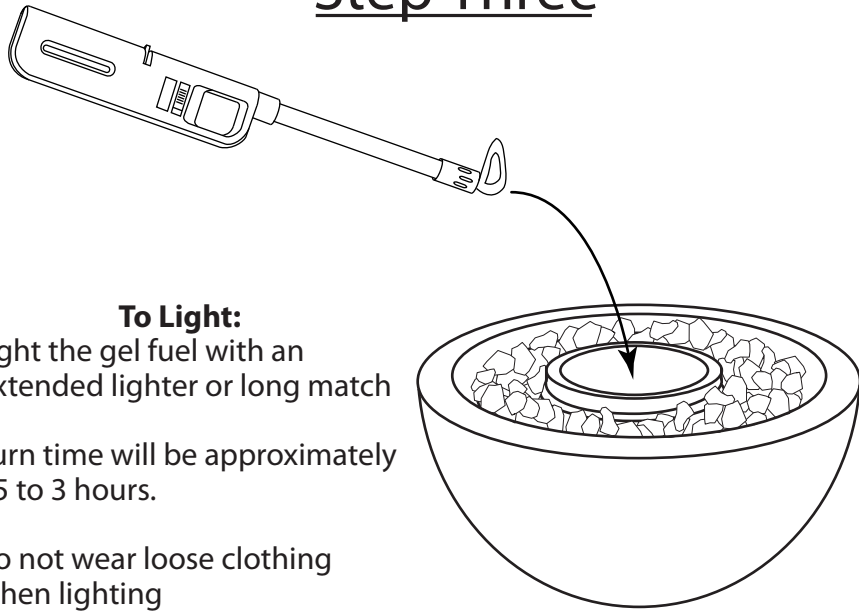

To Light:

- Light the gel fuel with an extended lighter or long match
- Burn time will be approximately 2.5 to 3 hours.
- Do not wear loose clothing when lighting

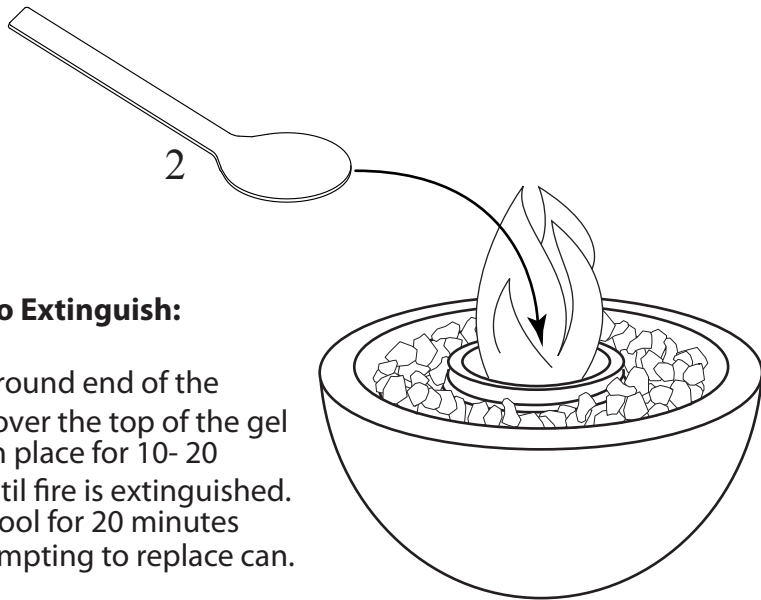

To Extinguish:

- Place the round end of the snuffer (2) over the top of the gel can. Hold in place for 10- 20 seconds until fire is extinguished.
- Allow to cool for 20 minutes before attempting to replace can.

CAN WILL BE EXTREMELY HOT

Parts List

Number	Description	Part Number	Quantity
1	Fire Bowl	05252901	1
2	Snuffer	05402401	1
3	River Rock	05653407	1 Bag

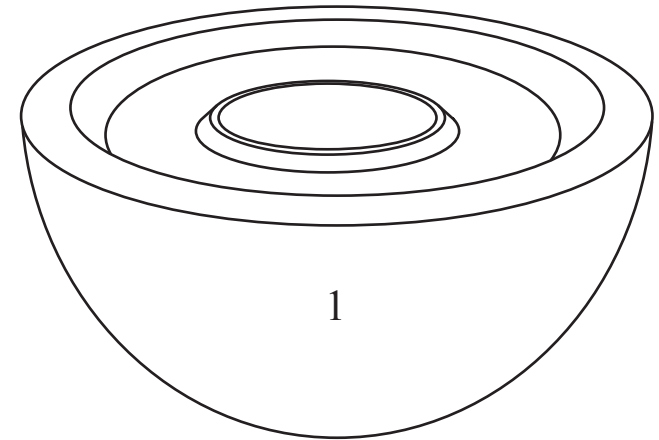
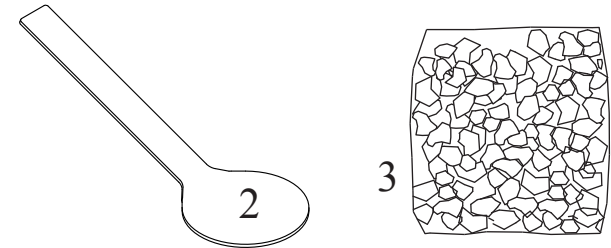

Step One

Spread the river rock evenly in the area around the recess in the center of the bowl.

Any rocks that fall into the recess must be removed before placing a gel can into the unit.

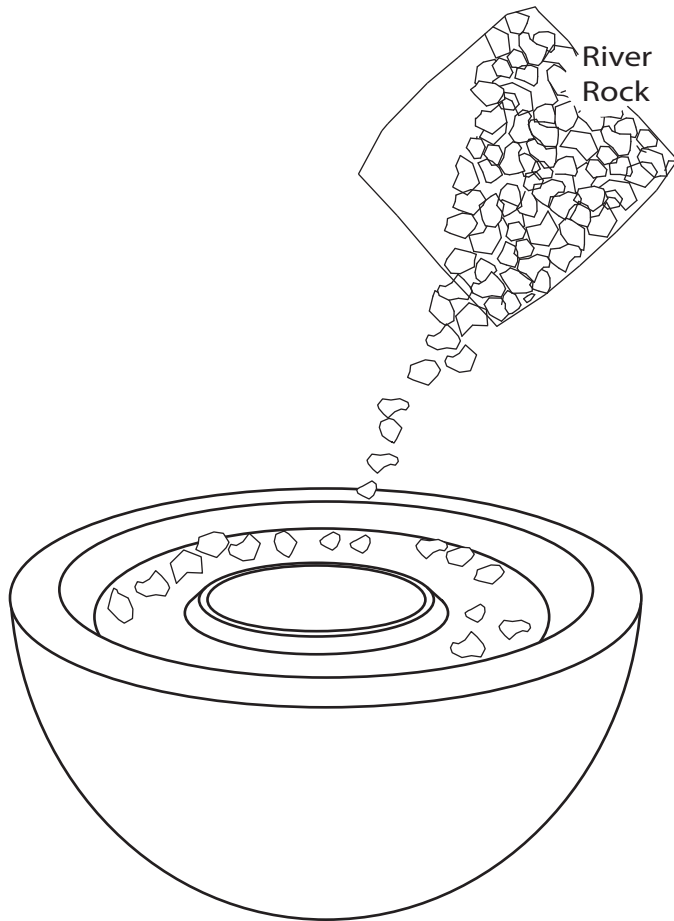

Step Two

Place one Real Flame® 7 oz. Junior gel can into the recess in the center of the burner.

WARNING: RISK OF EXPLOSION

- Do not attempt to pour gel on a fire that is already burning.
- Unit is designed to be used with Real Flame 7oz. Gel fuel can only. Do not use with any other gel fuel or flammable material.
- Do not attempt to refill Gel can. Can is intended for single use only.
- Do not store or use gasoline or other flammable materials, including gel fuel, near this product. Vapors from these types of items may collect and increase the risk of fire, explosion or injury.
- In case of an emergency use a CO2 extinguisher or baking soda to extinguish the fire.

