

PLEASE FOLLOW THE ASSEMBLY INSTRUCTIONS CLOSELY. IMPROPER ASSEMBLY CAN RESULT IN PERSONAL OR PROPERTY DAMAGE. IF YOU ARE UNSURE ABOUT YOUR CEILING TYPE OR WHAT MOUNTING METHOD YOU SHOULD USE, CONSULT A QUALIFIED PROFESSIONAL OR YOUR LOCAL HARDWARE STORE.



THIS LIGHTING FIXTURE WORKS WITH ELV DIMMERS ONLY. CONNECTING IT TO TRIAC DIMMERS MAY DAMAGE THE ELECTRICAL INSTALLATION. SEE RECOMMENDED DIMMERS ON THE LEFT BELOW

PARTS ENCLOSED:

- (A) Main arm lever [1]
- (B) Arm tip wing screw [1]
- (C) Glass Globe [1]
- (D) 1.6W LED G4 bulb [1]

TOOLS ENCLOSED:

Pair of cotton gloves

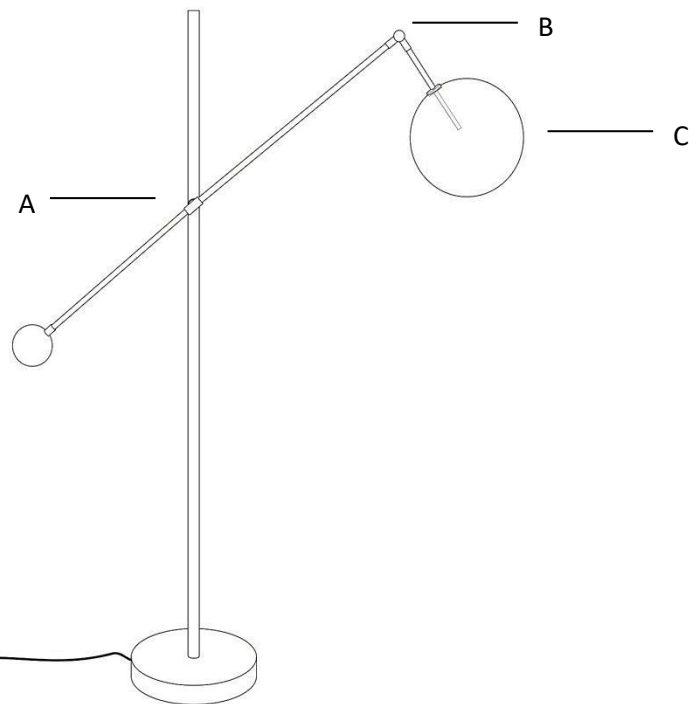

1st CHOICE RECOMMENDED DIMMERS
REQUIRING NEUTRAL WIRE

1. Lutron Skylark SELV-300P
2. Lutron Maestro MA-PRO-WH 250W
3. Lutron Diva DVELV-300P-WH

2nd CHOICE RECOMMENDED DIMMERS
NOT REQUIRING NEUTRAL WIRE

1. Lutron Ariadni AYCL-153P
2. Lutron Ariadni AYL-603P
3. Lutron Ariadni AYL-600P
4. Lutron Diva DVCL-153P

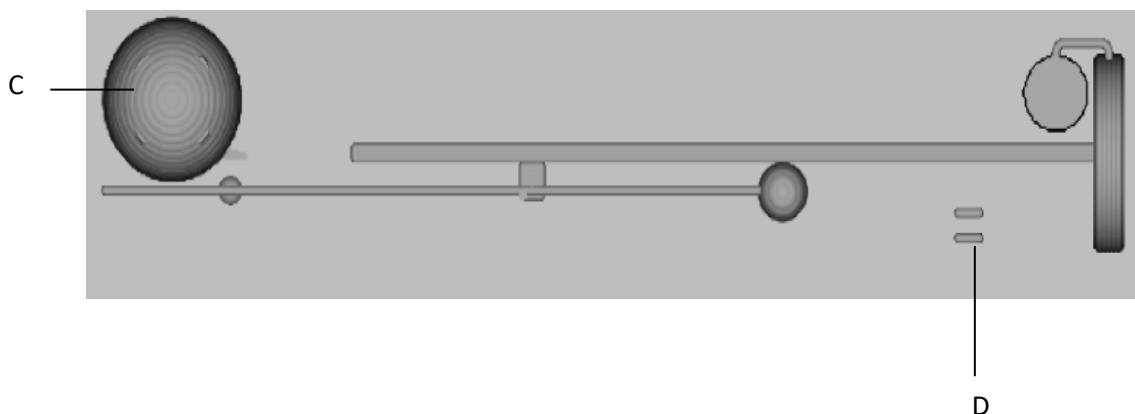

SAFETY INSTRUCTIONS:

These instructions are provided for your safety. It is very important that they are read completely before beginning the installation of your fixture.

1. This portable luminaire has a polarized plug (one blade is wider than the other) as a feature to reduce the risk of electric shock. This plug will fit on a polarized outlet only one way. If the plug does not fit fully in the outlet, reverse the plug. If it still does not fit, contact a qualified electrician. Never use with an extension cord unless plug can be fully inserted. Do not alter the plug.
2. This fixture has been rated for up to one (1) 1.6W max, 12V G4 base, LED bulbs. To avoid the risk of fire, do not exceed the recommended wattage.
3. If any special control devices are used with this fixture, follow the instructions carefully to assure full compliance with the N.E.C requirements.
4. This fixture can be used together with a trailing edge dimmer.
5. If there are any questions, contact a licensed electrical contractor.

WARNINGS:

- Do not mount or unmount the glass globes if the lightbulbs or fixture is hot.
- All wires are connected. Do not remove the ceiling light from its packaging by pulling on the power cord, as a bad connection may result.
- Do not use if the light cable / cord is damaged.
- To reduce the risk of fire, electrical shock, or personal injury, always turn off light fixture and allow it and the cloches to cool prior to replacing lightbulb.
- When mounting the fixture, always use included white gloves.
- Do not touch bulb when fixture is turned on. Do not look directly at lit bulb.
- Keep flammable materials away from lit bulb.

CLEANING AND MAINTENANCE

NOTE: Make sure you cut off electrical supply to the lamp before commencing cleaning operations.

Component	Maintenance	Tools
Brass frame	Clean every month using a soft cloth, dampened slightly with water. Make sure the frame is dry before switching it back on.	Soft cloth, water
Glass globes	Clean regularly with a soft dry cloth. Clean only the outside of the globe. When dirtier, use a wet cloth first. Grease can be cleaned with a gentle glass cleaner.	Soft cloth Cotton gloves
LED bulbs	Make sure your power supply is off before changing the bulb. Unscrew the globe where bulb needs replacing. Gently remove the bulb by pulling it out and replace with an LED bulb of the same parameters.	Cotton gloves LED bulbs

NOTE: Please remember solid brass may tarnish over time. This is a natural process. Make sure you follow our guidelines to preserve the great look of RH lighting for years.

TROUBLESHOOTING

NOTE: The handmade nature of the products offers a unique aesthetic experience and allows for small imperfections, which is inherent in crafts. If solutions offered below are not sufficient, please do not hesitate and contact our customer service.

Problem	Possible cause	Action
Tarnishing	Oxidation of brass is a natural process. Although it is lacquered, its color may change slightly over time.	No action is necessary apart from regular cleaning. See the Maintenance section.
Noise	The humming noise normally comes from transformers.	Check electrical connections and make sure the right dimmer is used - ELV.
Globe deformations	Mouth-formed glass globes are beautiful but not perfect. The process leaves a slight deformation at the bottom of the globe.	No action is necessary. All globes undergo a quality check. Should you have any doubts, please send us a photo of the deformed globe and we will act accordingly.



MAKE SURE YOU CUT OFF ELECTRICAL SUPPLY AT THE MAIN FUSE BOX/CIRCUIT BREAKER BEFORE COMMENCING ANY WORK

1

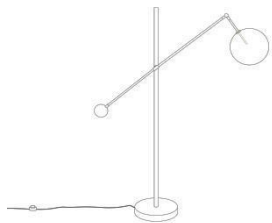

Carefully unpack the lamp and put it in the desired location.

2

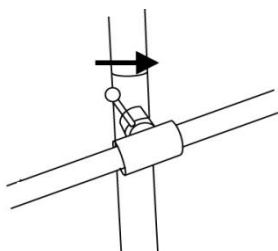

Set the arm angle and secure it with the interlocking lever [A]. **NOTE: Do not force the lever otherwise you may break the lock.**

3

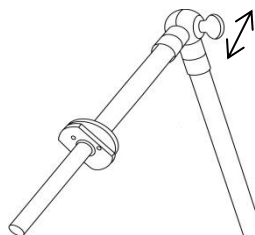

Set the tip of the arm at a 90 degree angle and secure the position with a wing screw. **NOTE: Do not force the wing screw otherwise you may break the thread.**

4

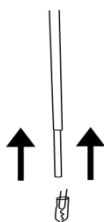

Carefully insert 1 included 1.6W LED G4 bulb into the slot on the tip of the arm.

5

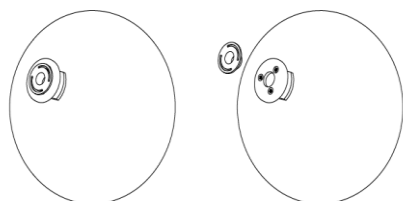

NOTE: Included cotton gloves MUST be worn when handling glass globes. Start mounting glass globe by first removing a plastic stopper from the globe to be mounted.

6

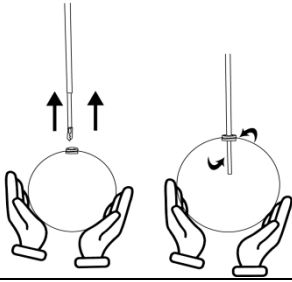

Carefully mount each globe onto the arm tip and screw it on.

7

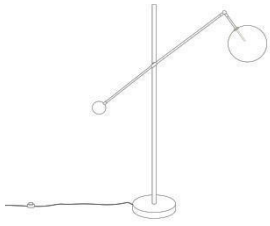

The lamp is ready to be connected to power supply.