

VILLENEUVE SOLID BRASS WINDOW HARDWARE INSTALLATION INSTRUCTIONS

TOOLS REQUIRED FOR INSTALLATION (NOT PROVIDED)

Installation on Wood Molding or Wood Studs

- Screwdriver, level, tape measure, pencil, power drill and 1/4" (6.5mm) drill bit.

Installation on Wallboard

- Screwdriver, level, tape measure, pencil, power drill and self-drilling anchors.

Installation in Concrete, Stone, Brick or Tile

- Screwdriver, level, tape measure, pencil, masonry drill, appropriate anchors, plugs or screws.

Installation in Drywall

- Installation instructions included with the anchor in separate hardware pack.

GETTING STARTED

- Remove hardware from the packaging. Do not dispose of package until the installation is complete.
- Read through the instructions entirely before starting.
- Measure the required width. The enclosed connector screw is used to join two lengths of pole and fits inside them.
- Ensure all parts indicated on packaging are present, plus 4 screws per bracket and an Allen wrench.
- Ensure all tools and all necessary supplementary hardware are on hand before starting.

ASSEMBLY INSTALLATION

- Determine the appropriate location for the rod. It is recommended that the outside brackets be installed a minimum of 2.5" (7cm) above the window. If the length of the rods exceeds 60", one center bracket is necessary. If the length of the rods exceeds 120", two center brackets are necessary. All the brackets need to be installed at the same level. (See Fig.1)
The height of the rod should be calculated by:
 - Measuring the length of the drapery panel.
 - Considering use of rings or rod pocket.
 - Deciding if you want excess drapery on the floor, hem of drapery touching the floor or hem hanging slightly above the floor.
- Mark the appropriate location of each bracket with a pencil. Predrill the screw holes using a 1/4" (6.5mm) drill bit. End bracket is installed by first removing the cover plate from the top of the bracket using the included Allen wrench to loosen the flathead set-screw. Then mount the bracket on the wall at the desired height. After securely installing the first bracket, place the rod in the bracket, and extend rod to the location of the second bracket. Using a level, determine proper height of second bracket to ensure the rod will be installed level. Mark the height and install the second bracket. (See Fig 2, 3 & 4.)
- If drapery is rod pocket, feed the drapery onto the rod through the drapery's pocket, and then place the rod into the brackets. If using rings, place the rings on rod before hanging drapery. Once the rod is in the brackets, attach the end cap finials on both ends of the rod. If using rings, one ring should rest between the bracket and finial on each end. The finials should rest outside the bracket. (See Fig 4, 5 & 6.)
- Use the included Allen wrench to tighten the set-screws at the top of the bracket to hold the rod in place. Then inset the end cap finial into rods, affix the finial to the rods using included Allen wrench. (See Fig 4 & 5.)

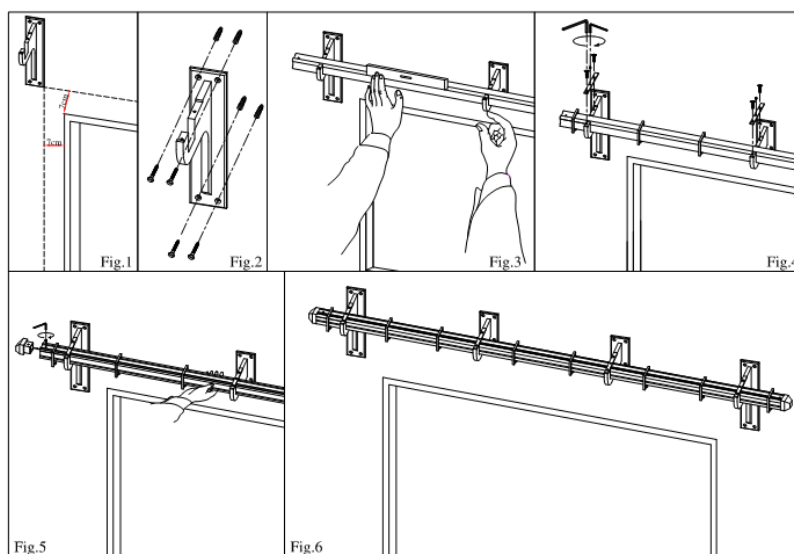

IMPORTANT:

It is highly recommended that the bracket be attached to a structural wood support, such as moulding around the window, or wooden studs within the walls. The enclosed screws are designed for that purpose. If the studs within the wall are metal, you must predrill into the metal stud and use sheet metal screws.



VILLENEUVE SOLID BRASS ROD CONNECTOR ASSEMBLY INSTRUCTIONS

ASSEMBLY INSTRUCTIONS

The enclosed connector should be used if you need to connect two or more rods. Please follow the steps below to assemble the rods.

1. Insert the connector into the rod, and then tighten the set-screw with a Phillips-head screwdriver.
2. Insert the connector into the second rod, and then tighten the set-screw with a Phillips-head screwdriver.

