

PARTS ENCLOSED

- (A) Wire Nuts (3)
- (B) Metal Anchors (4)
- (C) Mounting Plate (1)
- (D) Side Screws (2)
- (E) Screws (4)
- (F) Mounting Screws (2)
- (G) Fixture (1)
- (H) Rubber Washer (2)

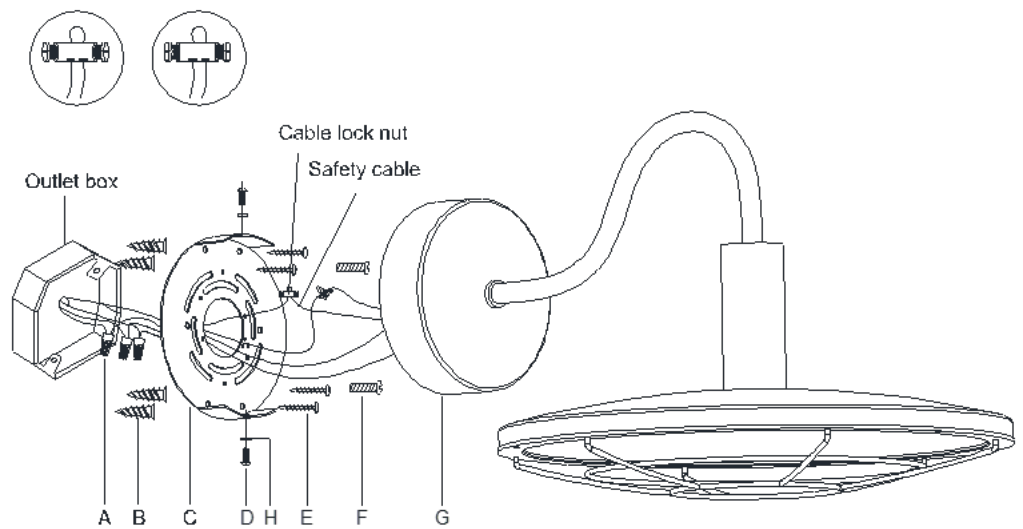

IMPORTANT SAFETY INSTRUCTIONS

INSTALLATION BY A LICENSED ELECTRICIAN IS STRONGLY RECOMMENDED.

WARNINGS

All wires are connected. When unpacking, be careful not to pull wires, as a bad connection may result. Do not connect electricity until your fixture is fully assembled. To reduce the risk of fire, electrical shock, or personal injury, always turn off fixture and allow it to cool prior to replacing the light bulb. Do not touch or look directly at the bulb when fixture is illuminated. Keep flammable materials away from lit bulb.



WARNING: This product can expose you to lead, which is known to the State of California to cause cancer and birth defects or other reproductive harm. For more information, go to www.P65Warnings.ca.gov.

THIS IS NOT A TOY AND THE PRODUCT HAS NO PLAY VALUE.



WARNING: STRANGULATION HAZARD

Keep cord at least 3 ft away from cribs, bassinets, and toddler beds. Keep out of reach of children under 3.

ASSEMBLY & INSTALLATION

SHUT OFF THE MAIN ELECTRICAL SUPPLY FROM THE FUSE BOX OR CIRCUIT BREAKER PANEL.

1. Carefully remove all parts from the box.
2. Remove the Mounting Plate (C) from Fixture (G) by loosening Side Screws (D).
3. Drill 4 holes on the wall and make sure the hole distance will match to the holes on the Mounting Plate (C).
4. Knock the Metal Anchors (B) into the wall holes.
5. Affix Mounting Plate (C) onto the outlet box and secure with Mounting Screws (F). Secure the Screws (E) to the Metal Anchors (B).
6. Join fixture safety cable with safety cable from wall.
7. Wrap both safety cables around the cable lock nut.
8. Insert screws into both holes on cable lock nut and secure screws with screwdriver.
9. Push the cable lock nut into the wall box.
10. Connect the hot wire (BLACK) from the fixture to the hot wire from the outlet box (usually black). Fasten them together with a Wire Nut (A) provided and wrap the connection with electrical tape.
11. Connect the neutral wire (WHITE) from the fixture to the neutral wire from the outlet box (usually white). DO NOT REVERSE THE HOT AND NEUTRAL CONNECTIONS; OTHERWISE, SAFETY WILL BE COMPROMISED.
12. Connect the ground wire (bare copper) from the fixture to the ground wire from the outlet box (usually green or copper in color). IT IS IMPERATIVE THAT THIS FIXTURE BE GROUNDED.
13. Attach Fixture (E) to the Mounting Plate (C); then secure with Rubber Washer (H) and Side Screws (D).
14. Installation is complete. Turn on power at fuse or circuit breaker.

CARE INSTRUCTIONS

Do not use polishes or cleaners on your lamp. Just wipe clean with a soft cloth.