

## GRAHAM PENDANT 16"

### PARTS ENCLOSED

- (A) Wire Nuts (3)
- (B) Side Screws (4)
- (C) Mounting Plate (1)
- (D) Mounting Screws (2)
- (E) Driver (1)
- (F) Bracket (1)
- (G) Screw (1)
- (H) Connector (1)
- (I) Canopy (1)
- (J) Tubes (6", 12", 18")
- (K) Lock Collar (1)
- (L) Tubes (6", 12", 18")
- (M) Fixture Body (1)
- (N) Wrench (1)
- (O) Plastic Sleeve (1)

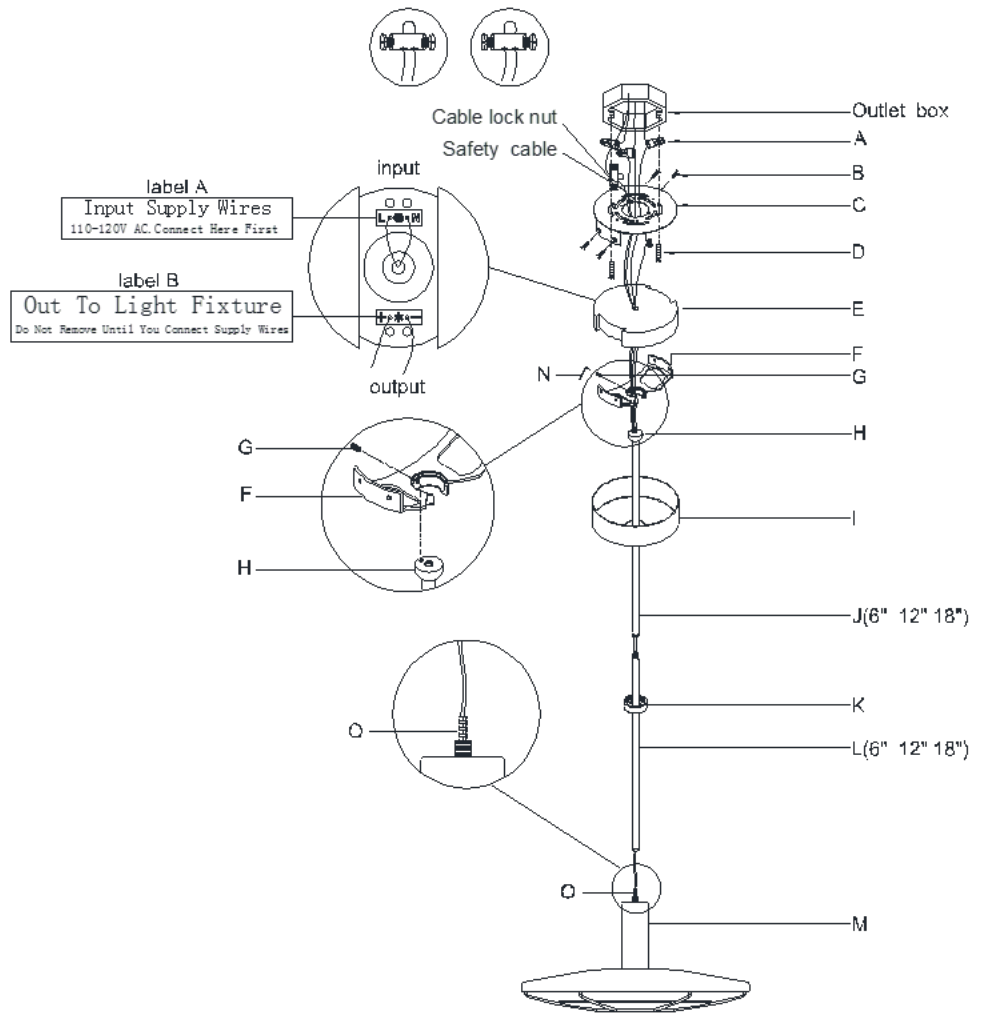

**IMPORTANT SAFETY INSTRUCTIONS**

INSTALLATION BY A LICENSED ELECTRICIAN IS STRONGLY RECOMMENDED.

**WARNINGS**

All wires are connected. When unpacking, be careful not to pull wires, as a bad connection may result. Do not connect electricity until your fixture is fully assembled. To reduce the risk of fire, electrical shock, or personal injury, always turn off fixture and allow it to cool prior to replacing the light bulb. Do not touch or look directly at the bulb when fixture is illuminated. Keep flammable materials away from lit bulb.



**WARNING:** This product can expose you to lead, which is known to the State of California to cause cancer and birth defects or other reproductive harm. For more information, go to [www.P65Warnings.ca.gov](http://www.P65Warnings.ca.gov).

**THIS IS NOT A TOY AND THE PRODUCT HAS NO PLAY VALUE.**



**WARNING: STRANGULATION HAZARD**

Keep cord at least 3 ft away from cribs, bassinets, and toddler beds. Keep out of reach of children under 3.

**ASSEMBLY & INSTALLATION**

SHUT OFF THE MAIN ELECTRICAL SUPPLY FROM THE FUSE BOX OR CIRCUIT BREAKER PANEL.

1. Carefully remove all parts from the box. Then remove the Plastic Sleeve (O) on the top of the Fixture Body (M) before assembling.
2. Remove the Canopy (I) from the Bracket (F) by loosening Lock Collar (K).
3. Remove the Mounting Plate (C) from the Bracket (F) by loosening Side Screws (B).
4. Affix Mounting Plate (C) onto the outlet box and secure with Mounting Screws (D).

**ASSEMBLY & INSTALLATION CONT.**

5. Connect outlet box ground wire to the green grounding screw on Mounting Plate (C). IT IS IMPERATIVE THAT THIS FIXTURE BE GROUNDED.
6. Let the fixture wire pass through the Tube (L), Lock Collar (K), Tube (J) and Canopy (I).
7. Thread the Tube (L) to the Fixture Body (M); then thread the Tube (J) to the Tube (L).
8. Attach the Bracket (F) to the Connector (H). Secure the Screw (G) to the gap on the Connector (H) by using the Wrench (N).
9. Join fixture safety cable with safety cable from ceiling.
10. Wrap both safety cable around the cable lock nut.
11. Insert screws into both holes on cable lock nut and secure screws with screwdriver.
12. Push the cable lock nut into the ceiling box.
13. Tear off label A on the Driver (E). Insert the jump hot wire (smooth edge, marking) into hole (marked "L") on driver (E); then insert the jump neutral wire (ribbed, no marking) into hole (marked "N") on driver (E). Pass jump wire through Driver (E).
14. Connect the jump neutral wire (ribbed, no markings) with the neutral wire from the outlet box using Wire Nut (A).
15. Connect the jump hot wire (smooth edge, markings) with the hot wire from the outlet box using Wire Nut (A). DO NOT REVERSE THE HOT AND NEUTRAL CONNECTIONS; OTHERWISE, SAFETY WILL BE COMPROMISED.
16. Tuck these wire connections neatly into the outlet box to secure.
17. With assistance, raise assembled fixture body with bracket to Mounting Plate (C) and secure with Side Screws (B).
18. Tear off label B on the Driver (E). Insert the fixture hot wire (RED) into hole (marked "+") on Driver (E); then insert the fixture neutral wire (BLACK) into hole (marked "-") on driver. IT IS IMPORTANT TO NOT MIX THESE WIRES.
19. Attach Canopy (I) to the Bracket (F) and secure with Lock Collar (K).
20. Installation is complete.

**CARE INSTRUCTIONS**

Do not use polishes or cleaners on your lamp. Just wipe clean with a soft cloth.