

RESTORATION HARDWARE

BENNER LARGE WALL SCONCE

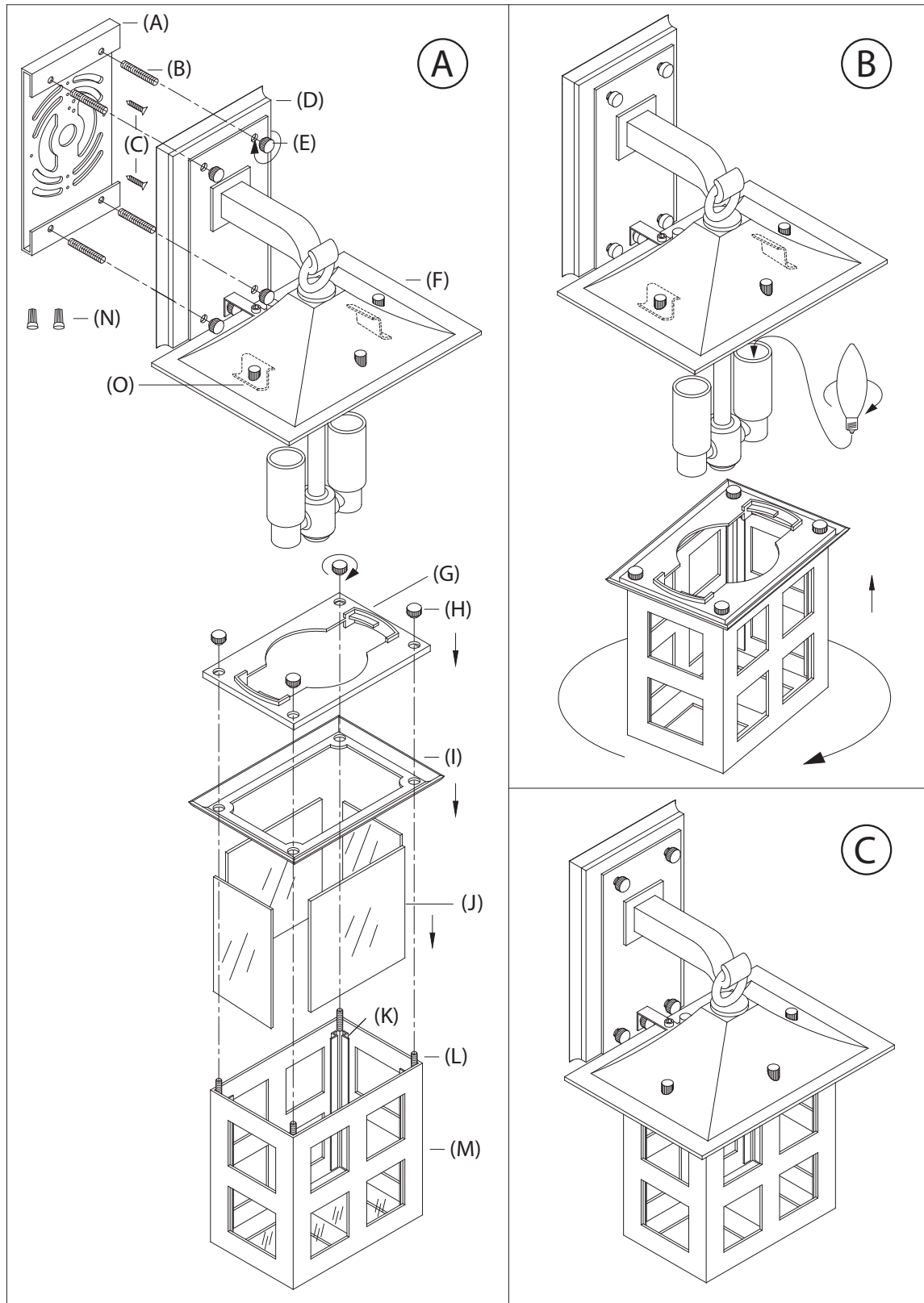

RESTORATION HARDWARE

Thank you for purchasing Restoration Hardware Lighting. Our assortment is crafted with the highest quality details in mind: cast sockets, full range dimmers, and hand applied finishes. Each item's surface is sealed which eliminates the need for polishing and ensures the lasting brilliance of your piece for years to come.

PARTS ENCLOSED:

- (A) MOUNTING PLATE
- (B) BACKPLATE ALIGNMENT SCREWS (X4)
- (C) MOUNTING PLATE SCREWS (X2)
- (D) BACKPLATE
- (E) BACKPLATE NUTS (X4)
- (F) LANTERN CANOPY
- (G) ALIGNMENT CAP
- (H) LANTERN NUTS (X4)
- (I) LANTERN CAP
- (J) GLASS PANELS (X4)
- (K) CHANNELS FOR GLASS PANELS
- (L) LANTERN ALIGNMENT SCREWS (X4)
- (M) LANTERN BODY
- (N) WIRE NUTS
- (O) LANTERN TABS

BENNER LARGE WALL SCONCE

IMPORTANT SAFETY INSTRUCTIONS:

*These instructions are provided for your safety. It is very important that they are read completely before beginning the installation of your fixture.

*DIRECT WIRE FIXTURES: WE STRONGLY RECOMMEND INSTALLATION BY A LICENSED ELECTRICIAN.

WARNINGS:

Turn off power (unplug from the wall outlet) before replacing the bulb(s), making sure the bulb(s) had sufficient time to cool down. DO NOT subject the fixture to any shock while lit as shattering of bulb may result.

DIRECT WIRE ASSEMBLY INSTRUCTIONS

1. SHUT OFF THE MAIN ELECTRICAL SUPPLY FROM THE MAIN FUSE BOX/ CIRCUIT BREAKER.
2. Remove mounting plate (A) from backplate (D) by removing backplate nuts (E), and backplate alignment screws (B). Guide wiring from outlet box through center hole in mounting plate (A).
3. Affix mounting plate (A) to the outlet box using mounting plate screws (C).
4. Thread backplate screws (B) into holes in backplate (A).
5. Lift backplate (D) to mounting plate (A) and make proper electrical connection.
6. Connect the copper wire from fixture to ground (green) wire from outlet box. Connect white or rough side of wire from fixture to white wire from outlet box, fasten together with plastic wire nuts (N), and tightly wrap with electrical tape. Connect black or smooth side of wire from fixture to black wire from outlet box; fasten together with plastic wire nuts (N), and tightly wrap with electrical tape.
7. Align holes in backplate (D) with backplate screws (B). Slide backplate (D) over backplate screws (B), and mounting plate (A). Backplate (D) should be flush against wall. Thread backplate nuts (E) onto exposed threads of backplate screws (B) to secure fixture to mounting plate (A).
8. Place lantern (M) on level surface.
9. Un-thread lantern nuts (H), and set aside. Remove alignment cap (G), and lantern cap (I) from lantern alignment screws (L), and set aside.
10. Carefully slide glass panels (J) into channels (K), making sure numbers on glass panels (J) go into corresponding sides in lantern (M). CAUTION: UTILITY GLOVES SHOULD BE WORN WHEN HANDLING GLASS PANELS.
11. Align holes in lantern cap (I) with lantern alignment screws (L). Slide lantern cap (I) over lantern alignment screws (L).
12. Align holes in alignment cap (G) with lantern alignment screws (L). Make sure alignment cap (G) is positioned as shown in figure A. Slide alignment cap (G) over lantern alignment screws (L).
13. Thread lantern nuts (H) onto exposed threads of lantern alignment screws (L).
14. Install two (2) Type B, 60 watt maximum bulb in to sockets.
15. Align assembled lantern (M) with tabs (O) on bottom of lantern canopy (F). Slide lantern over tabs (O) on bottom of lantern canopy (F). NOTE: tabs will fit into opening of alignment cap (G). Twist lantern as shown in figure B to lock tabs (O) into place, securing lantern (M) to lantern canopy (F). Completed lantern assembly shown in figure C.

CARE INSTRUCTIONS:

To clean, use a soft cloth only. DO NOT use any chemical or abrasive cleaners.

RESTORATION HARDWARE

BENNER SMALL WALL SCONCE

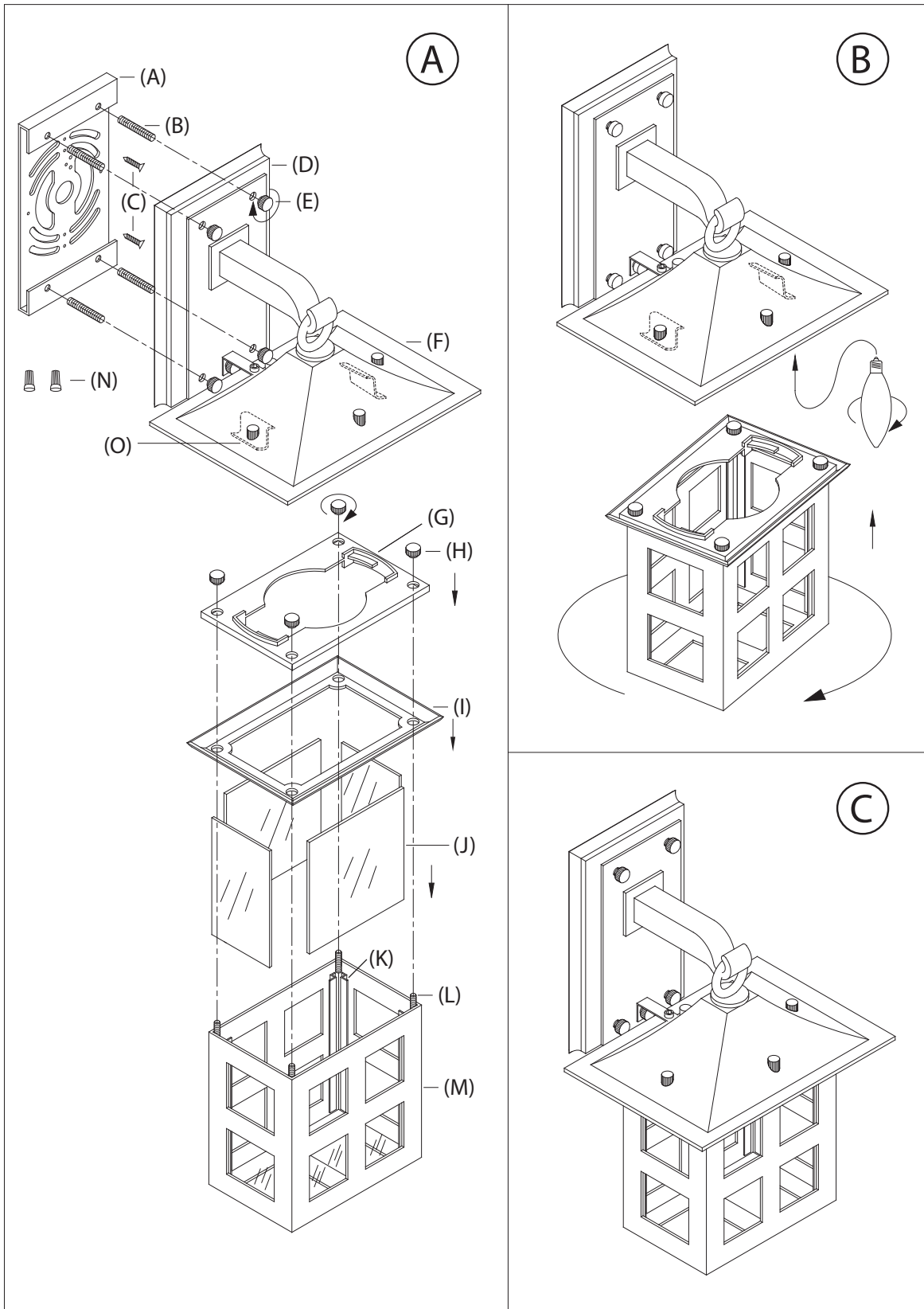

RESTORATION HARDWARE

Thank you for purchasing Restoration Hardware Lighting. Our assortment is crafted with the highest quality details in mind: cast sockets, full range dimmers, and hand applied finishes. Each item's surface is sealed which eliminates the need for polishing and ensures the lasting brilliance of your piece for years to come.

PARTS ENCLOSED:

- (A) MOUNTING PLATE
- (B) BACKPLATE ALIGNMENT SCREWS (X4)
- (C) MOUNTING PLATE SCREWS (X2)
- (D) BACKPLATE
- (E) BACKPLATE NUTS (X4)
- (F) LANTERN CANOPY
- (G) ALIGNMENT CAP
- (H) LANTERN NUTS (X4)
- (I) LANTERN CAP
- (J) GLASS PANELS (X4)
- (K) CHANNELS FOR GLASS PANELS
- (L) LANTERN ALIGNMENT SCREWS (X4)
- (M) LANTERN BODY
- (N) WIRE NUTS
- (O) LANTERN TABS

BENNER SMALL WALL SCONCE

IMPORTANT SAFETY INSTRUCTIONS:

*These instructions are provided for your safety. It is very important that they are read completely before beginning the installation of your fixture.

*DIRECT WIRE FIXTURES: WE STRONGLY RECOMMEND INSTALLATION BY A LICENSED ELECTRICIAN.

WARNINGS:

Turn off power (unplug from the wall outlet) before replacing the bulb(s), making sure the bulb(s) had sufficient time to cool down. DO NOT subject the fixture to any shock while lit as shattering of bulb may result.

DIRECT WIRE ASSEMBLY INSTRUCTIONS

1. SHUT OFF THE MAIN ELECTRICAL SUPPLY FROM THE MAIN FUSE BOX/ CIRCUIT BREAKER.
2. Remove mounting plate (A) from backplate (D) by removing backplate nuts (E), and backplate alignment screws (B). Guide wiring from outlet box through center hole in mounting plate (A).
3. Affix mounting plate (A) to the outlet box using mounting plate screws (C).
4. Thread backplate screws (B) into holes in backplate (A).
5. Lift backplate (D) to mounting plate (A) and make proper electrical connection.
6. Connect the copper wire from fixture to ground (green) wire from outlet box; Connect white or rough side of wire from fixture to white wire from outlet box, fasten together with plastic wire nuts (N), and tightly wrap with electrical tape. Connect black or smooth side of wire from fixture to black wire from outlet box; fasten together with plastic wire nuts (N), and tightly wrap with electrical tape.
7. Align holes in backplate (D) with backplate screws (B). Slide backplate (D) over backplate screws (B), and mounting plate (A). Backplate (D) should be flush against wall. Thread backplate nuts (E) onto exposed threads of backplate screws (B) to secure fixture to mounting plate (A).
8. Place lantern (M) on level surface.
9. Un-thread lantern nuts (H), and set aside. Remove alignment cap (G), and lantern cap (I) from lantern alignment screws (L), and set aside.
10. Carefully slide glass panels (J) into channels (K), making sure numbers on glass panels (J) go into corresponding sides in lantern (M). CAUTION: UTILITY GLOVES SHOULD BE WORN WHEN HANDLING GLASS PANELS.
11. Align holes in lantern cap (I) with lantern alignment screws (L). Slide lantern cap (I) over lantern alignment screws (L).
12. Align holes in alignment cap (G) with lantern alignment screws (L). Make sure alignment cap (G) is positioned as shown in figure A. Slide alignment cap (G) over lantern alignment screws (L).
13. Thread lantern nuts (H) onto exposed threads of lantern alignment screws (L).
14. Install one (1) Type B, 60 watt maximum bulb in to socket.
15. Align assembled lantern (M) with tabs (O) on bottom of lantern canopy (F). Slide lantern over tabs (O) on bottom of lantern canopy (F). NOTE: tabs will fit into opening of alignment cap (G). Twist lantern as shown in figure B to lock tabs (O) into place, securing lantern (M) to lantern canopy (F). Completed lantern assembly shown in figure C.

CARE INSTRUCTIONS:

To clean, use a soft cloth only. DO NOT use any chemical or abrasive cleaners.