

PLEASE FOLLOW THE ASSEMBLY INSTRUCTIONS CLOSELY. IMPROPER ASSEMBLY CAN RESULT IN PERSONAL OR PROPERTY DAMAGE. IF YOU ARE UNSURE ABOUT YOUR CEILING TYPE OR WHAT MOUNTING METHOD YOU SHOULD USE, CONSULT A QUALIFIED PROFESSIONAL OR YOUR LOCAL HARDWARE STORE.

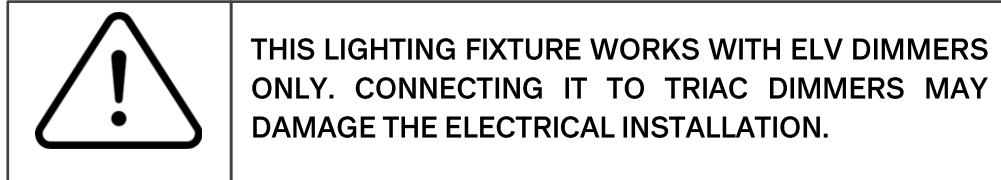

PARTS ENCLOSED:

- (A) Glass Globes [2]
- (B) Lamp support [1]
- (C) Wing screw [1]
- (D) 1.6W LED G4 bulbs [2]

TOOLS ENCLOSED:

Pair of cotton gloves

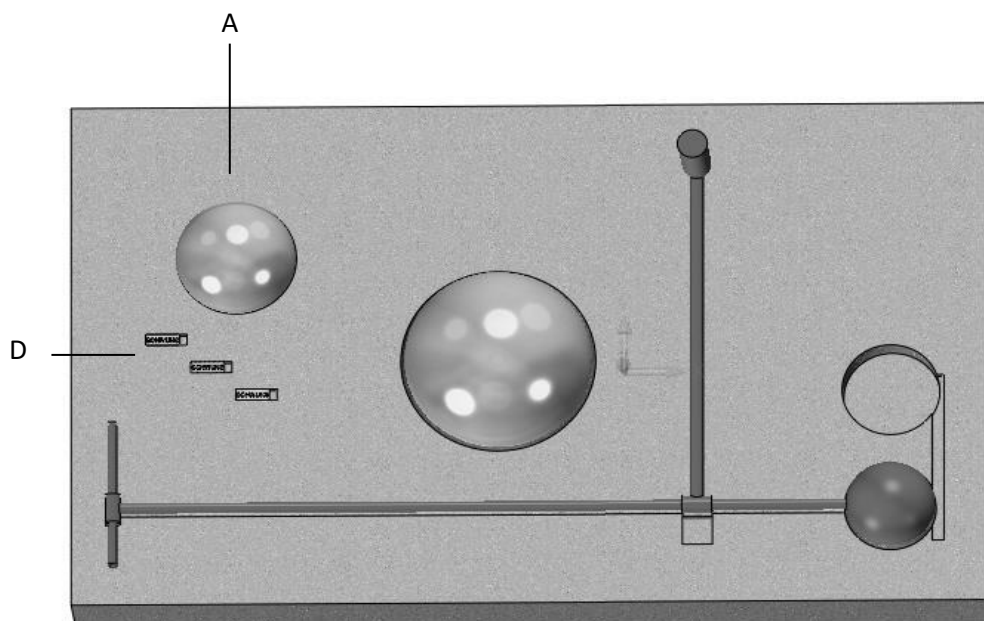
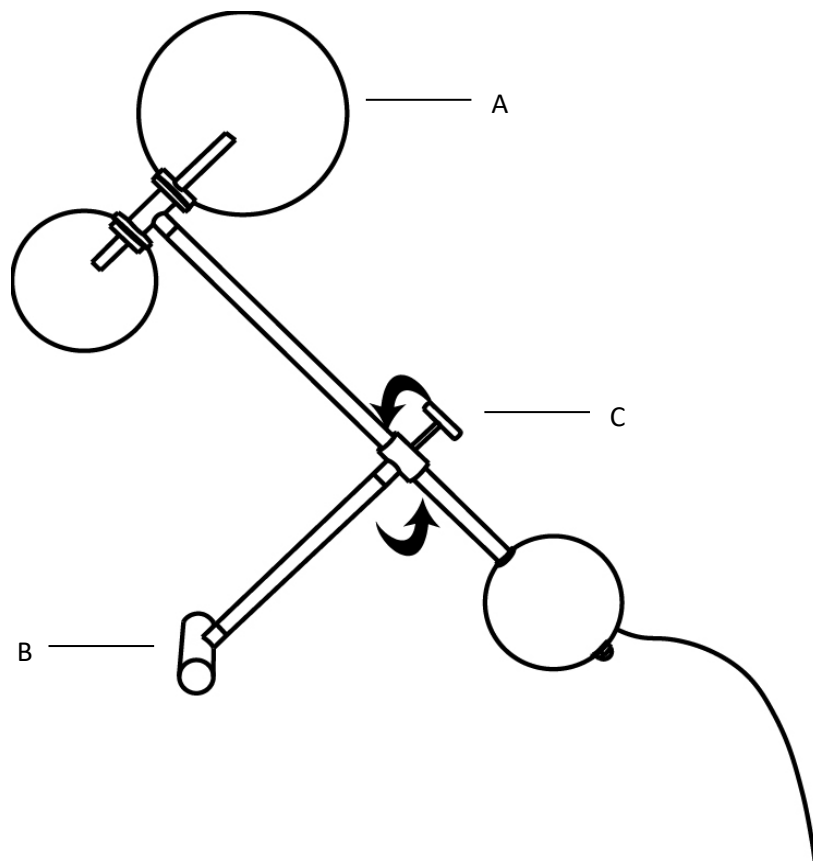



MAKE SURE YOU CUT OFF ELECTRICAL SUPPLY AT THE MAIN FUSE BOX/CIRCUIT BREAKER BEFORE COMMENCING ANY WORK

1

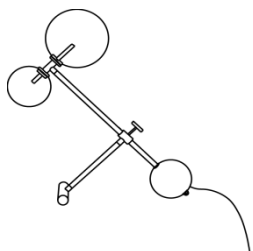

Carefully unpack the lamp and put it in the desired location.

2

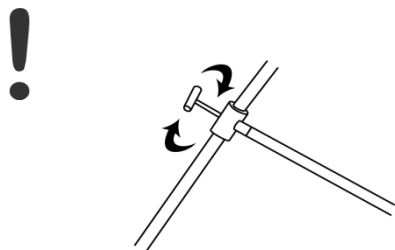

Set the lamp at the desired angle and secure it by delicately screwing the wing screw [C].
NOTE: Do not force the wing screw otherwise you may break the thread.

3

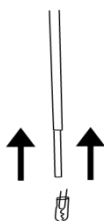

Carefully insert 2 included 1.6W LED G4 bulbs into slots on the tip of each arm.

4

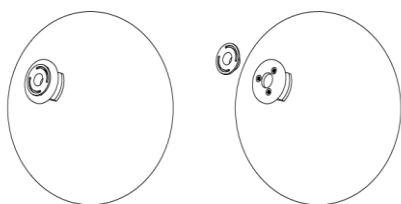

NOTE: Included cotton gloves MUST be worn when handling glass globes. Start mounting glass globes by first removing a plastic stopper from each globe to be mounted.

5

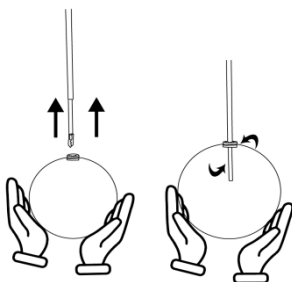

Carefully mount each globe onto the arm tip and screw it on.
The lamp is ready to be connected to power supply.

SAFETY INSTRUCTIONS:

These instructions are provided for your safety. It is very important that they are read completely before beginning the installation of your fixture.

1. This portable luminaire has a polarized plug (one blade is wider than the other) as a feature to reduce the risk of electric shock. This plug will fit on a polarized outlet only one way. If the plug does not fit fully in the outlet, reverse the plug. If it still does not fit, contact a qualified electrician. Never use with an extension cord unless plug can be fully inserted. Do not alter the plug.
2. This fixture has been rated for up to two (2) 1.6W max, 12V G4 base, LED bulbs. To avoid the risk of fire, do not exceed the recommended wattage.
3. If any special control devices are used with this fixture, follow the instructions carefully to assure full compliance with the N.E.C requirements.
4. This fixture can be used together with a trailing edge dimmer (ELV dimmer).
5. If there are any questions, contact a licensed electrical contractor.

WARNINGS:

- Do not mount or unmount the glass globes if the light bulbs or fixture is hot.
- All wires are connected. Do not remove the lamp from its packaging by pulling on the power cord, as a bad connection may result.
- Do not use if the light cable / cord is damaged.
- To reduce the risk of fire, electrical shock, or personal injury, always turn off light fixture and allow it, and the clothes, to cool prior to replacing a light bulb.
- When mounting the fixture, always use included white gloves.
- Do not touch bulbs when fixture is turned on. Do not look directly at lit bulb.
- Keep flammable materials away from lit bulb.

CLEANING AND MAINTENANCE

NOTE: Make sure you cut off electrical supply to the lamp before commencing cleaning operations.

| Component | Maintenance | Tools |
|--------------|---|---------------------------------|
| Brass frame | Clean every month using a soft cloth, dampened slightly with water. Make sure the frame is dry before switching it back on. | Soft cloth, water |
| Glass globes | Clean regularly with a soft dry cloth. Clean only the outside of the globe. When more dirty, use a wet cloth first. Grease can be cleaned with a gentle glass cleaner. | Soft cloth Cotton gloves (!) |
| Led bulbs | Make sure your power supply is off before changing the bulb. Unscrew the globe where bulb needs replacing. Gently remove the bulb by pulling it out and replace with a LED bulb of the same parameters. | Cotton gloves (!) LED bulbs |

NOTE: Please remember solid brass may tarnish over time. This is a natural process. Make sure you follow our guidelines to preserve a great look of RH lighting for years.

TROUBLE SHOOTING

NOTE: Dear client, please be assured our team strives to deliver highest quality products. The handmade nature of the products offers a unique aesthetic experience and allows for small imperfections, which is inherent in crafts. If solutions offered below are not sufficient, please do not hesitate and contact our customer service.

| Problem | Possible cause | Action |
|--------------------|--|---|
| Tarnishing | Oxidation of brass is a natural process. Although it is lacquered, its color may change slightly over time. | No action is necessary apart from regular cleaning. See the Maintenance section. |
| Noise | The humming noise normally comes from transformers. | Check electrical connections and make sure the right dimmer is used - ELV. |
| Globe deformations | Mouth-formed glass globes are beautiful but not perfect. The process leaves a slight deformation at the bottom of the globe. | No action is necessary. All globes undergo a quality check. Should you have any doubts, please send us a photo of the deformed globe and we will act accordingly. |