

OPERATING INSTRUCTIONS

OCEAN MASTER MAX DUAL CANTILEVER AND PLANTATION MAX DUAL CANTILEVER

- ① Remove all packaging from inside and outside of the parasol.
- ② Pull pin to unlock cam lock handle. Make sure cam lock handle is open as shown in the diagram.
- ③ Insert cover onto mast.
Place mast in the security stem.
- ④ Push cam lock handle (per drawing shown) until engaged in the proper gear slot with the cam lock handle in the downward position.

** To rotate parasol: Pull two pins to unlock two cam lock handles, pull up and turn parasol to desired location. Lock two cam lock handles down.*

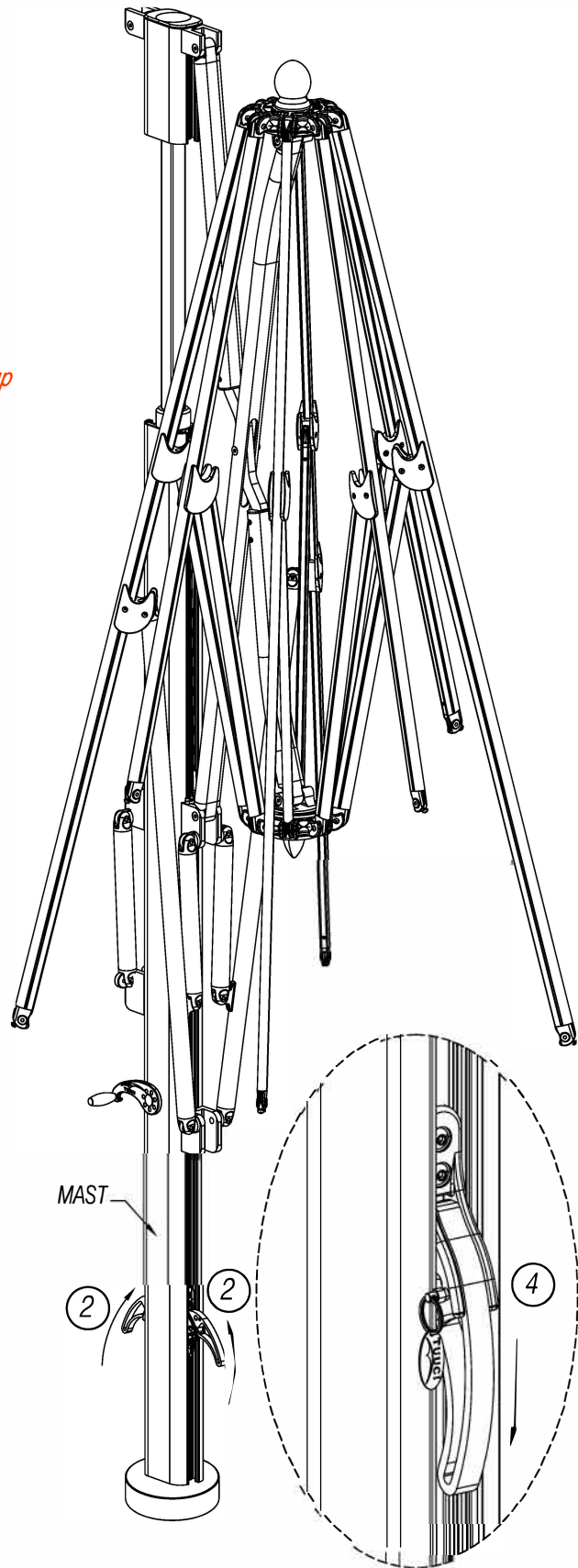
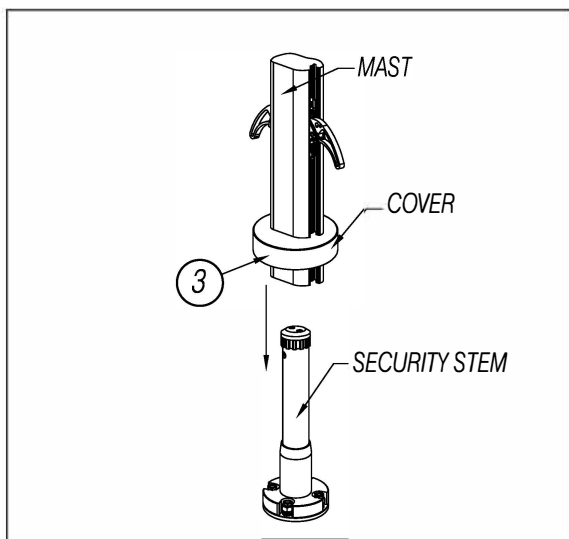
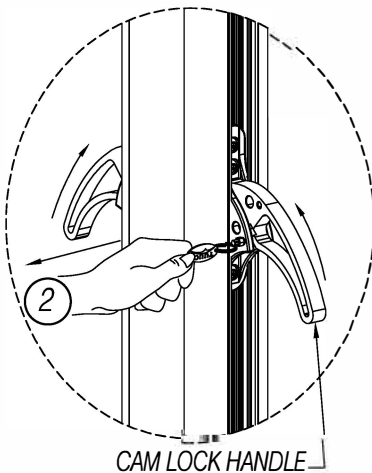

OPERATING INSTRUCTIONS

OCEAN MASTER MAX DUAL CANTILEVER AND PLANTATION MAX DUAL CANTILEVER

- ⑤ Remove #10-32 Screws and #10-32 Bushing Screws with two Phillips screwdrivers at Lower Car as shown in the diagram.
- ⑥ Using two Hex keys (5.5mm) unscrew two 3/8" Screws and 3/8" Bushing Screw at the Top Pole Connector and Upper Car.

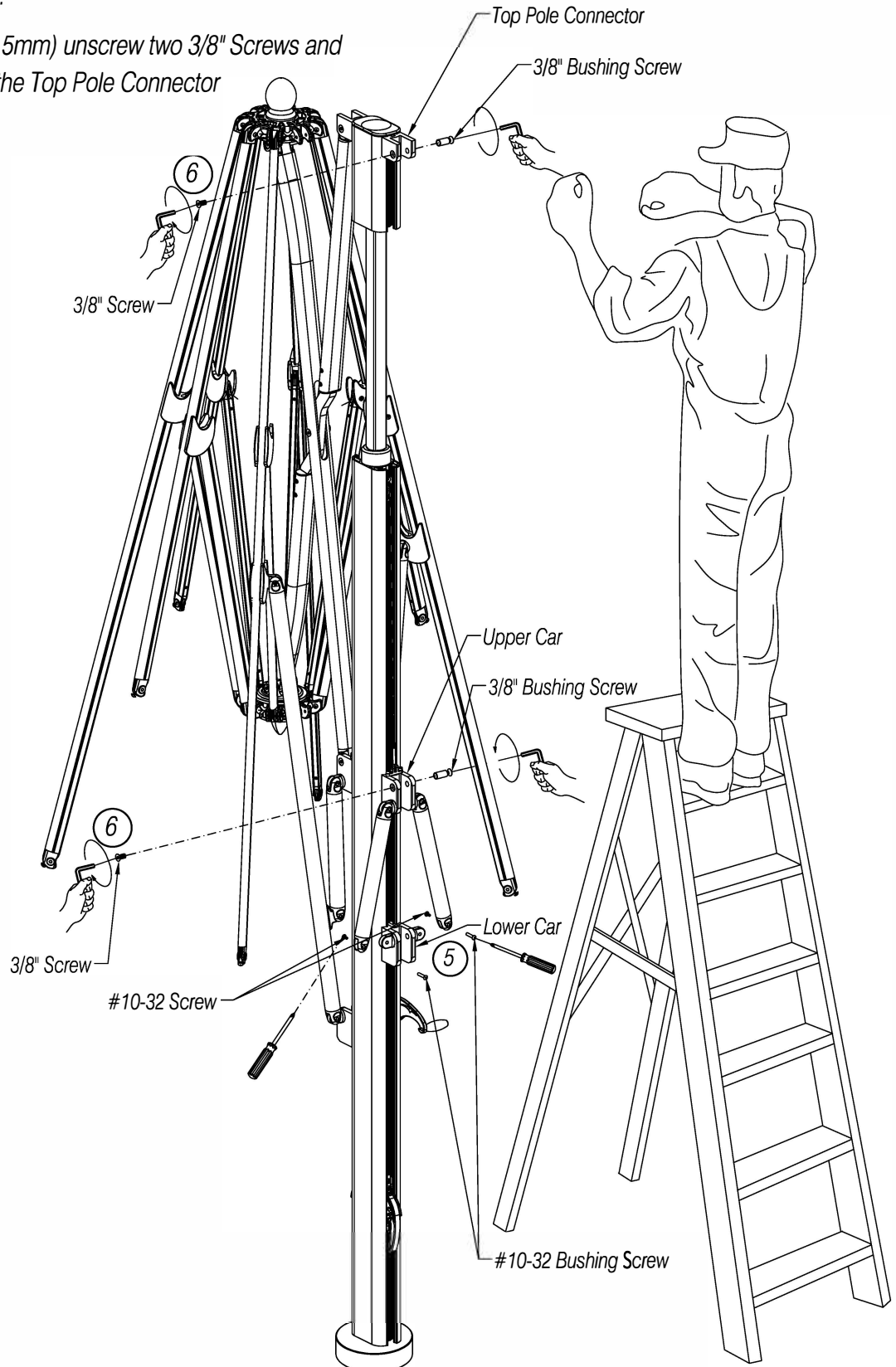

OPERATING INSTRUCTIONS

OCEAN MASTER MAX DUAL CANTILEVER
AND PLANTATION MAX DUAL CANTILEVER

- ⑦ Install Canopy frame by using two Hex keys (5.5mm) and screw two 3/8" Screws and 3/8" Bushing Screws at the Top Pole Connector and Upper Car.

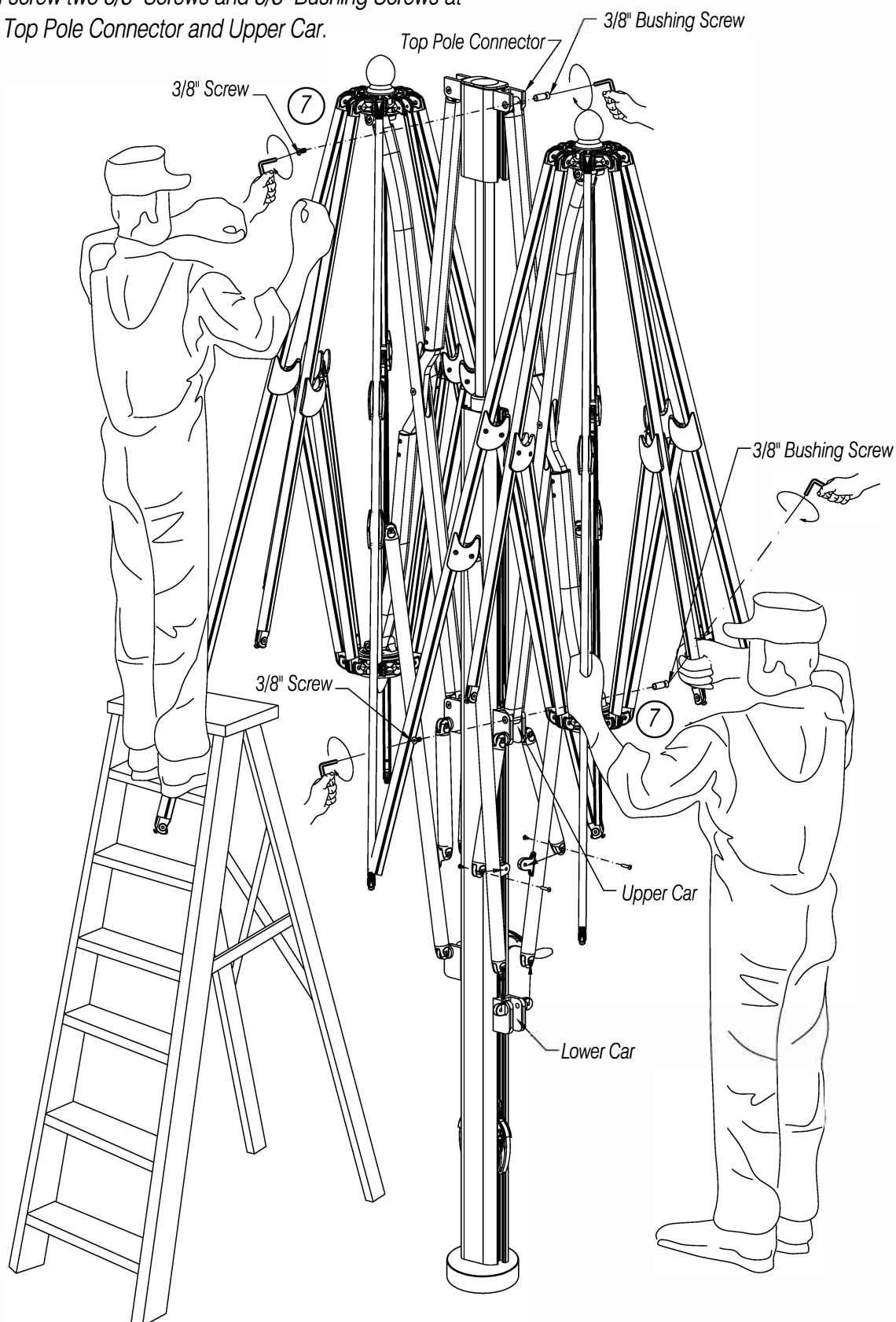

OPERATING INSTRUCTIONS

OCEAN MASTER MAX DUAL CANTILEVER AND PLANTATION MAX DUAL CANTILEVER

- ⑧ If included, install HIGH WIND STRUTS as shown in the diagram.
Then securely tighten #10-32 Screws and #10-32 Bushing
Screws with two Phillips screwdrivers.

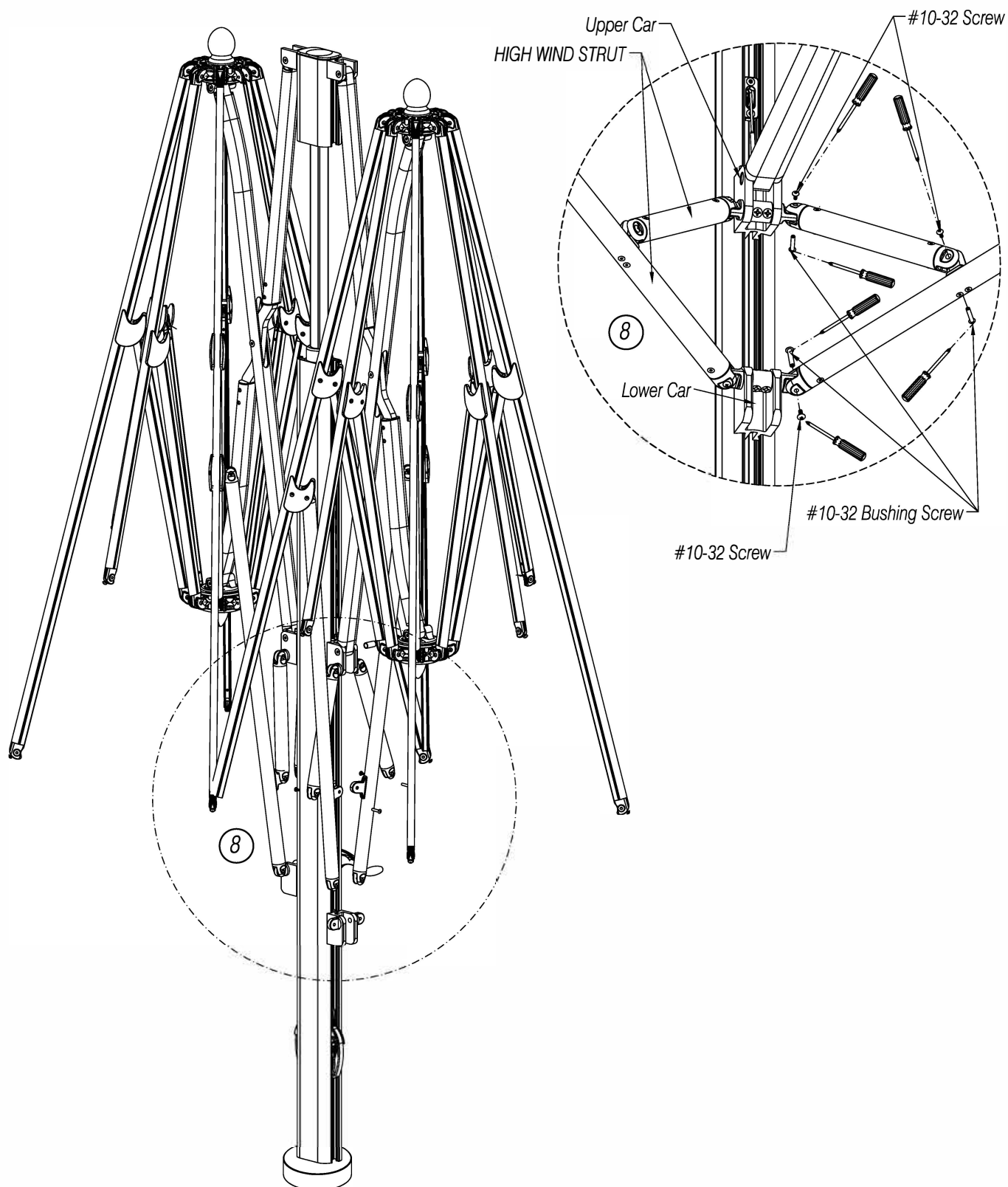

OPERATING INSTRUCTIONS

OCEAN MASTER MAX DUAL CANTILEVER
AND PLANTATION MAX DUAL CANTILEVER

- ⑨ Insert crank handle and open telescope by turning crank handle counterclockwise until it stops. The canopy and parasol will remain closed. Keep tension on the cable as you crank in a counterclockwise position.

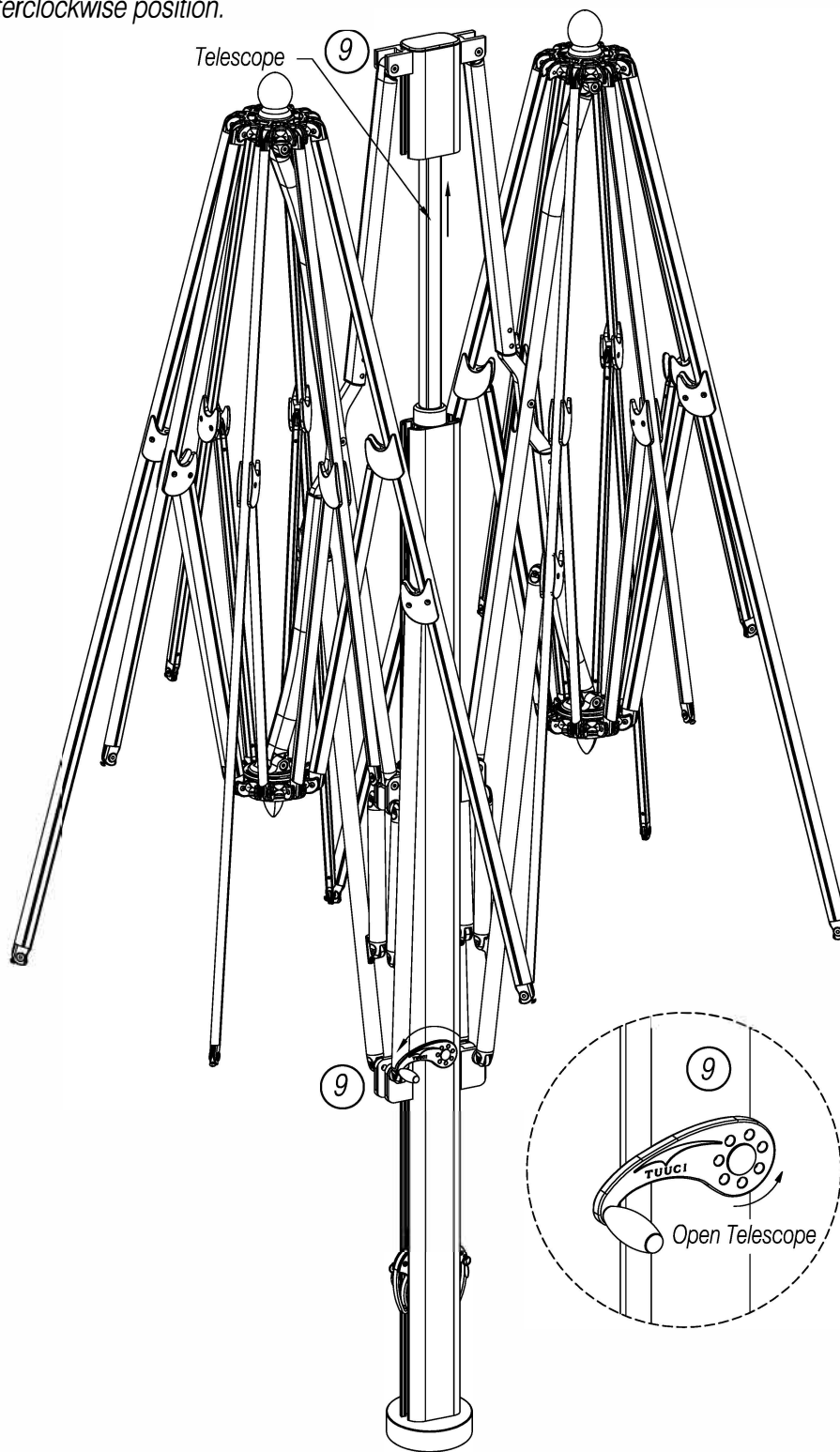

OPERATING INSTRUCTIONS

OCEAN MASTER MAX DUAL CANTILEVER AND PLANTATION MAX DUAL CANTILEVER

Engage the telescoping feature:

- ⑩ Take out the securing pin from each side. Pull cable connector to two trolley car brackets, then insert two securing pins.
- ⑪ Gently separate EACH RIB INDIVIDUALLY from center hub, approx. 4-6"/10-15cm.
If rib does not move easily, DO NOT force.
Inspect product for additional packaging.
- ⑫ Use crank handle to open parasol. Continue turning crank handle clockwise until top pole is touching lower pole. The parasol is fully deployed when the telescoping feature is hidden within the mast.
- ⑬ Turn crank handle counterclockwise to close umbrella when not in use.
- ⑭ Close umbrella during wind conditions that exceed manufacturer's specifications

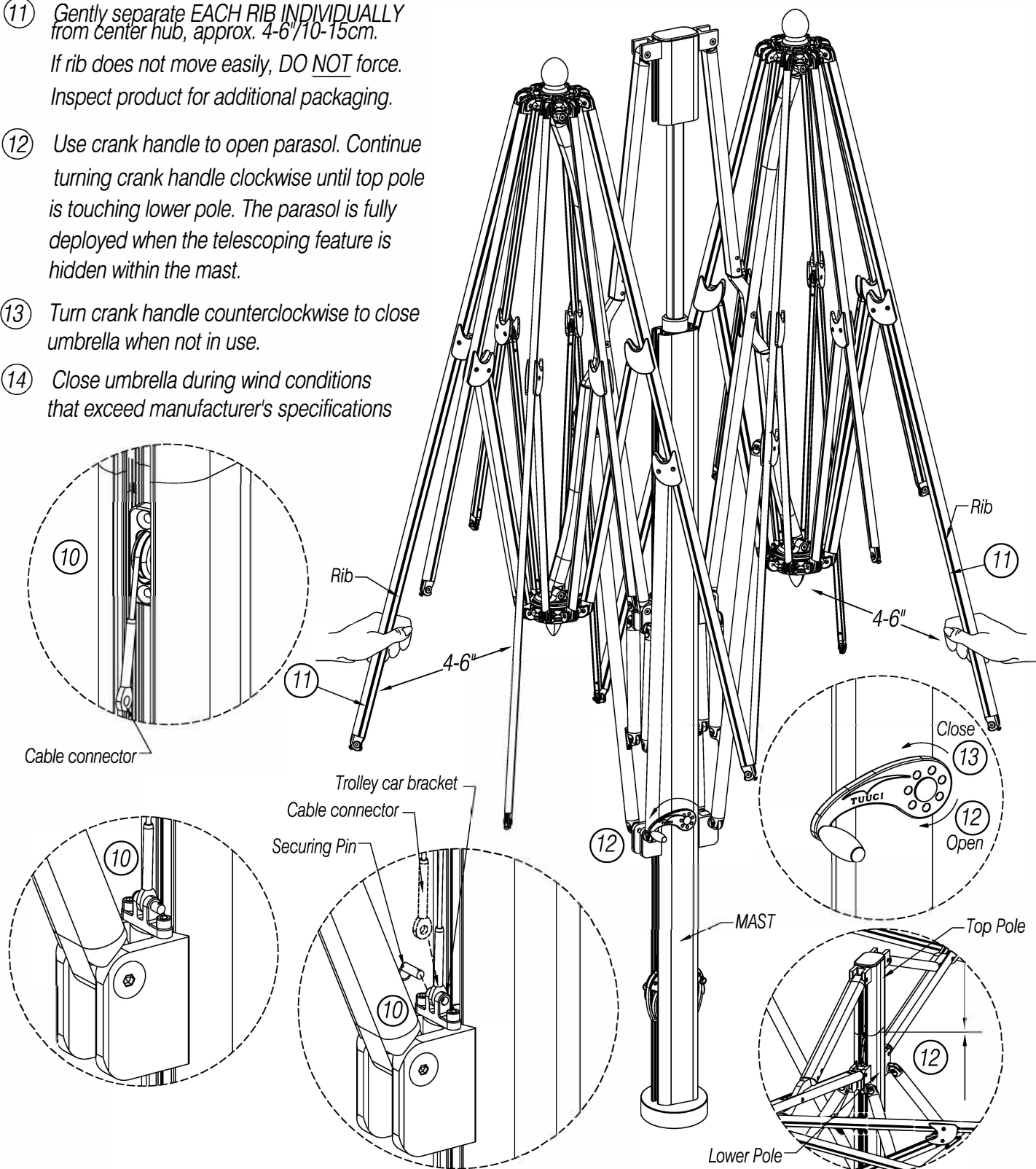

TUUCI frames are constructed from durable, marine-grade, weather-resistant materials including: fiberglass, armor-wall aluminum, Dura-TEAK composites, Aluma-TEAK aluminum and sustainable hardwood. All fasteners (nuts, bolts, pulleys, cam cleats, etc.) are marine-grade stainless steel and will withstand the most corrosive environments. Proper care and maintenance is important to extend the serviceable life of all TUUCI products. We recommend the following:

- Fresh water rinses once a week
- Weekly inspection of your TUUCI product is recommended. Loose screws should be tightened and any broken components replaced immediately to avoid further damage to your product.
- Prior to opening, ensure that the shade product is properly secured to an adequate shade anchor system.
- When opening a TUUCI parasol, separate each rib 10 inches from the center post, before raising the hub. Do not force hub if it does not rise easily.
- When closing the parasol, pull the fabric out from between the struts to avoid pinching or damaging the TUFF-SKIN canopy membrane.
- TUUCI recommends that all collapsible shade equipment be closed in wind conditions that exceed 25 MPH.
- Clean above-ground parasol bases regularly to maintain appearance. To clean, gently wash with soap and water using a nonabrasive cloth or pad.
- Check bolts in security stem regularly to ensure that they remain fully tightened.
- Do not roll Aluma-crete (Aluminum Shell, Concrete Filled) bases on their side as damage to shell or finish can occur.
- Do not use on stairways or over distances that exceed 50 feet, as damage to welded wheel tray may occur.
- Canopy should be cleaned regularly and can be cleaned without being removed from the frame. Hose down and clean with a mild soap and lukewarm water (no more than 100° F) using a soft bristle brush. Rinse thoroughly to remove soap. Allow fabric to air dry.
- Do not use a pressure washer to clean canopies.