

OPERATING INSTRUCTIONS

BAY MASTER CANTILEVER

- ① Remove all packaging from inside and outside of the umbrella.
- ② Pull pin to unlock cam lock handle. Make sure cam lock handle is open per drawing shown.
- ③ Insert cover onto mast.
Place umbrella on security stem.
- ④ Push cam lock handle (per drawing shown) until engaged in the proper gear slot with the cam lock handle in the downward position.

** To rotate umbrella: Pull pin to unlock cam lock handle, pull up and turn umbrella to desired location. Lock cam lock handle down.*

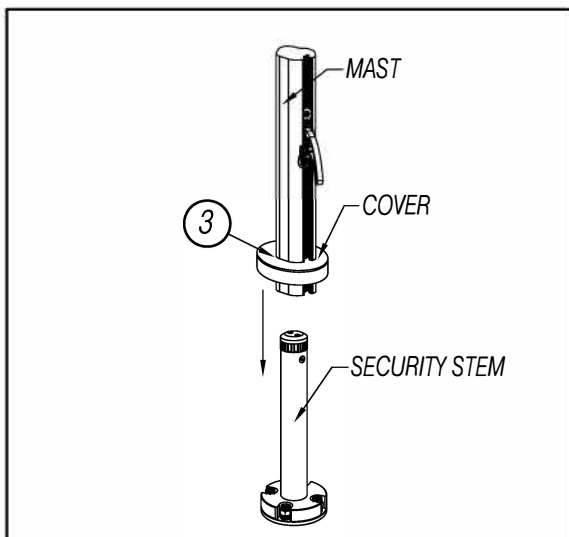
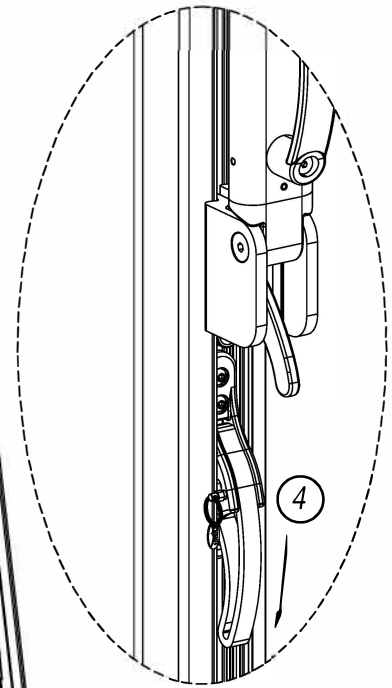
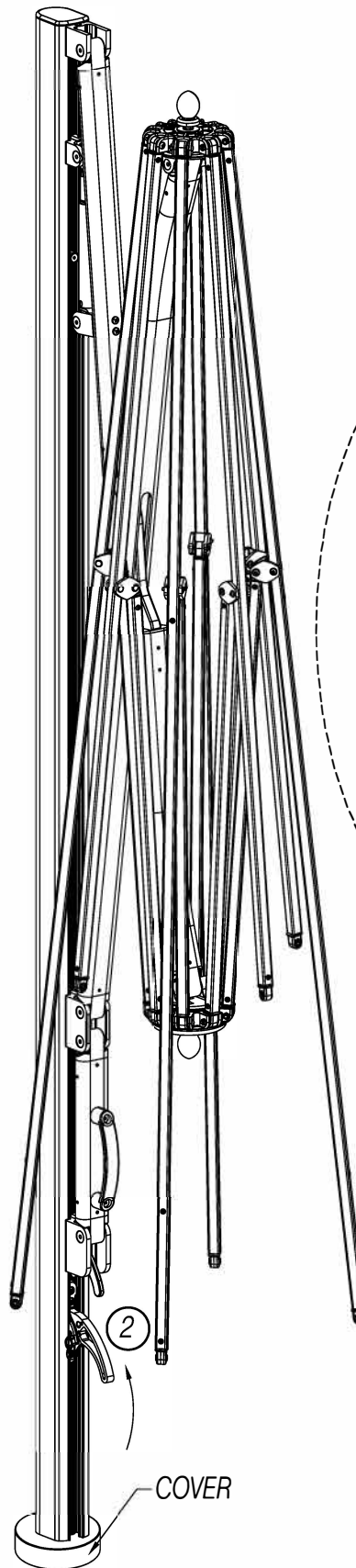
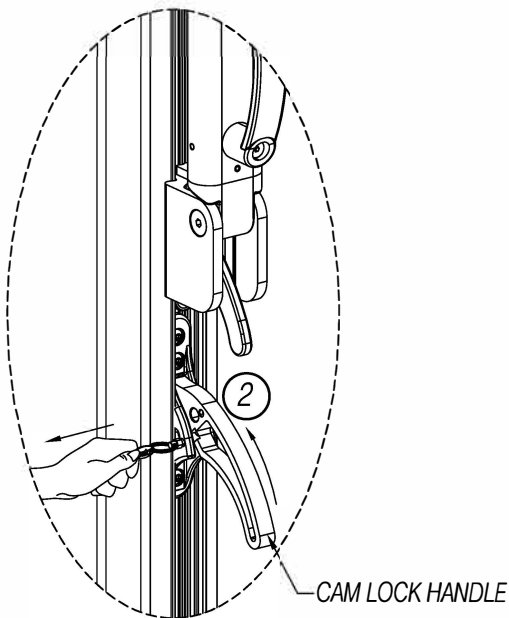

For all customer service, warranty, parts and order status inquiries contact the RH Customer Delight Center:
Email: clientservices@restorationhardware.com
Phone: 800-762-1005

TUUCI
made in miami

INSA5006

OPERATING INSTRUCTIONS

BAY MASTER CANTILEVER

- ⑤ Gently separate EACH RIB INDIVIDUALLY from center hub, approx. 24-36"/60-90cm. If rib does not move easily, DO NOT force. Inspect product for additional packaging.
- ⑥ Push up cart handle to stopper until the cart is locked as shown in the diagram

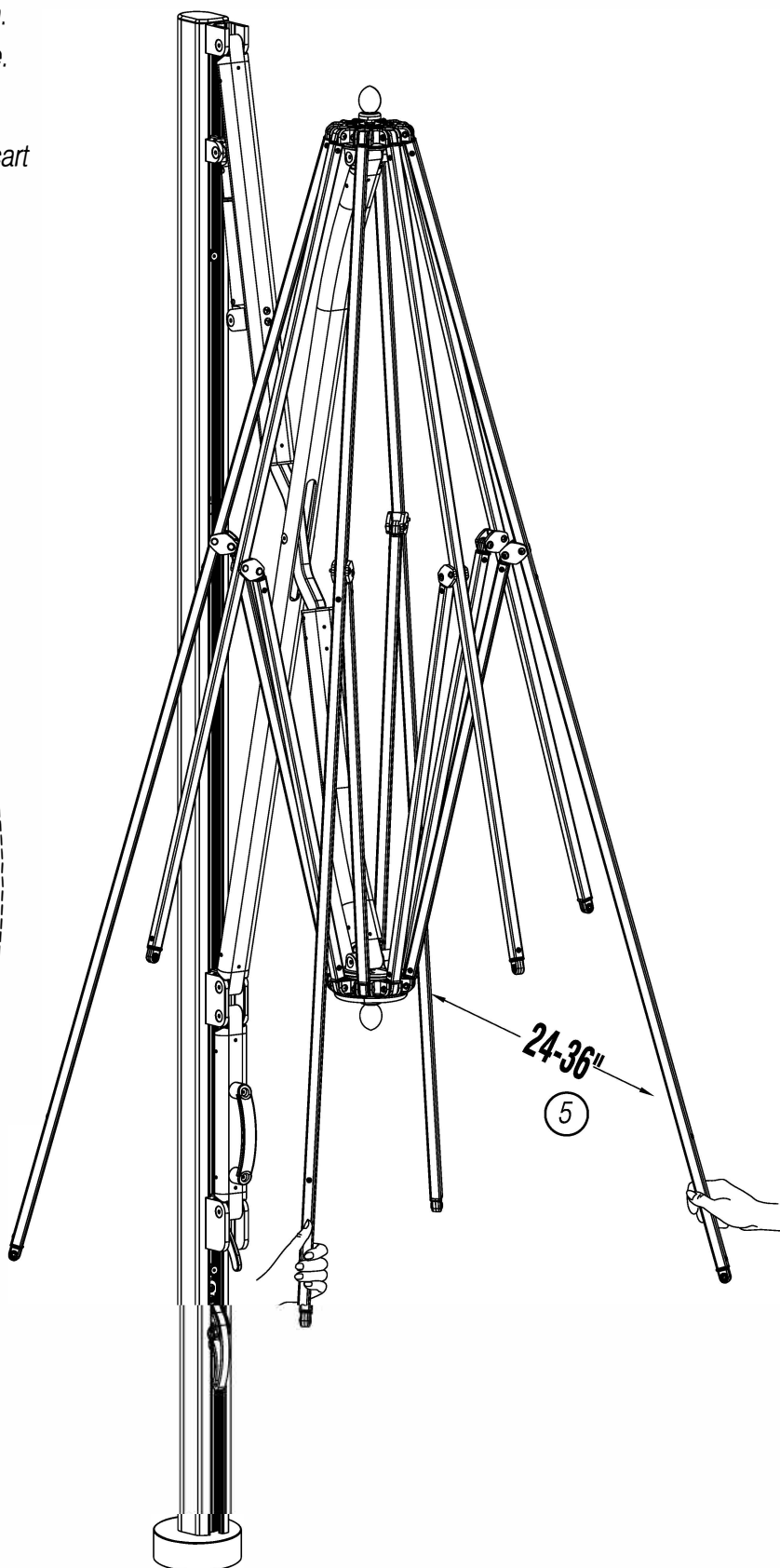
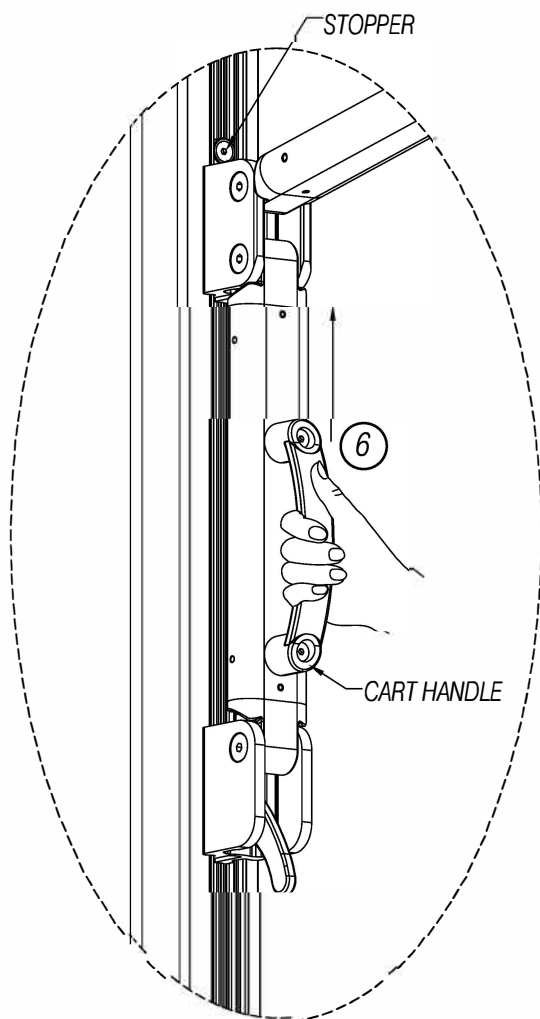

OPERATING INSTRUCTIONS

BAY MASTER CANTILEVER

- ⑦ Hold cart handle by hand, then push down cart lock and slide cart handle down to close umbrella.
Close umbrella during wind conditions that exceed manufacturer's specifications.
- ⑧ Close umbrella with tie back when not in use.

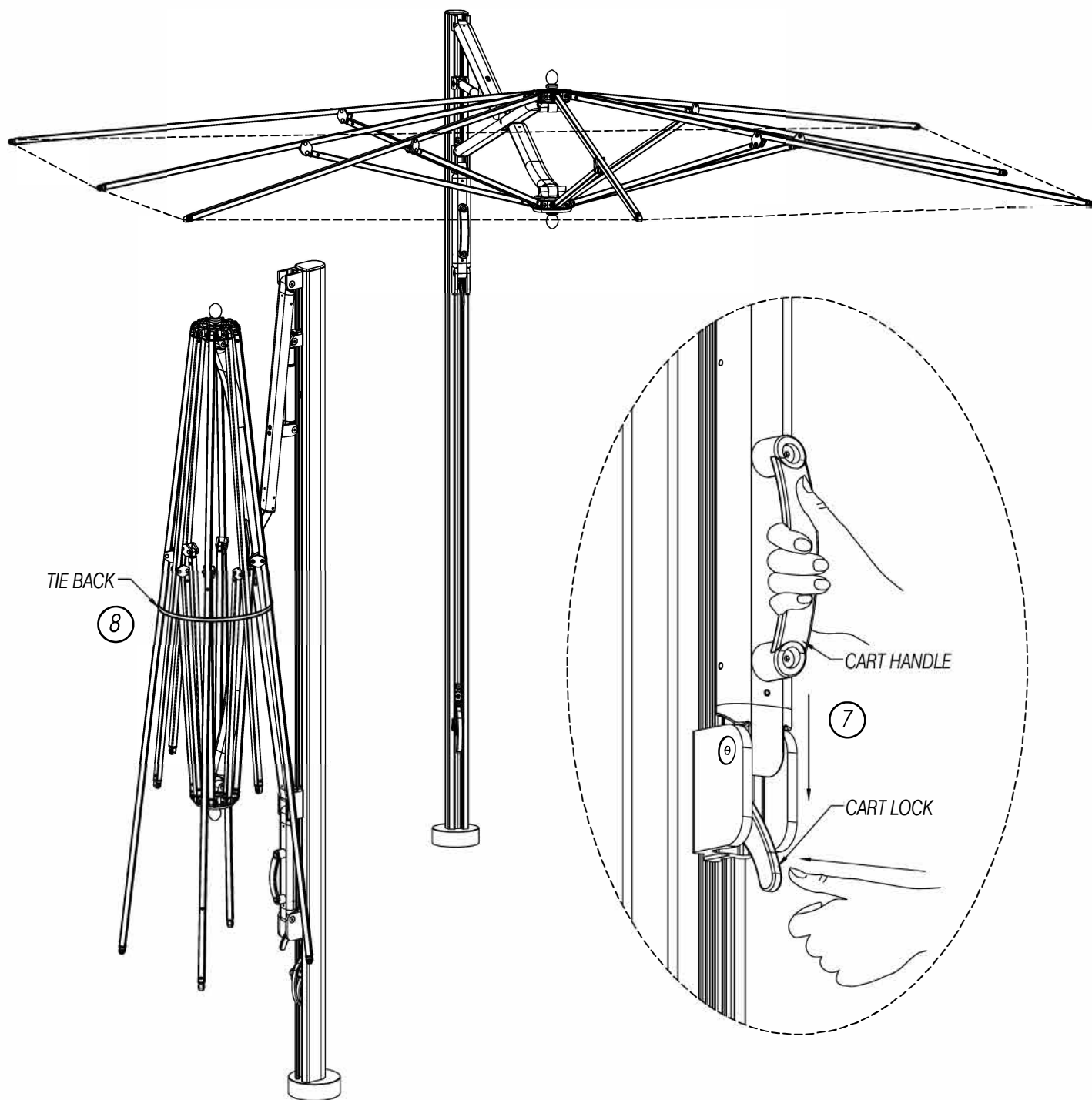

TUUCI frames are constructed from durable, marine-grade, weather-resistant materials including: fiberglass, armor-wall aluminum, Dura-TEAK composites, Aluma-TEAK aluminum and sustainable hardwood. All fasteners (nuts, bolts, pulleys, cam cleats, etc.) are marine-grade stainless steel and will withstand the most corrosive environments. Proper care and maintenance is important to extend the serviceable life of all TUUCI products. We recommend the following:

- Fresh water rinses once a week
- Weekly inspection of your TUUCI product is recommended. Loose screws should be tightened and any broken components replaced immediately to avoid further damage to your product.
- Prior to opening, ensure that the shade product is properly secured to an adequate shade anchor system.
- When opening a TUUCI parasol, separate each rib 10 inches from the center post, before raising the hub. Do not force hub if it does not rise easily.
- When closing the parasol, pull the fabric out from between the struts to avoid pinching or damaging the TUFF-SKIN canopy membrane.
- TUUCI recommends that all collapsible shade equipment be closed in wind conditions that exceed 25 MPH.
- Clean above-ground parasol bases regularly to maintain appearance. To clean, gently wash with soap and water using a nonabrasive cloth or pad.
- Check bolts in security stem regularly to ensure that they remain fully tightened.
- Do not roll Aluma-crete (Aluminum Shell, Concrete Filled) bases on their side as damage to shell or finish can occur.
- Do not use on stairways or over distances that exceed 50 feet, as damage to welded wheel tray may occur.
- Canopy should be cleaned regularly and can be cleaned without being removed from the frame. Hose down and clean with a mild soap and lukewarm water (no more than 100° F) using a soft bristle brush. Rinse thoroughly to remove soap. Allow fabric to air dry.
- Do not use a pressure washer to clean canopies.